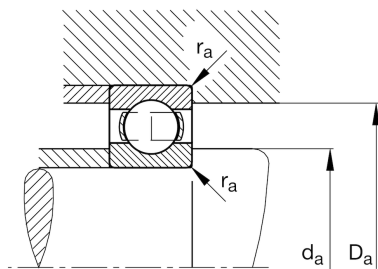
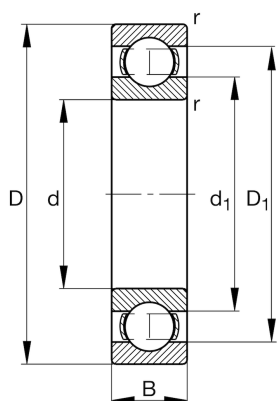

**FAG****6200**

Deep groove ball bearing

Schaeffler ID:
0167192470000Deep groove ball bearing 62, single row,
steel sheet metal cage

Technical information

**Main Dimensions & Performance Data**

d	10 mm	Bore diameter
D	30 mm	Outside diameter
B	9 mm	Width
C_r	6,300 N	Basic dynamic load rating, radial
C_{0r}	2,600 N	Basic static load rating, radial
C_{ur}	177 N	Fatigue load limit, radial
n_G	37,000 1/min	Limiting speed
n_{gr}	23,400 1/min	Reference speed
$\approx m$	32 g	Weight

Mounting dimensions

$d_{a \min}$	14.2 mm	Minimum diameter shaft shoulder
$D_{a \max}$	25.8 mm	Maximum diameter of housing shoulder
$r_{a \max}$	0.6 mm	Maximum fillet radius

Dimensions

r_{\min}	0.6 mm	Minimum chamfer dimension
D_1	23.99 mm	Shoulder diameter outer ring
D_2	25.07 mm	Caliber diameter outer ring
d_1	16.65 mm	Shoulder diameter inner ring

Temperature range

T_{\min}	-30 °C	Operating temperature min.
T_{\max}	120 °C	Operating temperature max.

Calculation factors

f_0	12	Calculation factor
-------	----	--------------------