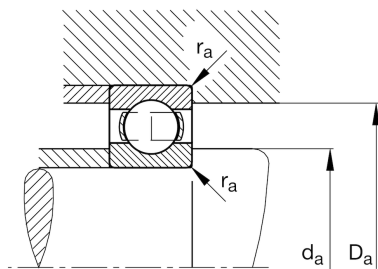
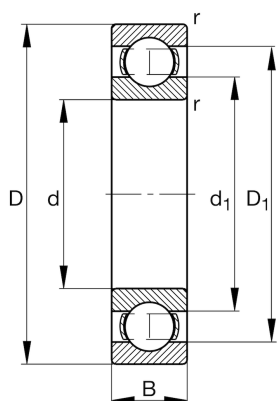

**FAG****6006**

Deep groove ball bearing

Schaeffler ID:
0167173410000Deep groove ball bearing 60, single row,
steel sheet metal cage

Technical information

**Main Dimensions & Performance Data**

d	30 mm	Bore diameter
D	55 mm	Outside diameter
B	13 mm	Width
C_r	13,500 N	Basic dynamic load rating, radial
C_{0r}	8,000 N	Basic static load rating, radial
C_{ur}	405 N	Fatigue load limit, radial
n_G	18,500 1/min	Limiting speed
n_{gr}	13,100 1/min	Reference speed
$\approx m$	0.11 kg	Weight

Mounting dimensions

$d_{a \min}$	34.6 mm	Minimum diameter shaft shoulder
$D_{a \max}$	50.4 mm	Maximum diameter of housing shoulder
$r_{a \max}$	1 mm	Maximum fillet radius

Dimensions

r_{\min}	1 mm	Minimum chamfer dimension
D_1	47.18 mm	Shoulder diameter outer ring
D_2	49.21 mm	Caliber diameter outer ring
d_1	38.25 mm	Shoulder diameter inner ring

Temperature range

T_{\min}	-30 °C	Operating temperature min.
T_{\max}	120 °C	Operating temperature max.

Calculation factors

f_0	14.8	Calculation factor
-------	------	--------------------