



Brand of NTN corporation

Technical data

FC.10893

Passenger Cars Gearbox Bearings

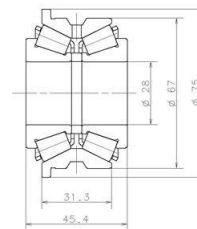

CHARACTERISTICS

Gearbox code	NG0, NG1, NG2, NG3, NG5, NG7, NG9, UN1, UN5
External diameter 1	67 mm
External diameter 2	75 mm
Internal diameter n°1	28 mm
Width 1	45 mm
Weight	0,766 kg

OE EQUIVALENTS

Manufacturer	Part number
RENAULT	7703090245

AUTOMOTIVE COMPATIBILITY

Brand	Model	Generation	Date	Location	Position
RENAULT	Espace	Espace I	09/1984 => 01/1991	secondary shaft 1	Opposite engine side
RENAULT	Espace	Espace II	01/1991 => 08/1996	secondary shaft 1	Opposite engine side
RENAULT	Fuego	Fuego	09/1979 => 12/1985	secondary shaft 1	Opposite engine side
RENAULT	Master	Master	08/1980 => 02/1989	secondary shaft 1	Opposite engine side
RENAULT	R18	R18	04/1978 => 12/1986	secondary shaft 1	Opposite engine side
RENAULT	R20	R20	12/1975 => 12/1984	secondary shaft 1	Opposite engine side
RENAULT	R21	R21 (X48)	03/1986 => 12/1994	secondary shaft 1	Opposite engine side



NTN Europe

1 rue des Usines · BP 2017 · 74010 Annecy Cedex · France · Tel. +33 (0)4 50 65 30 00
 S.A. au capital de 322 639 919 € · RCS ANNECY B 325 821 072 · Id. Fiscale : FR 48 325 821 072
 SIRET 325 821 072 00015 · Code APE 2815 Z · Code NACE 28.15

AUTOMOTIVE COMPATIBILITY						
Brand	Model	Generation	Date	Location	Position	
RENAULT	R21	R21 Nevada (X48)	06/1986 => 08/1995	secondary shaft 1	Opposite engine side	
RENAULT	R21	R21 Savanna (X48)	06/1986 => 08/1995	secondary shaft 1	Opposite engine side	
RENAULT	R25	R25	09/1983 => 10/1993	secondary shaft 1	Opposite engine side	
RENAULT	R30	R30	10/1981 => 12/1984	secondary shaft 1	Opposite engine side	
RENAULT	R5	R5	07/1981 => 06/1985	secondary shaft 1	Opposite engine side	

