



### Electrical specifications

**Center Frequency:** 905 MHz  
**-1dB Bandwidth:** 110 MHz  
**VSWR:** 1.5 : 1  
**Insertion Loss (F0):** 1.5 dB max  
**Ripple:** 1.0 dB max  
**Input / Output Impedance:** 50 Ohms  
**Rejection:** 30dB min at 500MHz  
**Rejection 2:** 20dB min at 1040MHz ~ 2000MHz  
**Power Handling:** 20 dBm

### Mechanical

**Mounting Method:** SMT  
**Dimensions:** 14 x 13 x 4.5 mm

### Environmental

**Operating Temperature:** -40 to +70 deg. C  
**Storage Temperature:** -55 to +85 deg. C

This product is RoHs compliant.

### Outline Drawing:

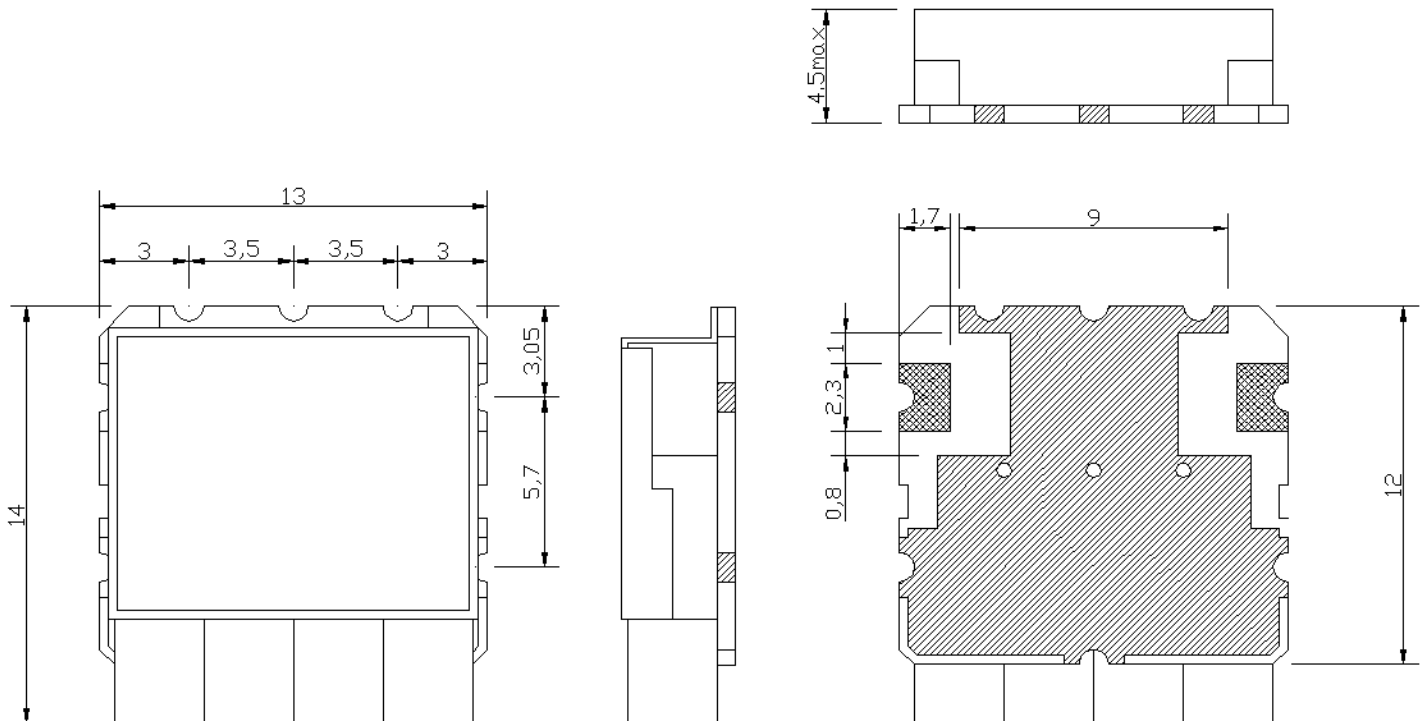

Unit:mm  
Tolerance:±0.3