

MATERIALS AND FINISHES

BODY, BRASS
PLATED NICKEL

CENTER CONTACT, BRASS
PLATED GOLD

CRIMP TUBE BRASS
PLATED NICKEL

SHROUD: PBT OR NYLON 66
KEYING SEE TABLE
COLOR SEE TABLE

INSULATOR, PP

SECONDARY LOCK (TPA): PBT OR NYLON 66

PACKAGING BY BAG

SECONDARY LOCK
(TPA)

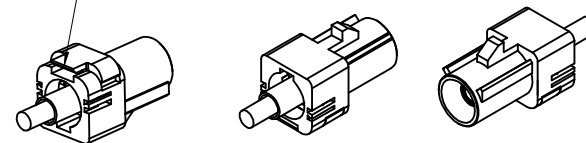

FAKRA
CONNECTOR
KEYING
CODE B SHOWN

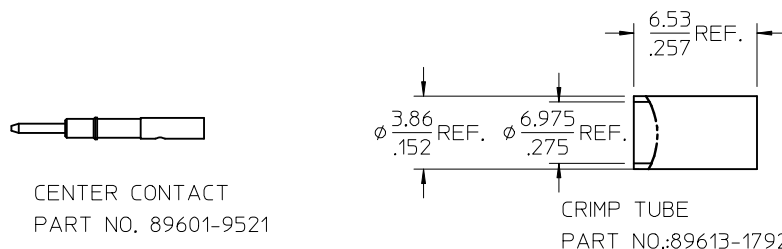
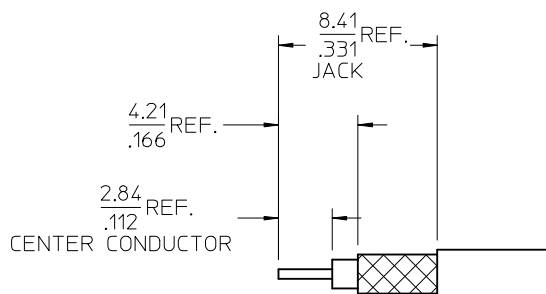
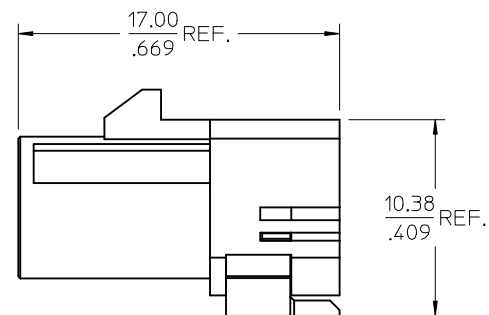
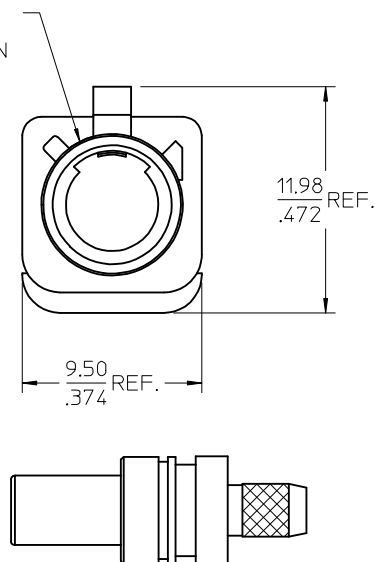

CENTER CONTACT
PART NO. 89601-9521

CRIMP TUBE
PART NO.:89613-1792

AS-73597-046	ASSYMBLY INSTRUCTIONS
PS-89675-331	PRODUCT SPECIFICATION
DIN 73594-1	INTERFACE SPECIFICATION
SPECIFICATION	DESCRIPTION

RTM PDR/3031281 EC NO: URF/2013-0510 DRW:ELIN 2013/03/05 CHKD: APP:MHUANG 2013/07/10	DESCRIPTION A	QUALITY SYMBOLS ▽=0 ▽=0 ▽=0	GENERAL TOLERANCES (UNLESS SPECIFIED)		DIMENSION STYLE MM/IN		SCALE 1:1	DESIGN UNITS METRIC	THIRD ANGLE PROJECTION		
			mm	INCH	DRAWN BY EL IN	DATE 2013/03/05	TITLE FAKRA II JACK STR. FOR RG174/316 CABLE FAKRA-J				
			4 PLACES ± ---	± ---	CHECKED BY KERRIE		DATE 2013/03/05				
			3 PLACES ± ---	± ---	APPROVED BY MHUANG		DATE 2013/07/10				
			2 PLACES ± ---	± ---	MATERIAL NO.		DOCUMENT NO.	SHEET NO.			
			1 PLACE ± ---	± ---	SEE SHEET 2		SD-73403-628	1 OF 3			
			0 PLACE ± ---	± ---	DRAFT WHERE APPLICABLE MUST REMAIN WITHIN DIMENSIONS						
			ANGULAR ± 2 °		THIS DRAWING CONTAINS INFORMATION THAT IS PROPRIETARY TO MOLEX INCORPORATED AND SHOULD NOT BE USED WITHOUT WRITTEN PERMISSION						

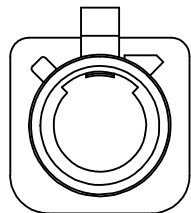

CODE-A

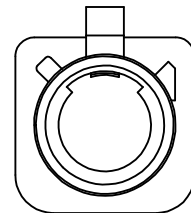

CODE-B

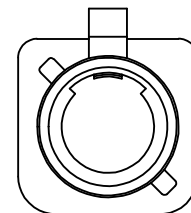

CODE-C

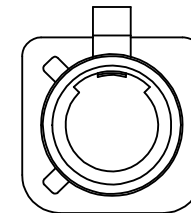

CODE-D

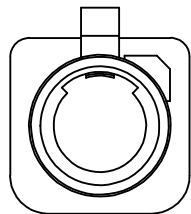

CODE-E

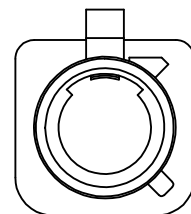

CODE-F

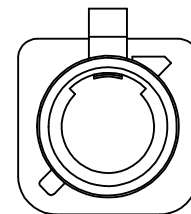

CODE-G

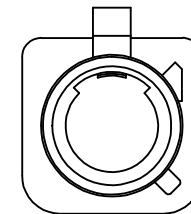

CODE-H

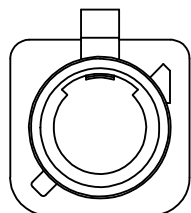

CODE-I

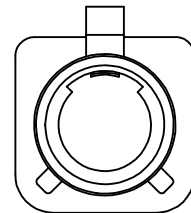

CODE-K

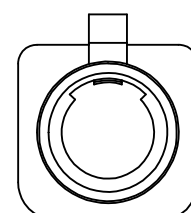

CODE-Z

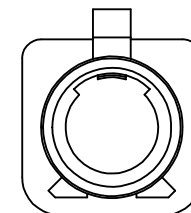

CODE-L

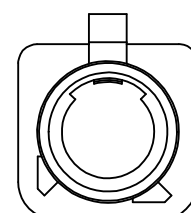

CODE-M

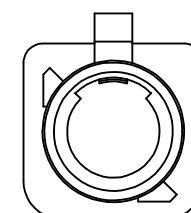

CODE-N

N	PASTEL GREEN	73403-6293
M	PASTEL ORANGE	73403-6292
L	CARMINE RED	73403-6291
Z	WATER BLUE	73403-6290
K	CURRY YELLOW	73403-6289
I	BEIGE	73403-6288
H	VIOLET	73403-6287
G	GRAY	73403-6286
F	BROWN	73403-6285
E	GREEN	73403-6284
D	BORDEAUXVIOLET	73403-6283
C	BLUE	73403-6282
B	NATURAL	73403-6281
A	BLACK	73403-6280
KEYING CODE	COLOR	PART NO.

SEE SHEET 1	2013/03/05
EC NO: URF2013-0510	
DRW:LIN	
CHKD:	
APPR:MHUANG	2013/07/10
REV	DESCRIPTION
A	

QUALITY SYMBOLS	GENERAL TOLERANCES (UNLESS SPECIFIED)
▽=0	mm INCH
▽=0	4 PLACES ± --- ± ---
▽=0	3 PLACES ± --- ± ---
	2 PLACES ± --- ± ---
	1 PLACE ± --- ± ---
	0 PLACE ± --- ± ---
	ANGULAR ± 2 °
	DRAFT WHERE APPLICABLE MUST REMAIN WITHIN DIMENSIONS

DIMENSION STYLE	
MM/IN	
DRAWN BY	DATE
EL IN	2013/03/05
CHECKED BY	DATE
KERRIE	2013/03/05
APPROVED BY	DATE
MHUANG	2013/07/10
MATERIAL NO.	
SEE TABLE	
SIZE	C

SCALE	DESIGN UNITS	THIRD ANGLE PROJECTION
1:1	METRIC	
TITLE		
FAKRA II JACK STR. FOR RG174/316 CABLE FAKRA-J		
molex		
DOCUMENT NO.	SHEET NO.	
SD-73403-628	2 OF 3	
THIS DRAWING CONTAINS INFORMATION THAT IS PROPRIETARY TO MOLEX INCORPORATED AND SHOULD NOT BE USED WITHOUT WRITTEN PERMISSION		



SHROUD WITH TPA x1
 CRIMP TUBE x1
 SMB SUB ASSY x1
 CENTER CONTACT x1



1 SET PER BAG
 BAG P/N: 89707-0317

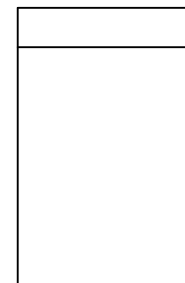

50 SET PER BAG
 BAG P/N: 89707-0174
 6" x 12"

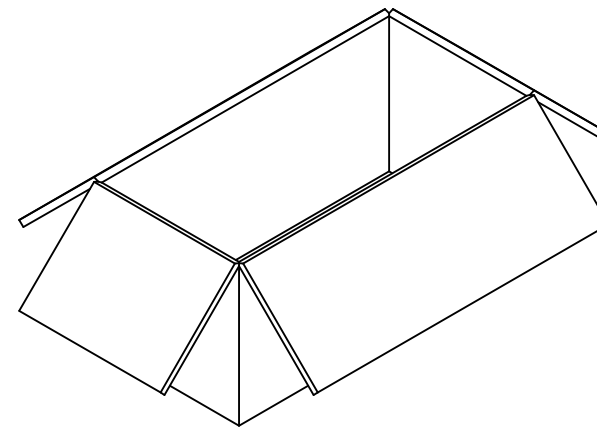

500 SET PER CARTON BOX
 P/N: 96707-0002
 367*176*188mm

SEE SHEET 1 EC NO: URF2013-0510 DRAWN: ELIN 2013/03/05 CHKD: APPR: MHUANG 2013/07/10	QUALITY SYMBOLS	GENERAL TOLERANCES (UNLESS SPECIFIED)		DIMENSION STYLE	SCALE	DESIGN UNITS	THIRD ANGLE PROJECTION
		mm	INCH	MM/IN	1:3.33	METRIC	
		± ---	± ---	DRAWN BY	DATE	TITLE	
		± ---	± ---	EL IN	2013/03/05	FAKRA II JACK STR. FOR RG174/316 CABLE FAKRA-J	
	± ---	± ---	1 PLACE	CHECKED BY	DATE	molex	
	± ---	± ---	0 PLACE	KERRIE	2013/03/05		
REV	DESCRIPTION	ANGULAR ± 2 °		APPROVED BY	DATE	DOCUMENT NO.	SHEET NO.
A		DRAFT WHERE APPLICABLE MUST REMAIN WITHIN DIMENSIONS		MHUANG	2013/07/10	SD-73403-628	3 OF 3
				SEE SHEET 2	THIS DRAWING CONTAINS INFORMATION THAT IS PROPRIETARY TO MOLEX INCORPORATED AND SHOULD NOT BE USED WITHOUT WRITTEN PERMISSION		