

## CTSPI3D12F Series

From 0.68µH to 68µH



### SPECIFICATIONS

Please specify tolerance code when ordering.  
CTSPI3D12F-R68 ← M = ±20%, N = ±30%

Part Number	Inductance (µH)	Tolerance (±%)	DCR Typ. (Ω)	IDC Typ. (mA)	I <sub>rms</sub> Typ. (mA)	Color Coding
CTSPI3D12F-R68_	0.68	20, 30	0.040	2700	3000	Gray
CTSPI3D12F-1R0_	1.0	20, 30	0.045	2300	2000	Black
CTSPI3D12F-1R2_	1.2	20, 30	0.048	2200	1900	Brown
CTSPI3D12F-1R5_	1.5	20, 30	0.055	1900	1800	Red
CTSPI3D12F-1R8_	1.8	20, 30	0.073	1800	1750	Orange
CTSPI3D12F-2R2_	2.2	20, 30	0.083	1700	1750	Yellow
CTSPI3D12F-2R7_	2.7	20, 30	0.109	1400	1440	Green
CTSPI3D12F-3R3_	3.3	20, 30	0.118	1300	1400	Blue
CTSPI3D12F-3R9_	3.9	20, 30	0.143	1260	1300	Violet
CTSPI3D12F-4R7_	4.7	20, 30	0.159	1240	1200	Gray
CTSPI3D12F-5R6_	5.6	20, 30	0.213	1000	1000	White
CTSPI3D12F-6R8_	6.8	20, 30	0.224	1000	960	Black
CTSPI3D12F-8R2_	8.2	20, 30	0.252	920	940	Brown
CTSPI3D12F-100M	10	20	0.327	860	900	Red
CTSPI3D12F-120M	12	20	0.363	800	820	Orange
CTSPI3D12F-150M	15	20	0.516	600	640	Yellow
CTSPI3D12F-180M	18	20	0.625	560	600	Green
CTSPI3D12F-220M	22	20	0.732	460	520	Blue
CTSPI3D12F-330M	33	20	1.165	420	420	Violet
CTSPI3D12F-680M	68	20	2.900	300	350	Gray

### PHYSICAL DIMENSIONS

Size	A	B	C Max.	D	E
mm	4.2±0.2	4.2±0.2	1.25	1.3	1.6
inches	0.165±0.008	0.165±0.008	0.049	0.051	0.063

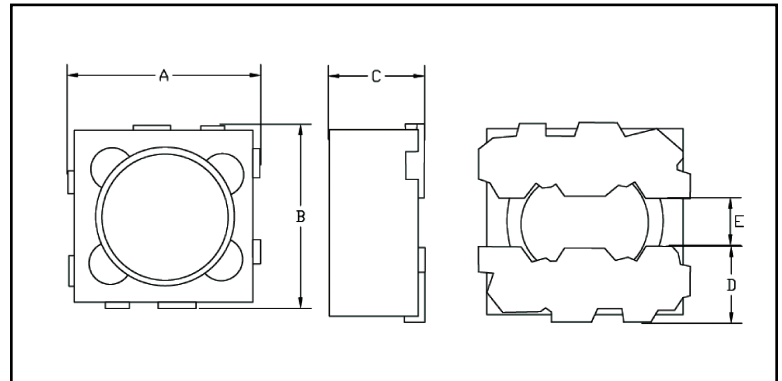

### CHARACTERISTICS

**Description:** SMD Shielded Power Inductors (low profile)

**Applications:** Cellular phones, PDAs, DVC, DSC, digital cameras, and hard disk drives

**Operating Temperature:** -40°C to +105°C

**Testing:** Inductance is tested on an HP4284A at 1KHz/1.0V

**IDC:** For inductance 10% or 35% from its value without current

**I<sub>rms</sub>:** For a 25°C or 40°C rise above 25°C ambient

**Packaging:** Tape & Reel.

**Additional Information:** Additional electrical & physical information available upon request.

**Samples available. See website for ordering information.**

### PAD LAYOUT

