

# SERIES TL 3302 SWITCHES

TACT SWITCHES SMT - RECTANGULAR

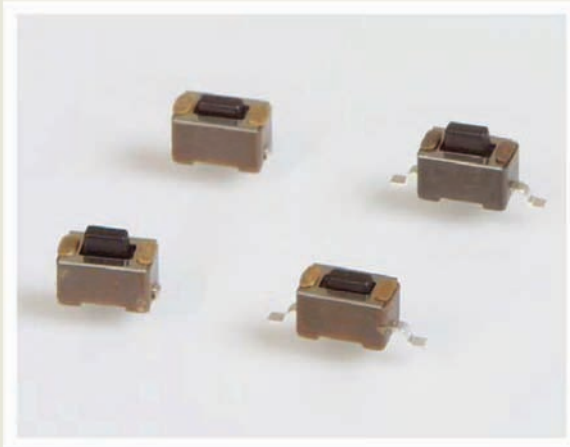

## SPECIFICATIONS

|                        |   |
|------------------------|---|
| Contact Rating:        | 50mA @ 12 VDC   |
| Life Expectancy:       | 20,000 - 50,000 cycles, depending on model                                      |
| Contact Resistance:    | 100mΩ max., typical @ 2-4 VDC<br>100mA for both silver and gold plated contacts |
| Insulation Resistance: | 100MΩ min.  |
| Dielectric Strength:   | 250 VAC   |
| Actuation Force:       | 130 ± 50 gf, 180 ± 50 gf, 260 ± 50 gf   |
| Operating Temperature: | -20°C to 70°C   |
| Travel:                | 0.25 Typ.   |

### FEATURES & BENEFITS

- ▶ 3.5 x 6mm packaged design
- ▶ Reliable dome contact technology
- ▶ Strong tactile/audible feedback

### APPLICATIONS/MARKETS

- ▶ Telecommunications
- ▶ Consumer Electronics
- ▶ Audio/visual
- ▶ Medical
- ▶ Testing/instrumentation
- ▶ Computer/servers/peripherals



## HOW TO ORDER

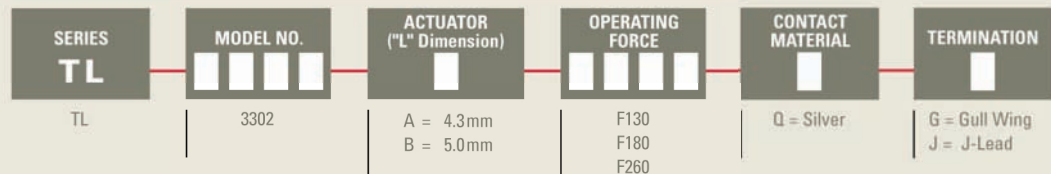

### Example Ordering Number

TL-3302-A-F180-Q-G

Specifications subject to change without notice.

TACT SWITCHES

NAVIGATION SWITCHES

PUSHBUTTON SWITCHES

TOGGLE SWITCHES

ROCKER SWITCHES

SLIDE SWITCHES

SNAP-ACTION SWITCHES

DIP SWITCHES

KEYLOCK SWITCHES

ROTARY SWITCHES

DETECTOR SWITCHES

CAP OPTIONS

# SERIES TL 3302 SWITCHES

## TACT SWITCHES SMT - RECTANGULAR

TACT SWITCHES

### TL 3302

GULL WING TERMINATION

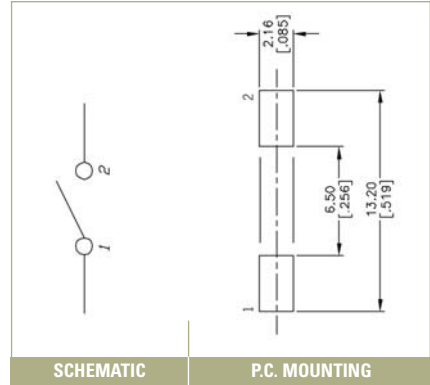
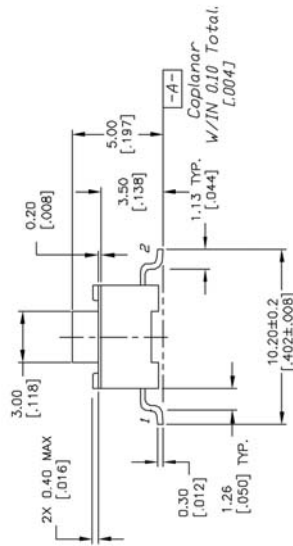
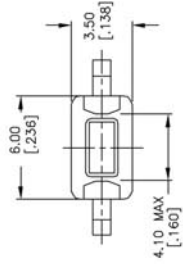

NAVIGATION SWITCHES

PUSHBUTTON SWITCHES

TOGGLE SWITCHES

ROCKER SWITCHES

### TL 3302

J-LEAD TERMINATION

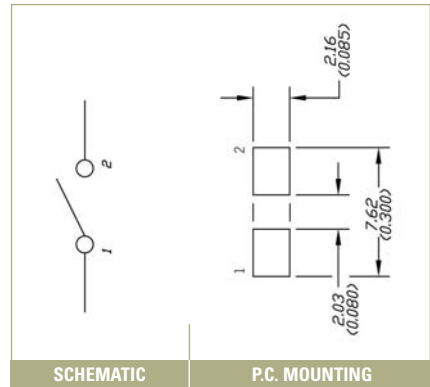
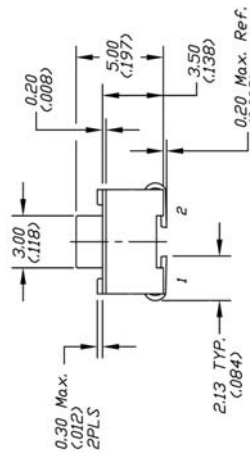
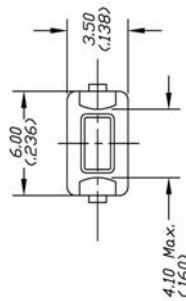

SLIDE SWITCHES

SNAP-ACTION SWITCHES

DIP SWITCHES

KEYLOCK SWITCHES

ROTARY SWITCHES

DETECTOR SWITCHES

CAP OPTIONS

### TL 3302 STANDARD REEL

