

**NOTES:**  
 +.001  
 -.000

① MAT'L : COPPER ( STOCK TKN.  $\frac{028}{71}$  )  
 PLATING: ELECTRO TIN (.0003 MIN.)

STUD SIZES: ( $\pm .005$ )

- 02 = .094
- 04 = .119
- 06 = .146
- 08 = .173
- 10 = .198
- 14 = .265
- 56 = .328
- 38 = .390

"UL" LISTING #E32244  
 "CSA" LISTING #18689

ALL DIMENSIONS = INCHES / MM

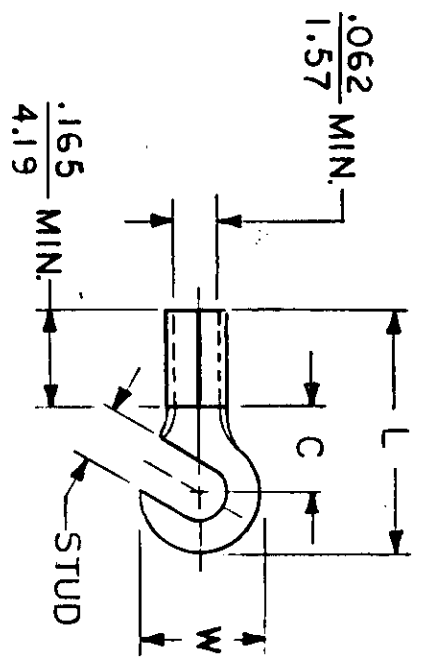

FILE NO. AA-CD-101-03

WIRE SIZE: 22-18 AWG  
 .25-1.5 MM<sup>2</sup>

PART NUMBER	"W"	"C" MIN.	"L" MAX.	AVAILABLE STUD SIZES	TITLE:			
					HOOK TONGUE TERMINAL KRIMPTITE 100-SERIES			
AA-110-	$\frac{.310}{7.87}$	$\frac{.303}{7.70}$	$\frac{.695}{17.65}$	06, 08, 10	SCALE: NTS	DATE	DWG. NO.	CUSTOMER DWG.
					DRWN. BY: HZ	10-17-84	A	
					CHKD. BY: GZ	10-18-84		
					APPRD. BY:			

DIMENSIONAL TOLERANCES UNLESS OTHERWISE SPECIFIED

FRAC.	DEC.	ANG.	REFERENCE

