

## CTSPI2D15F Series

From 1.0 $\mu$ H to 330 $\mu$ H



### SPECIFICATIONS

Please specify tolerance code when ordering.  
CTSPI2D15F-1R0\_ ← M =  $\pm 20\%$ , N =  $\pm 30\%$

Part Number	Inductance ( $\mu$ H)	Tolerance ( $\pm\%$ )	DCR Typ. ( $\Omega$ )	IDC Typ. (mA)	I <sub>rms</sub> Typ. (mA)	Color Coding
CTSPI2D15F-1R0_	1.0	20, 30	0.038	1040	1800	Green
CTSPI2D15F-1R2_	1.2	20, 30	0.041	1000	1740	Blue
CTSPI2D15F-1R5_	1.5	20, 30	0.046	940	1700	Violet
CTSPI2D15F-1R8_	1.8	20, 30	0.058	920	1640	Gray
CTSPI2D15F-2R2_	2.2	20, 30	0.066	880	1600	White
CTSPI2D15F-2R7_	2.7	20, 30	0.070	740	1450	Green
CTSPI2D15F-3R3_	3.3	20, 30	0.091	680	1240	Blue
CTSPI2D15F-3R9_	3.9	20, 30	0.115	620	1120	Violet
CTSPI2D15F-4R7_	4.7	20, 30	0.132	600	1100	Gray
CTSPI2D15F-5R6_	5.6	20, 30	0.156	580	1060	White
CTSPI2D15F-6R8_	6.8	20, 30	0.166	420	1000	Green
CTSPI2D15F-8R2_	8.2	20, 30	0.230	400	900	Blue
CTSPI2D15F-100M	10	20	0.244	380	800	Violet
CTSPI2D15F-120M	12	20	0.324	360	700	Gray
CTSPI2D15F-150M	15	20	0.370	360	700	White
CTSPI2D15F-180M	18	20	0.489	300	620	Green
CTSPI2D15F-220M	22	20	0.590	260	480	Blue
CTSPI2D15F-330M	33	20	0.990	230	740	Violet
CTSPI2D15F-470M	47	20	1.540	190	390	Gray
CTSPI2D15F-331_	330	20, 30	10.30	70	150	Yellow

### PHYSICAL DIMENSIONS

Size	A	B	C Max.	D	E
mm	3.2 $\pm$ 0.2	3.2 $\pm$ 0.2	1.60	1.1	0.8
inches	0.126 $\pm$ 0.008	0.126 $\pm$ 0.008	0.063	0.043	0.031

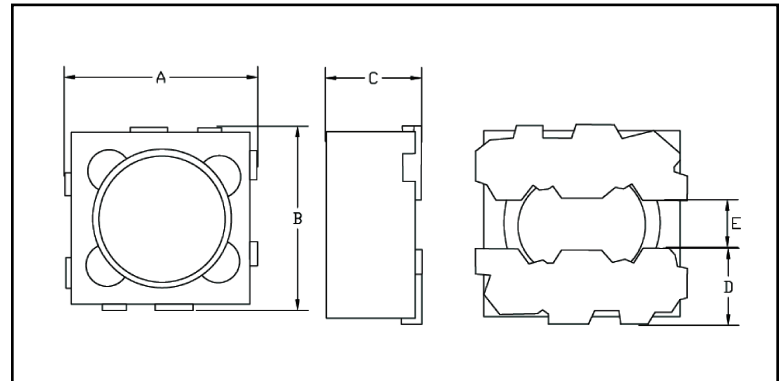

### CHARACTERISTICS

**Description:** SMD Shielded Power Inductors (low profile)

**Applications:** Cellular phones, PDAs, DVC, DSC, digital cameras, and hard disk drives

**Operating Temperature:** -40°C to +105°C

**Testing:** Inductance is tested on an HP4284A at 1KHz/1.0V

**IDC:** For inductance 10% or 35% from its value without current

**I<sub>rms</sub>:** For a 25°C or 40°C rise above 25°C ambient

**Packaging:** Tape & Reel.

**Additional Information:** Additional electrical & physical information available upon request.

**Samples available. See website for ordering information.**

### PAD LAYOUT

