

- 1
- 2
- 3
- 4
- 5
- 6
- 7
- 8
- 9
- 10
- 11
- 12
- 13
- 14
- 15
- 16
- 17
- 18

MATERIAL

Glass-fibre reinforced polyamide based (PA) technopolymer, grey-black colour, matte finish.

CAP

Glass-fibre reinforced polyamide based (PA) technopolymer, in Ergostyle colours, matte finish, press-fit assembly.
Available also as accessory sold separately (see table ECA.).

Code	Description	Cap for
29752-*	ECA.W2-*	EWN.48
29753-*	ECA.W3-*	EWN.55
29755-*	ECA.W5-*	EWN.63
29754-*	ECA.W4-*	EWN.70

* Complete with colour index (C1, ..., C17).

STANDARD EXECUTIONS

- **EWN-B:** brass boss, threaded pass-through hole, with cap.
- **EWN-SST:** AISI 303 stainless steel boss, threaded pass-through hole, with cap.
- **EWN-FP:** brass boss, threaded pass-through hole, without cap.
- **EWN-SST-FP:** AISI 303 stainless steel boss, threaded pass-through hole, without cap.
- **EWN-p:** zinc-plated steel threaded stud with chamfered flat end as in UNI 947 : ISO 4753 (see Technical data on page A-10), with cap.
- **EWN-SST-p:** AISI 303 stainless steel threaded stud, chamfered flat end according to UNI 947 : ISO 4753 (see Technical data on page A-10), with cap.

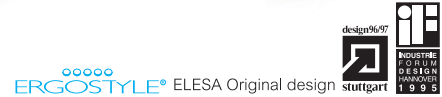

Conversion Table	
1 mm = 0.039 inch	
D	
mm	inch
40	1.57
47	1.85
55	2.16
63	2.48
70	2.76

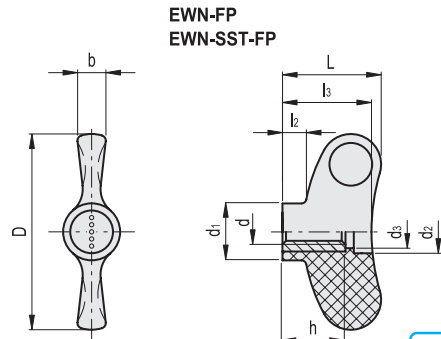

EWN-FP

Code	Description	D	d6H	L	d1	d2	d3	l2	l3	b	h	C# [Nm]	⚖
223115-C0	EWN.40 FP-M5-C0	40	M5	20	13.5	10	8.5	4	18	6	12	9	10
223116-C0	EWN.40 FP-M6-C0	40	M6	20	13.5	10	8.5	4	18	6	12	10	9
223117-C0	EWN.40 FP-M8-C0	40	M8	20	13.5	10	8.5	4	18	6	12	11	8
223122-C0	EWN.48 FP-M5-C0	47	M5	24	13.5	10	8.5	5.5	21.5	7	12	9	10
223123-C0	EWN.48 FP-M6-C0	47	M6	24	13.5	10	8.5	5.5	21.5	7	12	10	9
223124-C0	EWN.48 FP-M8-C0	47	M8	24	13.5	10	8.5	5.5	21.5	7	12	11	8
223132-C0	EWN.55 FP-M6-C0	55	M6	28	16	12	10.5	6.5	25	8	18	20	19
223133-C0	EWN.55 FP-M8-C0	55	M8	28	16	12	10.5	6.5	25	8	18	25	18
223144-C0	EWN.63 FP-M8-C0	63	M8	32	19	14	10.5	7.5	29	9	20	45	27
223145-C0	EWN.63 FP-M10-C0	63	M10	32	19	14	10.5	7.5	29	9	20	55	26
223152-C0	EWN.70 FP-M8-C0	70	M8	36	20	15	13	8	32	10	20	45	32
223153-C0	EWN.70 FP-M10-C0	70	M10	36	20	15	13	8	32	10	20	55	31

EWN-SST-FP

Code	Description	D	M	L	d1	d2	d3	l2	l3	b	h	C# [Nm]	⚖
224115-C0	EWN.40 SST-FP-M5-C0	40	M5	20	13.5	10	8.5	4	18	6	12	9	10
224116-C0	EWN.40 SST-FP-M6-C0	40	M6	20	13.5	10	8.5	4	18	6	12	9	9
224117-C0	EWN.40 SST-FP-M8-C0	40	M8	20	13.5	10	8.5	4	18	6	12	10	8
224122-C0	EWN.48 SST-FP-M6-C0	47	M6	24	13.5	10	8.5	5.5	21.5	7	12	10	9
224123-C0	EWN.48 SST-FP-M8-C0	47	M8	24	13.5	10	8.5	5.5	21.5	7	12	10	8
224133-C0	EWN.55 SST-FP-M8-C0	55	M8	28	16	12	10.5	6.5	25	8	18	20	18
224143-C0	EWN.63 SST-FP-M10-C0	63	M10	32	19	14	10.5	7.5	29	9	20	45	26
224153-C0	EWN.70 SST-FP-M10-C0	70	M10	36	20	15	13	8	32	10	20	45	31

Clamping knobs

"Max limit Tightening torque" means the max torque value at which the metal insert, in normal conditions of use, is perfectly and strongly anchored to the plastic material.

EWN-p
EWN-SST-p

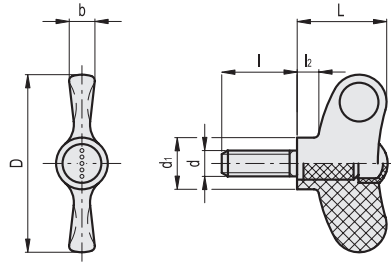

Conversion Table
1 mm = 0.039 inch

D	
mm	inch
40	1.57
47	1.85
55	2.16
63	2.48
70	2.76



* Complete with colour index, example: 223216-C2 EWN.48 B-M5-C2

- C1 RAL7021
- C2 RAL2004
- C3 RAL7035
- C4 RAL1021
- C5 RAL5024
- C6 RAL3000
- C17 RAL6017

METRIC

EWN-B

Code	Description	D	d6H	L	d1	l2	b	h	C# [Nm]	⚖️
223201-*	EWN.40 B-M5-*	40	M5	20	13.5	4	6	12	10	10
223206-*	EWN.40 B-M6-*	40	M6	20	13.5	4	6	12	11	9
223211-*	EWN.40 B-M8-*	40	M8	20	13.5	4	6	12	13	8
223216-*	EWN.48 B-M5-*	47	M5	24	13.5	5.5	7	12	10	11
223221-*	EWN.48 B-M6-*	47	M6	24	13.5	5.5	7	12	11	10
223226-*	EWN.48 B-M8-*	47	M8	24	13.5	5.5	7	12	13	9
223236-*	EWN.55 B-M6-*	55	M6	28	16	6.5	8	18	20	20
223241-*	EWN.55 B-M8-*	55	M8	28	16	6.5	8	18	26	19
223251-*	EWN.63-B M8-*	63	M8	32	19	7.5	9	20	45	29
223256-*	EWN.63-B M10-*	63	M10	32	19	7.5	9	20	58	28
223406-*	EWN.70 B-M8-*	70	M8	36	20	8	10	20	45	34
223411-*	EWN.70 B-M10-*	70	M10	36	20	8	10	20	58	33

EWN-SST

INOX STAINLESS STEEL METRIC

Code	Description	D	d6H	L	d1	l2	b	h	C# [Nm]	⚖️
224201-*	EWN.40 SST-M5-*	40	M5	20	13.5	4	6	12	10	10
224206-*	EWN.40 SST-M6-*	40	M6	20	13.5	4	6	12	10	9
224211-*	EWN.40 SST-M8-*	40	M8	20	13.5	4	6	12	10	8
224216-*	EWN.48 SST-M6-*	47	M6	24	13.5	5.5	7	12	10	10
224221-*	EWN.48 SST-M8-*	47	M8	24	13.5	5.5	7	12	10	9
224241-*	EWN.55 SST-M8-*	55	M8	28	16	6.5	8	18	15	19
224256-*	EWN.63-SST M10-*	63	M10	32	19	7.5	9	20	35	28
224411-*	EWN.70 SST-M10-*	70	M10	36	20	8	10	20	35	33

EWN-p

METRIC

Code	Description	D	d6g	L	d1	l	l2	b	C# [Nm]	⚖️
223441-*	EWN.40 p-M5x16-*	40	M5	20	13.5	16	4	6	9	8
223443-*	EWN.40 p-M5x20-*	40	M5	20	13.5	20	4	6	9	8
223447-*	EWN.40 p-M5x30-*	40	M5	20	13.5	30	4	6	9	8
223451-*	EWN.40 p-M6x16-*	40	M6	20	13.5	16	4	6	12	8
223453-*	EWN.40 p-M6x20-*	40	M6	20	13.5	20	4	6	12	8
223455-*	EWN.40 p-M6x25-*	40	M6	20	13.5	25	4	6	12	8
223457-*	EWN.40 p-M6x30-*	40	M6	20	13.5	30	4	6	12	8
223459-*	EWN.40 p-M6x40-*	40	M6	20	13.5	40	4	6	12	8
223461-*	EWN.40 p-M8x16-*	40	M8	20	13.5	16	4	6	12	9
223463-*	EWN.40 p-M8x20-*	40	M8	20	13.5	20	4	6	12	9
223465-*	EWN.40 p-M8x25-*	40	M8	20	13.5	25	4	6	12	9
223467-*	EWN.40 p-M8x30-*	40	M8	20	13.5	30	4	6	12	9
223469-*	EWN.40 p-M8x40-*	40	M8	20	13.5	40	4	6	12	9

"Max limit Tightening torque" means the max torque value at which the metal insert, in normal conditions of use, is perfectly and strongly anchored to the plastic material.

- 1
- 2
- 3
- 4
- 5
- 6
- 7
- 8
- 9
- 10
- 11
- 12
- 13
- 14
- 15
- 16
- 17
- 18

EWN-p
EWN-SST-p

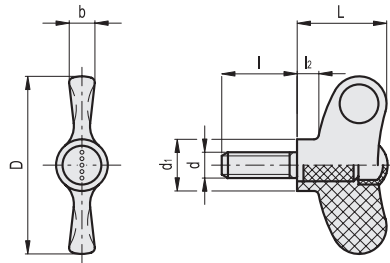

Conversion Table	
1 mm = 0,039 inch	
D	
mm	inch
40	1.57
47	1.85
55	2.16
63	2.48
70	2.76



*Complete with colour index, example: 223511-C2 EWN.48 p-M5x16-C2

- C1 RAL7021
- C2 RAL2004
- C3 RAL7035
- C4 RAL1021
- C5 RAL5024
- C6 RAL3000
- C17 RAL6017

EWN-p		METRIC									
Code	Description	D	d6g	L	d1	l	l2	b	C#	Δ	Δ
									[Nm]		
223511*	EWN.48 p-M5x16*	47	M5	24	13.5	16	5.5	7	9	11	
223516*	EWN.48 p-M5x20*	47	M5	24	13.5	20	5.5	7	9	12	
223519*	EWN.48 p-M5x30*	47	M5	24	13.5	30	5.5	7	9	14	
223531*	EWN.48 p-M6x16*	47	M6	24	13.5	16	5.5	7	12	13	
223536*	EWN.48 p-M6x20*	47	M6	24	13.5	20	5.5	7	12	13	
223541*	EWN.48 p-M6x25*	47	M6	24	13.5	25	5.5	7	12	13	
223546*	EWN.48 p-M6x30*	47	M6	24	13.5	30	5.5	7	12	15	
223556*	EWN.48 p-M6x40*	47	M6	24	13.5	40	5.5	7	12	17	
223565*	EWN.48 p-M8x16*	47	M8	24	13.5	16	5.5	7	12	13	
223571*	EWN.48 p-M8x20*	47	M8	24	13.5	20	5.5	7	12	19	
223572*	EWN.48 p-M8x25*	47	M8	24	13.5	25	5.5	7	12	13	
223573*	EWN.48 p-M8x30*	47	M8	24	13.5	30	5.5	7	12	21	
223576*	EWN.48 p-M8x40*	47	M8	24	13.5	40	5.5	7	12	24	
223626*	EWN.55 p-M8x20*	55	M8	28	16	20	6.5	8	22	23	
223636*	EWN.55 p-M8x30*	55	M8	28	16	30	6.5	8	22	26	
223646*	EWN.55 p-M8x40*	55	M8	28	16	40	6.5	8	22	29	
223666*	EWN.55 p-M10x20*	55	M10	28	16	20	6.5	8	25	28	
223676*	EWN.55 p-M10x30*	55	M10	28	16	30	6.5	8	25	34	
223686*	EWN.55 p-M10x40*	55	M10	28	16	40	6.5	8	25	40	
223726*	EWN.63 p-M8x20*	63	M8	32	19	20	7.5	9	32	30	
223736*	EWN.63 p-M8x30*	63	M8	32	19	30	7.5	9	32	33	
223746*	EWN.63 p-M8x40*	63	M8	32	19	40	7.5	9	32	35	
223756*	EWN.63 p-M10x20*	63	M10	32	19	20	7.5	9	48	36	
223766*	EWN.63 p-M10x30*	63	M10	32	19	30	7.5	9	48	42	
223776*	EWN.63 p-M10x40*	63	M10	32	19	40	7.5	9	48	48	
223806*	EWN.70 p-M8x20*	70	M8	36	20	20	8	10	32	35	
223816*	EWN.70 p-M8x30*	70	M8	36	20	30	8	10	32	38	
223826*	EWN.70 p-M8x40*	70	M8	36	20	40	8	10	32	40	
223856*	EWN.70 p-M10x20*	70	M10	36	20	20	8	10	48	41	
223866*	EWN.70 p-M10x30*	70	M10	36	20	30	8	10	48	47	
223876*	EWN.70 p-M10x40*	70	M10	36	20	40	8	10	48	53	

EWN-SST-p		INOX STAINLESS STEEL METRIC									
Code	Description	D	d6g	L	d1	l	l2	b	C#	Δ	Δ
									[Nm]		
224441*	EWN.40 SST-p-M5x16*	40	M5	20	13.5	16	4	6	9	8	
224443*	EWN.40 SST-p-M5x20*	40	M5	20	13.5	20	4	6	9	8	
224453*	EWN.40 SST-p-M6x20*	40	M6	20	13.5	20	4	6	11	8	
224457*	EWN.40 SST-p-M6x30*	40	M6	20	13.5	30	4	6	11	8	
224463*	EWN.40 SST-p-M8x20*	40	M8	20	13.5	20	4	6	11	9	
224467*	EWN.40 SST-p-M8x30*	40	M8	20	13.5	30	4	6	11	9	
224469*	EWN.40 SST-p-M8x40*	40	M8	20	13.5	40	4	6	11	9	
224536*	EWN.48 SST-p-M6x20*	47	M6	24	13.5	20	5.5	7	11	13	
224546*	EWN.48 SST-p-M6x30*	47	M6	24	13.5	30	5.5	7	11	15	
224549*	EWN.48 SST-p-M8x20*	47	M8	24	13.5	20	5.5	7	11	20	
224551*	EWN.48 SST-p-M8x30*	47	M8	24	13.5	30	5.5	7	11	22	
224553*	EWN.48 SST-p-M8x40*	47	M8	24	13.5	40	5.5	7	11	25	
224626*	EWN.55 SST-p-M8x20*	55	M8	28	16	20	6.5	8	16	23	
224636*	EWN.55 SST-p-M8x30*	55	M8	28	16	30	6.5	8	16	26	
224638*	EWN.55 SST-p-M8x40*	55	M8	28	16	40	6.5	8	16	30	
224756*	EWN.63-SST-p M10x20*	63	M10	32	19	20	7.5	9	45	36	
224766*	EWN.63-SST-p M10x30*	63	M10	32	19	30	7.5	9	45	42	
224856*	EWN.70 SST-p-M10x20*	70	M10	36	20	20	8	10	45	41	
224866*	EWN.70 SST-p-M10x30*	70	M10	36	20	30	8	10	45	47	
224876*	EWN.70 SST-p-M10x40*	70	M10	36	20	40	8	10	45	54	

"Max limit Tightening torque" means the max torque value at which the metal insert, in normal conditions of use, is perfectly and strongly anchored to the plastic material..

Clamping knobs