

XVUZ800

Harmony XVU, Fixing plate with 800 mm aluminium pole for modular tower lights, black, Ø60



Main

| | |
|------------------------------------|-------------------------------|
| Range of Product | Harmony XVU |
| Product or Component Type | Modular tower light |
| Accessory / Separate Part Type | Fixing plate |
| Accessory / separate part category | Mounting and fixing accessory |
| Component name | XVU |
| Mounting diameter | 2.36 in (60 mm) |

Complementary

| | |
|---------------------------|--|
| Pole height | 31.50 in (800 mm) |
| Mounting Support | Plate with pole |
| Product compatibility | Top AC/DC body |
| Material | PBT (polybutylene terephthalate) V-0 UL 94 ABS (acrylonitrile butadiene-styrene) PC (polycarbonate) Aluminium |
| Housing Colour | Black |
| Connections - Terminals | Push-in |
| [Us] Rated Supply Voltage | 24 V AC/DC 110...240 V AC |
| Length | 32.17 in (817 mm) |
| Net Weight | 0.95 lb(US) (0.43 kg) |

Environment

| | |
|---------------------------------------|----------------------------|
| Ambient Air Temperature for Storage | -40...158 °F (-40...70 °C) |
| Ambient air temperature for operation | -13...122 °F (-25...50 °C) |
| IP degree of protection | IP65 |
| Product Certifications | UL CSA CE |

Ordering and shipping details

| | |
|-----------------------|--------------------------|
| Category | 22618 - XVU TOWER LIGHTS |
| Discount Schedule | XV |
| GTIN | 3606485433172 |
| Nbr. of units in pkg. | 1 |
| Package weight(Lbs) | 32.06 oz (909 g) |
| Returnability | No |
| Country of origin | ID |

Packing Units

| | |
|------------------------------|--------------------------|
| Unit Type of Package 1 | PCE |
| Package 1 Height | 3.54 in (9 cm) |
| Package 1 width | 3.74 in (9.5 cm) |
| Package 1 Length | 37.99 in (96.5 cm) |
| Unit Type of Package 2 | S03 |
| Number of Units in Package 2 | 1 |
| Package 2 Weight | 25.15 oz (713 g) |
| Package 2 Height | 11.81 in (30 cm) |
| Package 2 width | 11.81 in (30 cm) |
| Package 2 Length | 15.75 in (40 cm) |
| Unit Type of Package 3 | S04 |
| Number of Units in Package 3 | 12 |
| Package 3 Weight | 79.16 lb(US) (35.908 kg) |
| Package 3 Height | 11.81 in (30 cm) |
| Package 3 width | 15.75 in (40 cm) |
| Package 3 Length | 23.62 in (60 cm) |

Offer Sustainability

| | |
|----------------------------|--|
| REACH Regulation | REACH Declaration |
| EU RoHS Directive | Compliant EU RoHS Declaration |
| Mercury free | Yes |
| RoHS exemption information | Yes |
| China RoHS Regulation | China RoHS Declaration |
| WEEE | The product must be disposed on European Union markets following specific waste collection and never end up in rubbish bins. |

Fixing Unit - Plate with Pole

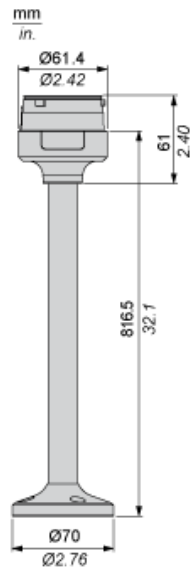

Modular Tower Lights Mounting

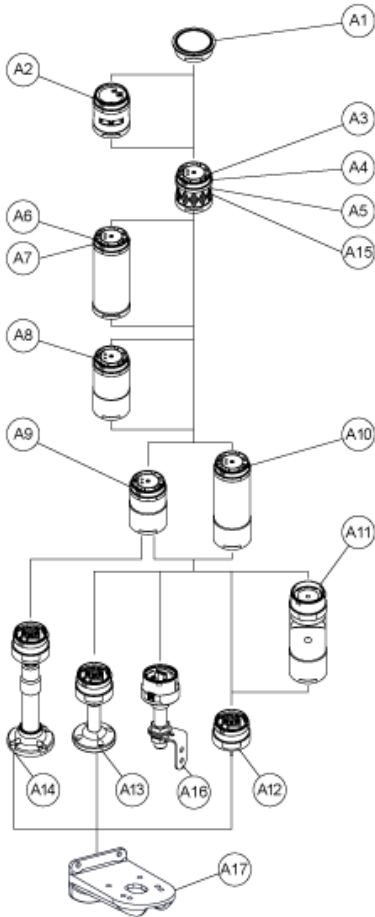

| Drawing | Part number | Part name |
|----------|----------------------|------------------------------|
| A1 | - | Top cover |
| - | Top cover (Silver) | |
| A2 | XVUC9S | Buzzer unit |
| XVUC9SQ | Buzzer unit (Silver) | |
| A3 | XVUC23 | Green LED unit |
| XVUC24 | Red LED unit | |
| XVUC25 | Orange LED unit | |
| XVUC26 | Blue LED unit | |
| XVUC27 | White LED unit | |
| XVUC28 | Yellow LED unit | |
| A4 | XVUC29 | Multi-LED unit |
| A5 | XVUC29P | Multi-LED unit, Pulse signal |
| A6 | XVUC9V | Sound unit |
| A7 | XVUC9VP | Sound unit, Pulse signal |
| A8 | XVUC020 | Extender |
| XVUC020Q | Extender (Silver) | |
| A9 | XVUC21B | DC body |

| Drawing | Part number | Part name |
|-----------|--|---|
| XVUC21BQ | DC body (Silver) | |
| A10 | XVUC21M | AC body NPN |
| XVUC21MP | AC body PNP | |
| XVUC21MQP | AC body PNP (Silver) | |
| A11 | XVUZ06 | Flexible option |
| A12 | XVUZ01 | Fixing Unit - Direct mounting (3 pins) |
| XVUZ01Q | Fixing Unit - Direct mounting (Silver,3 pins) | |
| XVUZ03 | Fixing Unit - Direct mounting (2 pins) | |
| XVUZ04 | Fixing Unit - Direct mounting (4 pins) | |
| A13 | XVUZ02 | Fixing Unit - Plate with Pole (100 mm) |
| XVUZ02Q | Fixing Unit - Plate with Pole (100 mm, Silver) | |
| XVUZ400 | Fixing Unit - Plate with Pole (400 mm) | |
| XVUZ800 | Fixing Unit - Plate with Pole (800 mm) | |
| A14 | XVUZ05 | Fixing Unit - Plate with adjustment pole (100-385 mm) |
| A15 | XVUC43 | Green LED unit, Flash |
| XVUC44 | Red LED unit, Flash | |
| XVUC45 | Orange LED unit, Flash | |
| XVUC46 | Blue LED unit, Flash | |
| XVUC47 | White LED unit, Flash | |
| XVUC48 | Yellow LED unit, Flash | |
| A16 | XVUZ100T | Fixing Unit - Metal bracket with pole (100 mm) |
| XVUZ250T | Fixing Unit - Metal bracket with pole(250 mm) | |
| XVUZ400T | Fixing Unit - Metal bracket with pole (400 mm) | |
| A17 | XVUZ12 | Fixing plate for use on vertical support - black |

Modular Tower Lights Mounting

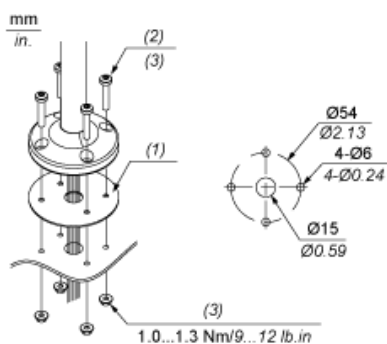

- (1) Gasket
- (2) Screw x 4 (unattached)
- (3) M5 x (thickness+10 mm /0.39 in.)

Illuminated Units, Multi-LED and Audible Units Wiring

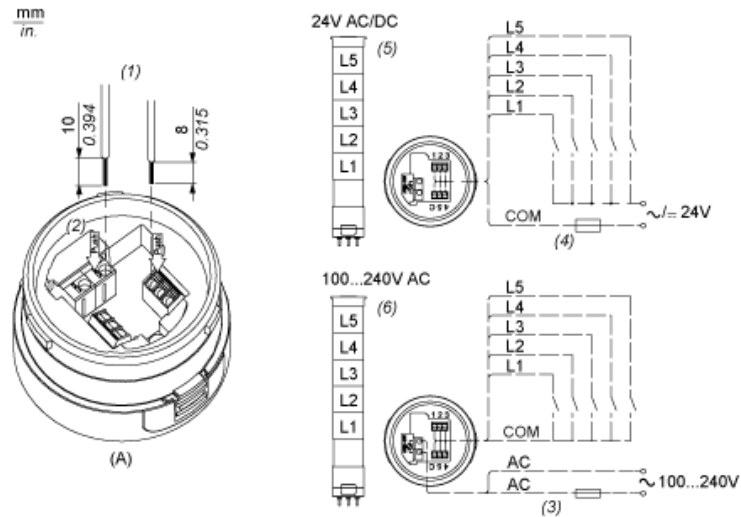

- (A) Fixing Unit
 - (1) Dimensions of Wiring size
 - (2) Push-in Wire Connectors
 - (3) Fuse : 2A ,250V
 - (4) Fuse : 0.5A , 125V
 - (5) Modular Tower Lights 24V AC/DC
 - (6) Modular Tower Lights 100...240V AC
- L1 to Illuminated LED Units
L5 :