

NOTES:

1. METALSHELLS: STEEL; min. 315µin TIN over 40-80µin NICKEL
2. INSULATORS: PBT GF UL 94 V-0; BLACK
3. CONTACTS: COPPER ALLOY
PLATING: 8µin HARD GOLD over min. 50µin NICKEL
4. THREADED SPACER CLIPS: COPPER ALLOY; min. 200µin TIN over 80µin NICKEL
PCB-HOLE: $\varnothing 3.1 \pm 0,1$; PCB THICKNESS 2,3mm
5. COLLARS: COPPER ALLOY; min. 200µin TIN over 80µin NICKEL
6. MAXIMUM TORQUE VALUE FOR THREAD: 6 in.LB
7. P.C.B. HOLE DRILLINGS ON SHEET 2
8. CONNECTOR IS PART MARKED: DSS3XPRAA15X CONEC ABC

Directive 2002/95/EC
"RoHS"
Compliant

APPROVAL # FREIGABE # AUTORIZACION # APPROVAL	
CUSTOMER APPROVAL DATE:	
NAME:	TITLE:
COMPANY NAME:	
APPROVAL # FREIGABE # AUTORIZACION # APPROVAL	

THIS DRAWING MAY NOT BE COPIED OR REPRODUCED IN ANY WAY, AND MAY NOT BE PASSED ON TO A THIRD PARTY WITHOUT WRITTEN PERMISSION. OWNERSHIP AND COPYRIGHT OF CONEC GmbH DO NOT ALTER CAD DRAWING BY HAND				tolerance		 dim. in mm	
				date	name		
				drawn	16.12.09		Lehmenkühler
				appd.	16.12.09		Kühle
norm							
d-old							
a	Origin						
rev.	description						
date	name						

scale: 2:1 (5:1)	
material: SEE NOTES	
title: D-SUB MALE 25pos. SOLDER PIN STRAIGHT with threaded spacer clip	
dwg no: Inventor 10	DIN-A3
16K1A2574-NA	
part no: DSS3XPRAA15X North American Version	
sh: 1	

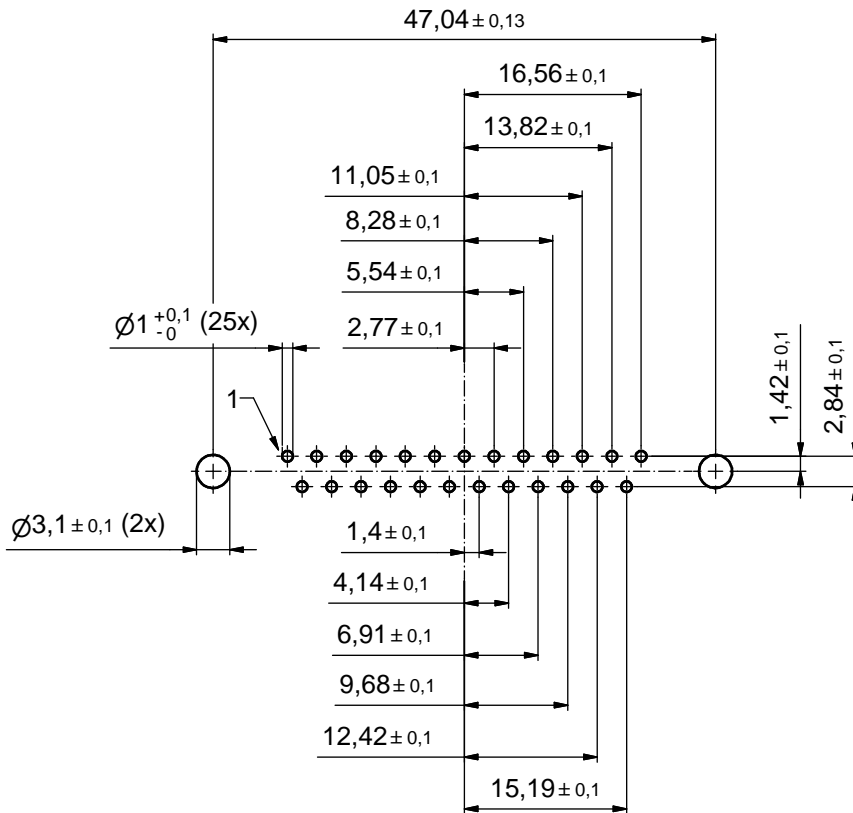

PCB TOP SIDE

APPROVAL # FREIGABE # DEBLOCAGE # AUTORIZACION # APPROVAL	
CUSTOMER APPROVAL DATE:	
NAME:	TITLE:
COMPANY NAME:	
APPROVAL # FREIGABE # DEBLOCAGE # AUTORIZACION # APPROVAL	

THIS DRAWING MAY NOT BE COPIED OR REPRODUCED IN ANY WAY, AND MAY NOT BE PASSED ON TO A THIRD PARTY WITHOUT WRITTEN PERMISSION. OWNERSHIP AND COPYRIGHT OF CONEC GmbH				tolerance		dim. in mm	
DO NOT ALTER CAD DRAWING BY HAND				date	name		
a Origin				drawn	16.12.	Lehmenkühler	
rev.				appd.	16.12.	Kühle	
				norm			
				d-old			

scale: 2:1	
material: SEE SHEET 1	
title: P.C.B. HOLE DRILLINGS D-SUB MALE 25pos. SOLDER PIN with threaded spacer clip	
dwg no: Inventor 10	DIN-A3
16K1A2574-NA	
sh: 2	
part no: SEE SHEET 1	