

| PANDUIT PART # | WIRE RANGE | | WIRE STRIP LENGTH +1/32 -0 [+0,8 -0] | WIRE CLASS | DIMENSIONS in. [mm] | | | | INSTALLATION TOOLS/DIES |
|----------------|------------|--------------------|--|------------|---------------------|--------------|-------------|-------------|--|
| | AWG | [mm ²] | | | L | ID-1 (REF.) | OD-1 (REF.) | OD-2 | |
| * F73-5 | 24 | [0,25] | 7/32 [5,0] | B, K, M | 0.20 [15,0] | 0.03 [0,8] | 0.04 [1,1] | 0.07 [1,7] | CT-1002 CT-1123 #CT-2523CH |
| * F73-7 | | | 9/32 [7,0] | | 0.28 [7,0] | 0.03 [0,8] | 0.04 [1,1] | 0.07 [1,7] | |
| * F74-5 | 24-22 | [0,34] | 7/32 [5,0] | B, K, M | 0.20 [15,0] | 0.04 [0,9] | 0.05 [1,2] | 0.07 [1,8] | |
| * F74-7 | | | 9/32 [7,0] | | 0.28 [7,0] | 0.04 [0,9] | 0.05 [1,2] | 0.07 [1,8] | |
| + F75-6 | 22-20 | [0,50] | 1/4 [6,0] | B, K, M | 0.24 [6,0] | 0.04 [1,0] | 0.05 [1,3] | 0.08 [2,1] | |
| + F75-8 | | | 5/16 [8,0] | | 0.31 [8,0] | 0.04 [1,0] | 0.05 [1,3] | 0.08 [2,1] | |
| + F75-10 | | | 13/32 [10,0] | | 0.39 [10,0] | 0.04 [1,0] | 0.05 [1,3] | 0.08 [2,1] | |
| F76-6 | 18 | [0,75] | 1/4 [6,0] | B, K, M | 0.24 [6,0] | 0.05 [1,2] | 0.06 [1,5] | 0.09 [2,3] | CT-1002 CT-1003 CT-1090 ^^CD-090 CT-1123 CT-1160 CT-1170 #CT-2523CH |
| F76-8 | | | 5/16 [8,0] | | 0.31 [8,0] | 0.05 [1,2] | 0.06 [1,5] | 0.09 [2,3] | |
| F76-10 | | | 13/32 [10,0] | | 0.39 [10,0] | 0.05 [1,2] | 0.06 [1,5] | 0.09 [2,3] | |
| F76-12 | | | 15/32 [12,0] | | 0.47 [12,0] | 0.05 [1,2] | 0.06 [1,5] | 0.09 [2,3] | |
| F77-6 | - | [1,00] | 1/4 [6,0] | B, K, M | 0.24 [6,0] | 0.06 [1,4] | 0.07 [1,7] | 0.10 [2,5] | |
| F77-7 | | | 9/32 [7,0] | | 0.28 [7,0] | 0.06 [1,4] | 0.07 [1,7] | 0.10 [2,5] | |
| F77-8 | | | 5/16 [8,0] | | 0.31 [8,0] | 0.06 [1,4] | 0.07 [1,7] | 0.10 [2,5] | |
| F77-10 | | | 13/32 [10,0] | | 0.39 [10,0] | 0.06 [1,4] | 0.07 [1,7] | 0.10 [2,5] | |
| F77-12 | | | 15/32 [12,0] | | 0.47 [12,0] | 0.06 [1,4] | 0.07 [1,7] | 0.10 [2,5] | |
| F78-7 | 16 | [1,50] | 9/32 [7,0] | B, K, M | 0.28 [7,0] | 0.07 [1,7] | 0.08 [2,0] | 0.11 [2,8] | |
| F78-8 | | | 5/16 [8,0] | | 0.31 [8,0] | 0.07 [1,7] | 0.08 [2,0] | 0.11 [2,8] | |
| F78-10 | | | 13/32 [10,0] | | 0.39 [10,0] | 0.07 [1,7] | 0.08 [2,0] | 0.11 [2,8] | |
| F78-12 | | | 15/32 [12,0] | | 0.47 [12,0] | 0.07 [1,7] | 0.08 [2,0] | 0.11 [2,8] | |
| F78-15 | | | 19/32 [15,0] | | 0.59 [15,0] | 0.07 [1,7] | 0.08 [2,0] | 0.11 [2,8] | |
| F78-18 | | | 23/32 [18,0] | | 0.71 [18,0] | 0.07 [1,7] | 0.08 [2,0] | 0.11 [2,8] | |
| F78-20 | | | 25/32 [20,0] | | 0.79 [20,0] | 0.07 [1,7] | 0.08 [2,0] | 0.11 [2,8] | |
| F78-20 | | | | | | 25/32 [20,0] | | 0.79 [20,0] | 0.07 [1,7] |

- * NOT UL LISTED, UL486 SCOPE IS 20 - 1/0 AWG ONLY
- + UL LISTED WITH 20 AWG ONLY
- ++ TOOL/PART COMBINATION IS NOT UL LISTED
- ^ TOOL/PART COMBINATION IS NOT UL LISTED WITH CLASS I WIRE
- ^^ DIES USED WITH CT-2300 TOOL
- # CRIMP HEAD USED WITH CT-2500 TOOL

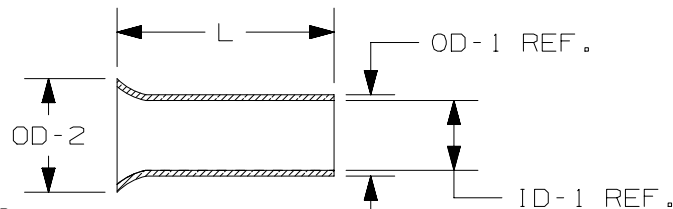

NOTES:

1. USED FOR:
 - A. UL LISTED WITH STRANDED COPPER WIRE 20 - 1/0 AWG ONLY
 - B. 302°F [150°C] MAX. OPERATING TEMPERATURE
2. MATERIAL:
 - A. STAMPING: COPPER, TIN PLATED
3. SEE www.panduit.com FOR PACKAGE QUANTITIES
4. DIMENSIONS IN BRACKETS ARE METRIC EQUIVALENT
5. FOR TOLERANCING REFER TO DIN 46228 PART 1

| PANDUIT PART # | WIRE RANGE | | WIRE STRIP LENGTH +1/32 -0 [+0,8 -0] | WIRE CLASS | DIMENSIONS in. [mm] | | | | INSTALLATION TOOLS/DIES |
|----------------|--------------|--------------------|--|--------------|---------------------|--------------|---------------|-------------|--|
| | AWG | [mm ²] | | | L | ID-1 (REF.) | OD-1 (REF.) | OD-2 | |
| F80-7 | 14 | [2,50] | 9/32 [7,0] | G, K, M | 0.28 [7,0] | 0.09 [2,2] | 0.10 [2,5] | 0.13 [3,4] | CT-1002 CT-1003 CT-1090 ^^CD-090 CT-1123 CT-1160 CT-1170 #CT-2523CH |
| F80-8 | | | 5/16 [8,0] | | 0.31 [8,0] | 0.09 [2,2] | 0.10 [2,5] | 0.13 [3,4] | |
| F80-10 | | | 13/32 [10,0] | | 0.39 [10,0] | 0.09 [2,2] | 0.10 [2,5] | 0.13 [3,4] | |
| F80-12 | | | 15/32 [12,0] | | 0.47 [12,0] | 0.09 [2,2] | 0.10 [2,5] | 0.13 [3,4] | |
| F80-15 | | | 19/32 [15,0] | | 0.59 [15,0] | 0.09 [2,2] | 0.10 [2,5] | 0.13 [3,4] | |
| F80-18 | | | 23/32 [18,0] | | 0.71 [18,0] | 0.09 [2,2] | 0.10 [2,5] | 0.13 [3,4] | |
| F80-20 | 25/32 [20,0] | 0.79 [20,0] | 0.09 [2,2] | 0.10 [2,5] | 0.13 [3,4] | | | | |
| F81-9 | 12 | [4,00] | 11/32 [8,0] | G, K, M | 0.35 [9,0] | 0.11 [2,8] | 0.13 [3,2] | 0.16 [4,0] | |
| F81-10 | | | 13/32 [10,0] | | 0.39 [10,0] | 0.11 [2,8] | 0.13 [3,2] | 0.16 [4,0] | |
| F81-12 | | | 15/32 [12,0] | | 0.47 [12,0] | 0.11 [2,8] | 0.13 [3,2] | 0.16 [4,0] | |
| F81-15 | | | 19/32 [15,0] | | 0.59 [15,0] | 0.11 [2,8] | 0.13 [3,2] | 0.16 [4,0] | |
| F81-18 | | | 23/32 [18,0] | | 0.71 [18,0] | 0.11 [2,8] | 0.13 [3,2] | 0.16 [4,0] | |
| F81-20 | | | 25/32 [20,0] | | 0.79 [20,0] | 0.11 [2,8] | 0.13 [3,2] | 0.16 [4,0] | |
| F82-10 | 10 | [6,00] | 13/32 [10,0] | G, I, K, M | 0.39 [10,0] | 0.14 [3,5] | 0.15 [3,9] | 0.19 [4,7] | CT-1002 ++CT-1003 CT-1090 ^^CD-090 CT-1123 CT-1160 CT-1170 #CT-2523CH |
| F82-12 | | | 15/32 [12,0] | | 0.47 [12,0] | 0.14 [3,5] | 0.15 [3,9] | 0.19 [4,7] | |
| F82-15 | | | 19/32 [15,0] | | 0.59 [15,0] | 0.14 [3,5] | 0.15 [3,9] | 0.19 [4,7] | |
| F82-18 | | | 23/32 [18,0] | | 0.71 [18,0] | 0.14 [3,5] | 0.15 [3,9] | 0.19 [4,7] | |
| F82-20 | | | 25/32 [20,0] | | 0.79 [20,0] | 0.14 [3,5] | 0.15 [3,9] | 0.19 [4,7] | |
| F83-12 | | | 8 | | [10,0] | 15/32 [12,0] | G, H, I, K, M | 0.47 [12,0] | |
| F83-15 | 19/32 [15,0] | 0.59 [15,0] | | 0.18 [4,5] | | 0.19 [4,9] | | 0.23 [5,8] | |
| F83-18 | 23/32 [18,0] | 0.71 [18,0] | | 0.18 [4,5] | | 0.19 [4,9] | | 0.23 [5,8] | |
| F83-20 | 25/32 [20,0] | 0.79 [20,0] | | 0.18 [4,5] | | 0.19 [4,9] | | 0.23 [5,8] | |
| F83-25 | 31/32 [25,0] | 0.98 [25,0] | | 0.18 [4,5] | | 0.19 [4,9] | | 0.23 [5,8] | |
| F83-25 | | | | 31/32 [25,0] | | | | 0.98 [25,0] | |



| REV | DATE | BY | CHK | APR | DESCRIPTION | ECN |
|-----|---------|------|------|------|---|--------|
| 22 | 3.16.18 | JHNU | BJPU | JADE | REVISED WIRE RANGE FOR F94-40: 400 [203] WAS 500 [240] | A41670 |
| 21 | 8.28.17 | JHNU | TMR | RGB | ADDED CD-920 DIES TO F87, F88, F90, F91, F92, F93, F94 FERRULES | A41670 |

| | | | | |
|---|---------|--|--------|------|
| TITLE | | FERRULES - BARE, NO SLEEVE SHEET 1 OF 2 | | |
| ITEM REVISION NAME | | N41670BA/22 | | |
| DATASET FILE NAME | | N41670BA_DC/22 | | |
| UNLESS OTHERWISE SPECIFIED, DIMENSIONAL TOLERANCES ARE: IN [mm] | | MATERIAL: SEE NOTES | | |
| DRAWING NUMBER: | | A41670 | | |
| DRAWN BY | DATE | CHK | SCALE | SIZE |
| JKD | 2/10/99 | SKB | N.T.S. | B |

| PANDUIT PART # | WIRE RANGE | | WIRE STRIP LENGTH +1/32 -0 [+0,8 -0] | WIRE CLASS | DIMENSIONS in. [mm] | | | | INSTALLATION TOOLS |
|----------------|--------------|--------------------|--|---------------|---------------------|--------------|---------------|-------------|------------------------------------|
| | AWG | [mm ²] | | | L | ID-1 (REF.) | OD-1 (REF.) | OD-2 | |
| F84-12 | 6 | [16,0] | 15/32 [12,0] | G, H, I, K, M | 0.47 [12,0] | 0.23 [5,8] | 0.24 [6,2] | 0.30 [7,5] | ++CT-1004 CT-1104 #CT-2504CH |
| F84-15 | | | 19/32 [15,0] | | 0.59 [15,0] | 0.23 [5,8] | 0.24 [6,2] | 0.30 [7,5] | |
| F84-18 | | | 23/32 [18,0] | | 0.71 [18,0] | 0.23 [5,8] | 0.24 [6,2] | 0.30 [7,5] | |
| F84-20 | | | 25/32 [20,0] | | 0.79 [20,0] | 0.23 [5,8] | 0.24 [6,2] | 0.30 [7,5] | |
| F84-25 | | | 31/32 [25,0] | | 0.98 [25,0] | 0.23 [5,8] | 0.24 [6,2] | 0.30 [7,5] | |
| F84-32 | | | 1-1/4 [32,0] | | 1.26 [32,0] | 0.23 [5,8] | 0.24 [6,2] | 0.30 [7,5] | |
| F85-12 | 4 | [25] | 15/32 [12,0] | G, H, I, K, M | 0.47 [12,0] | 0.29 [7,3] | 0.30 [7,7] | 0.37 [9,5] | CT-1005 |
| F85-15 | | | 19/32 [15,0] | | 0.59 [15,0] | 0.29 [7,3] | 0.30 [7,7] | 0.37 [9,5] | |
| F85-18 | | | 23/32 [18,0] | | 0.71 [18,0] | 0.29 [7,3] | 0.30 [7,7] | 0.37 [9,5] | |
| F85-25 | | | 31/32 [25,0] | | 0.98 [25,0] | 0.29 [7,3] | 0.30 [7,7] | 0.37 [9,5] | |
| F85-32 | | | 1 1/4 [32,0] | | 1.26 [32,0] | 0.29 [7,3] | 0.30 [7,7] | 0.37 [9,5] | |
| F86-18 | | | 2 | | [35] | 23/32 [18,0] | G, H, I, K, M | 0.71 [18,0] | |
| F86-20 | 25/32 [20,0] | 0.79 [20,0] | | 0.33 [8,3] | | 0.34 [8,7] | | 0.43 [11,0] | |
| F86-25 | 31/32 [25,0] | 0.98 [25,0] | | 0.33 [8,3] | | 0.34 [8,7] | | 0.43 [11,0] | |
| F86-32 | 1 1/4 [32,0] | 1.26 [32,0] | | 0.33 [8,3] | | 0.34 [8,7] | | 0.43 [11,0] | |

* NOT UL LISTED, UL486F SCOPE IS 20 - 1/0 AWG ONLY
 ++ TOOL/PART COMBINATION IS NOT UL LISTED
 ** DIES USED WITH CT-3001 OR CT-3001/E TOOL
 # CRIMP HEAD USED WITH CT-2500 TOOL
 @ DIES USED WITH CT-3001/ST, CT-3001/CCP SERIES TOOLS AND CT-930LPCH CRIMP HEAD AND CT-902HP 5K PUMP
 △ CRIMPS WITH 1 AWG F87-18 FERRULES USING CD-2001-F87 OR CD-920-F87 DIES REQUIRE DOUBLE 180° CRIMP

NOTES:

- USED FOR:
 - UL LISTED WITH STRANDED COPPER WIRE 20 - 1/0 AWG ONLY
 - 302°F [150°C] MAX. OPERATING TEMPERATURE
- MATERIAL:
 - STAMPING: COPPER, TIN PLATED
- SEE www.panduit.com FOR PACKAGE QUANTITIES
- DIMENSIONS IN BRACKETS ARE METRIC EQUIVALENT
- FOR TOLERANCING REFER TO DIN 46228 PART 1

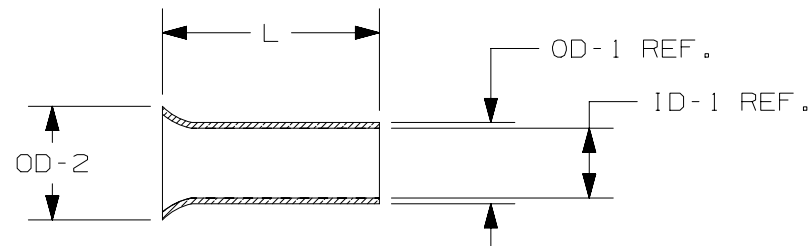

| PANDUIT PART # | WIRE RANGE | | WIRE STRIP LENGTH +1/32 -0 [+0,8 -0] | WIRE CLASS | DIMENSIONS in. [mm] | | | | INSTALLATION TOOLS/DIES |
|----------------|--------------|--------------------|--|--------------------|---------------------|--------------|-----------------|-------------|---|
| | AWG | [mm ²] | | | L | ID-1 (REF.) | OD-1 (REF.) | OD-2 | |
| F87-18 | 1-1/0 | [50] | 23/32 [18,0] | G, H, DLO, I, K, M | 0.71 [18,0] | 0.41 [10,3] | 0.43 [10,9] | 0.51 [13,0] | CT-1006 **CD-2001-F87 @CD-920-F87 |
| F87-22 | | | 7/8 [22,0] | | 0.87 [22,0] | 0.41 [10,3] | 0.43 [10,9] | 0.51 [13,0] | |
| F87-25 | | | 31/32 [25,0] | | 0.98 [25,0] | 0.41 [10,3] | 0.43 [10,9] | 0.51 [13,0] | |
| F87-32 | | | 1 1/4 [32,0] | | 1.26 [32,0] | 0.41 [10,3] | 0.43 [10,9] | 0.51 [13,0] | |
| * F89-25 | | | 2/0 | | [70] | 31/32 [25,0] | H, DLO, I, K, M | 0.98 [25,0] | |
| * F89-32 | 1 1/4 [32,0] | 1.26 [32,0] | | 0.49 [12,5] | | 0.52 [13,3] | | 0.59 [15,0] | |
| * F90-25 | 3/0 | [95] | 31/32 [25,0] | H, DLO, I, K, M | 0.98 [25,0] | 0.57 [14,5] | 0.60 [15,3] | 0.67 [17,0] | **CD-2001-F90 @CD-920-F90 |
| * F90-30 | | | 1 3/16 [30,0] | | 1.18 [30,0] | 0.57 [14,5] | 0.60 [15,3] | 0.67 [17,0] | |
| * F90-32 | | | 1 1/4 [32,0] | | 1.26 [32,0] | 0.57 [14,5] | 0.60 [15,3] | 0.67 [17,0] | |
| * F91-32 | 4/0-250 | [120] | 1 1/4 [32,0] | H, DLO, I, K, M | 1.26 [32,0] | 0.65 [16,5] | 0.69 [17,5] | 0.75 [19,0] | **CD-2001-F91 @CD-920-F91 |
| * F91-40 | | | 1 19/32 [40,0] | | 1.57 [40,0] | 0.65 [16,5] | 0.69 [17,5] | 0.75 [19,0] | |
| * F92-32 | 300 | [150] | 1 1/4 [32,0] | H, DLO, I, K, M | 1.26 [32,0] | 0.73 [18,5] | 0.77 [19,5] | 0.83 [21,0] | **CD-2001-F92 @CD-920-F92 |
| * F92-38 | | | 1 1/2 [38,0] | | 1.50 [38,0] | 0.73 [18,5] | 0.77 [19,5] | 0.83 [21,0] | |
| * F93-32 | 350 | [185] | 1 1/4 [32,0] | H, DLO, I, K, M | 1.26 [32,0] | 0.79 [20,0] | 0.83 [21,2] | 0.93 [23,5] | **CD-2001-F93 @CD-920-F93 |
| * F93-40 | | | 1 19/32 [40,0] | | 1.57 [40,0] | 0.79 [20,0] | 0.83 [21,2] | 0.93 [23,5] | |
| * F94-40 | 400 | [203] | 1 19/32 [40,0] | H, DLO, I, K, M | 1.57 [40,0] | 0.90 [22,8] | 0.94 [24,0] | 1.02 [25,8] | **CD-2001-F94 @CD-920-F94 |



| | | | | | | | |
|---|---------|-----|--------|--|--|--|--|
| TITLE | | | | FERRULES - BARE, NO SLEEVE SHEET 2 OF 2 CUSTOMER DRAWING | | | |
| ITEM REVISION NAME | | | | N41670BA/22 | | | |
| DATASET FILE NAME | | | | N41670BA_DC/22 | | | |
| UNLESS OTHERWISE SPECIFIED, DIMENSIONAL TOLERANCES ARE: IN [mm] | | | | MATERIAL: | | | |
| .X ± | | | | .XXX ± | | | |
| .XX ± | | | | ANGLES ± | | | |
| THIRD ANGLE PROJECTION | | | | DRAWING NUMBER: | | | |
| A41670 | | | | SHT 2 OF 2 | | | |
| DRAWN BY | DATE | CHK | SCALE | SIZE | | | |
| JKD | 2/10/99 | SKB | N.T.S. | B | | | |