

## 12 Right-Angle Outlet Vertical Power Strip, 120V, 15A, 15 ft. (4.57 m) Cord, 5-15P, 36 in.

MODEL NUMBER: PS3612RA

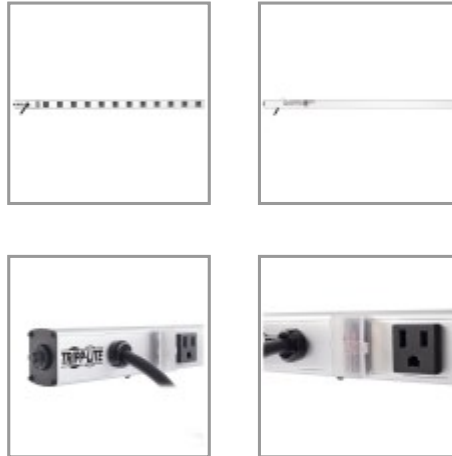

### Highlights

- 12 right-angle receptacles
- Convenient and safe covered, on/off switch
- 15-amp circuit breaker
- 15-ft. cord with right angle plug
- 36-in. length

### Package Includes

- PS3612RA Power Strip
- Mounting hardware
- Instruction manual

### Features

- Sturdy all-metal 36-inch corded strip format with 2.638 inch center-to-center outlet spacing
- Includes 12 right-angle NEMA 5-15R receptacles
- Ideal for horizontal or vertical raceway style power distribution in office, workbench, industrial, networking and telecom applications
- Lighted power switch with locking transparent cover prevents accidental shutoff
- 15 amp electrical capacity with circuit breaker
- 120V AC, 50/60Hz electrical compatibility

## Specifications

OVERVIEW	
UPC Code	037332187468
INPUT	
Nominal Input Voltage(s) Supported	120V AC
Recommended Electrical Service	15A 120V
Input Cord Gauge Type	14 gauge; SJT
Voltage Compatibility (VAC)	120
Input Plug Type	NEMA 5-15P
Input Cord Length (ft.)	15
Right-Angle Plug	No

Input Cord Length (m)	4.57
Integrated Cord Clip	No
<b>OUTPUT</b>	
Frequency Compatibility	50 / 60 Hz
Output Receptacles	(12) 5-15R
Circuit Breaker (amps)	15
Transformer Accommodation	(12) Yes
Right-Angle Outlets	Yes
Outlet Spacing	2.638 in.
<b>USER INTERFACE, ALERTS &amp; CONTROLS</b>	
Switches	Lighted 2 position switch controls power to all outlets
Locking Switch Cover	Transparent on/off switch cover prevents accidental turn-off
<b>PHYSICAL</b>	
Color	Silver
Material of Construction	Aluminum
Power Cord Color	Black
Form Factors Supported	Supports horizontal or vertical raceway style power distribution in office, workbench, industrial, networking and telecom applications
Housing Color	Silver
Included Mounting Accessories	Includes mounting clips
Mounting Holes or Slots	No
Outlets Measurement (Center to Center)	67mm
Receptacle Color	Black
Shipping Dimensions (hwd / in.)	2.40 x 4.60 x 40.00
Shipping Dimensions (hwd / cm)	6.10 x 11.68 x 101.60
Shipping Weight (lbs.)	4.00
Shipping Weight (kg)	1.81
Unit Dimensions (hwd / in.)	1.250 x 1.500 x 36.000
Unit Dimensions (hwd / cm)	3.18 x 3.81 x 91.44
Unit Weight (lbs.)	3.23
Unit Weight (kg)	1.47
<b>FEATURES &amp; SPECIFICATIONS</b>	
Antimicrobial	No

# TRIPP-LITE

by **EAT•N**

1000 Eaton Boulevard  
Cleveland, OH 44122  
United States

Built-In Circuit Breaker	Yes
<b>STANDARDS &amp; COMPLIANCE</b>	
Product Certifications	cUL Listed; UL 1363; UL Listed
Product Compliance	RoHS
<b>WARRANTY &amp; SUPPORT</b>	
Product Warranty Period (Worldwide)	Lifetime limited warranty

# TRIPP-LITE

by **EAT•N**

© 2022 Eaton. All Rights Reserved.  
Eaton is a registered trademark. All other trademarks  
are the property of their respective owners.