

CTSPI2D10F Series

From 0.33µH to 47µH



SPECIFICATIONS

Please specify tolerance code when ordering.
CTSPI2D10F-R33 ← M = ±20%, N = ±30%

Part Number	Inductance (µH)	Tolerance (±%)	DCR Typ. (Ω)	IDC Typ. (mA)	I _{rms} Typ. (mA)	Color Coding
CTSPI2D10F-R33_	0.33	20, 30	0.030	1800	2800	Orange
CTSPI2D10F-R68_	0.68	20, 30	0.055	1100	2000	White
CTSPI2D10F-1R0_	1.0	20, 30	0.065	1100	1800	Gray
CTSPI2D10F-1R2_	1.2	20, 30	0.078	1000	1500	Black
CTSPI2D10F-1R5_	1.5	20, 30	0.087	1000	1400	Brown
CTSPI2D10F-1R8_	1.8	20, 30	0.097	900	1350	Red
CTSPI2D10F-2R2_	2.2	20, 30	0.106	860	1250	Orange
CTSPI2D10F-2R7_	2.7	20, 30	0.127	760	1100	Yellow
CTSPI2D10F-3R3_	3.3	20, 30	0.175	680	1000	Green
CTSPI2D10F-3R9_	3.9	20, 30	0.200	620	900	Blue
CTSPI2D10F-4R7_	4.7	20, 30	0.274	600	850	Violet
CTSPI2D10F-5R6_	5.6	20, 30	0.319	540	750	Gray
CTSPI2D10F-6R8_	6.8	20, 30	0.330	460	700	White
CTSPI2D10F-8R2_	8.2	20, 30	0.380	440	650	Black
CTSPI2D10F-100M	10	20	0.400	420	600	Brown
CTSPI2D10F-120M	12	20	0.675	320	550	Red
CTSPI2D10F-150M	15	20	0.800	300	500	Orange
CTSPI2D10F-180M	18	20	0.890	300	450	Yellow
CTSPI2D10F-220M	22	20	1.100	260	400	Green
CTSPI2D10F-330M	33	20	1.600	220	340	Blue
CTSPI2D10F-470M	47	20	2.430	180	240	Black

PHYSICAL DIMENSIONS

Size	A	B	C	D	E
mm	3.2±0.2	3.2±0.2	1.05	1.1	0.8
inches	0.126±0.008	0.126±0.008	0.041	0.043	0.031

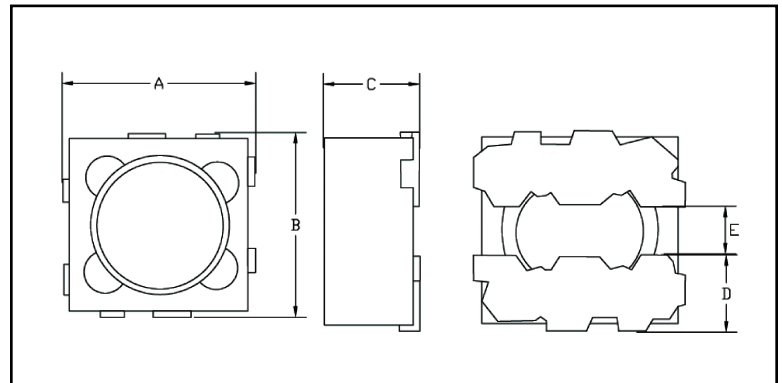

CHARACTERISTICS

Description: SMD Shielded Power Inductors (low profile)

Applications: Cellular phones, PDAs, DVC, DSC, digital cameras, and hard disk drives

Operating Temperature: -40°C to +105°C

Testing: Inductance is tested on an HP4284A at 1KHz/1.0V

IDC: For inductance 10% or 35% from its value without current

I_{rms}: For a 25°C or 40°C rise above 25°C ambient

Packaging: Tape & Reel.

Additional Information: Additional electrical & physical information available upon request.

Samples available. See website for ordering information.

PAD LAYOUT

