

# 深圳市昱申科技有限公司

## CHINA YOUNG SUN LED TECHNOLOGY CO., LTD.

TEL: (86) 755-28079401 28079402 28079403 28079404 28079405  
 FAX: (86) 755-28079407 E-mail: info@100LED.com Web: www.100LED.com

### Model No.: YSM-2388CRGBC

### 8mm Pitch RED/GREEN/BLUE Tripple Color Dot Matrix

Applications:

- ☐ Moving Message Display
- ☐ Full Color Display
- ☐ Banking Board
- ☐ Score Boards
- ☐ Digital Display



### LED Chip Absolute Maximum Ratings: (Ta=25°C)

Parameter	Symbol	Red	Green	Blue	Unit
Forward current	I <sub>F</sub>	20	20	20	mA
Peak forward current (Duty Cycle=1/10, 10KHz)	I <sub>PF</sub>	30	30	30	mA
Reverse voltage (V <sub>R</sub> =5V)	I <sub>R</sub>	10	10	10	μA
Operating temp	T <sub>OPR</sub>	-25 - 85	-25 - 85	-25 - 85	°C
Storage temp	T <sub>STG</sub>	-30-85	-30-85	-30-85	°C
Spectral Line half-width	λ P <sub>H</sub>	20	30	30	nm

\* Soldering Bath: not more than 5 seconds @260°C. The bottom ends of the plastic reflector should be at least 2mm above the solder surface  
 Soldering Iron: not more than 3 seconds @300°C under 30W

### LED Chip Typical Electircal & Optical Characteristics: (Ta=25°C)

ITEMS	Color	Symbol	Condition	Min.	Typ.	Max.	Unit
Forward Voltage	Red	V <sub>F</sub>	I <sub>F</sub> =20mA	1.9	2.0	2.2	V
	Green			3.2	3.3	3.5	
	Blue			3.2	3.3	3.5	
Luminous Intensity	Red	I <sub>v</sub>	I <sub>F</sub> =20mA	120	150	160	mcd
	Green			250	300	330	
	Blue			180	200	250	
Wavelength	Red	Δ λ	I <sub>F</sub> =20mA	620	---	625	nm
	Green			515	---	517.5	
	Blue			465	---	467.5	
Light Degradation after 1000 hours	Red	-4.68% ~ -8.27%					
	Green	-11.37% ~ -15.30%					
	Blue	-12.47% ~ -16.81%					

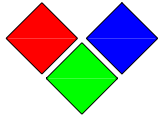

# 深圳市昱申科技有限公司

## CHINA YOUNG SUN LED TECHNOLOGY CO., LTD.

TEL: (86) 755-28079401 28079402 28079403 28079404 28079405  
 FAX: (86) 755-28079407 E-mail: info@100LED.com Web: www.100LED.com

### Mechanical Dimensions:

- All dimension are in mm, tolerance is  $\pm 0.2\text{mm}$  unless otherwise noted
- An epoxy meniscus may extend about 1.5mm down the leads.

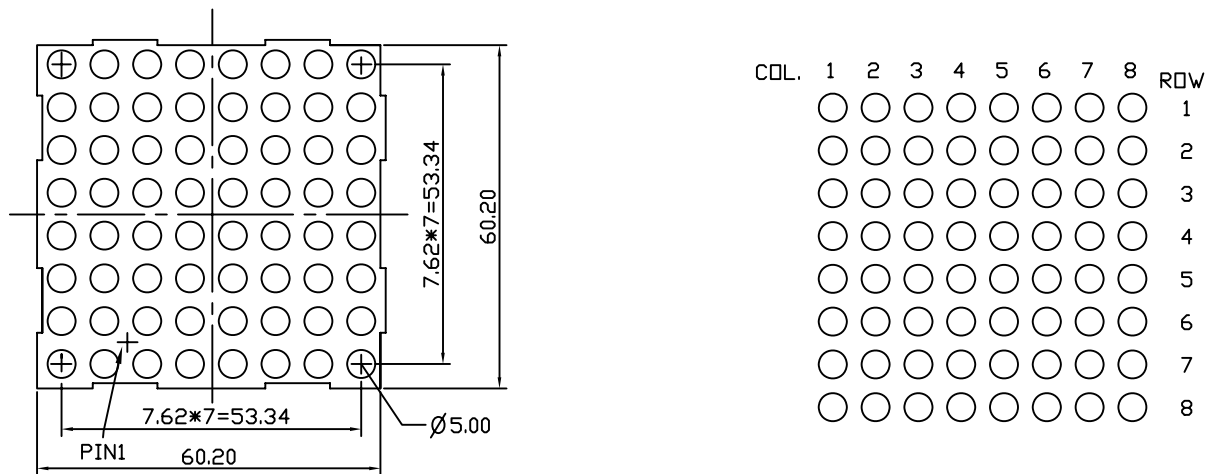

COL.	1	2	3	4	5	6	7	8	ROW
	○	○	○	○	○	○	○	○	1
	○	○	○	○	○	○	○	○	2
	○	○	○	○	○	○	○	○	3
	○	○	○	○	○	○	○	○	4
	○	○	○	○	○	○	○	○	5
	○	○	○	○	○	○	○	○	6
	○	○	○	○	○	○	○	○	7
	○	○	○	○	○	○	○	○	8

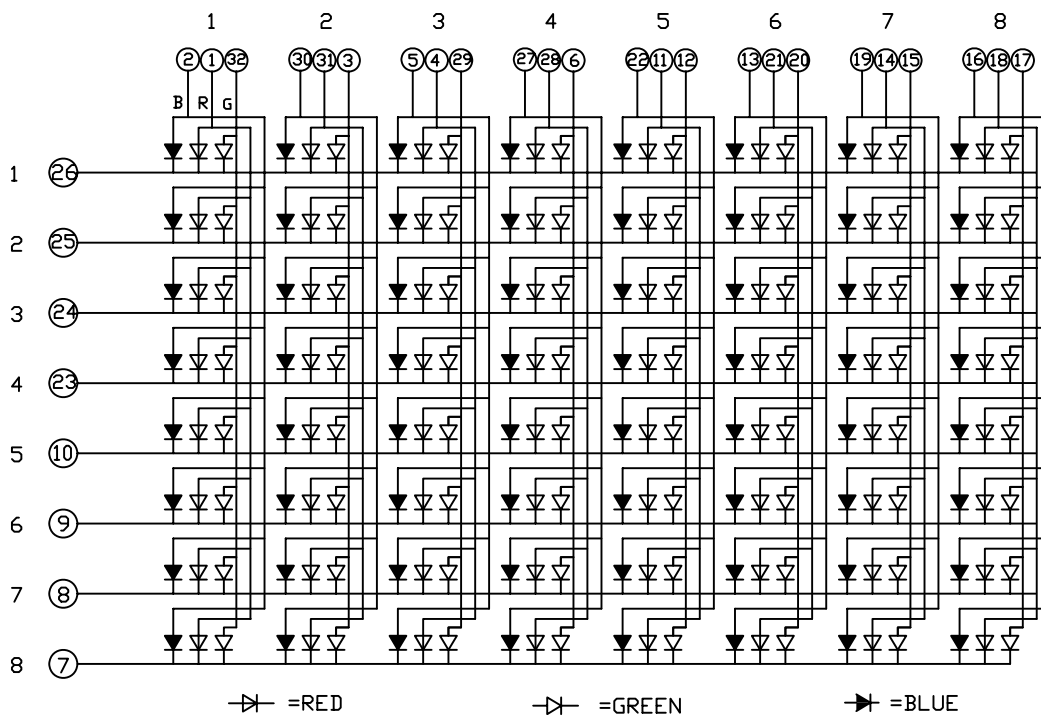
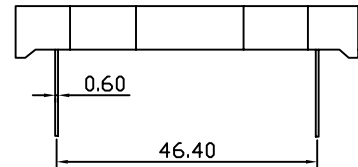
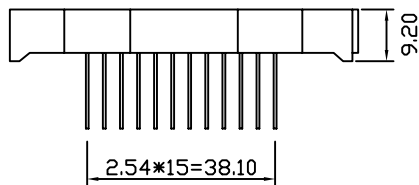

Unit: mm

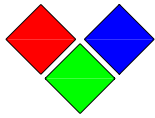

深圳市昱申科技有限公司

CHINA YOUNG SUN LED TECHNOLOGY CO., LTD.

TEL: (86) 755-28079401 28079402 28079403 28079404 28079405

FAX: (86) 755-28079407 E-mail: info@100LED.com Web: www.100LED.com

## Code System:

YSM-2388CXXC

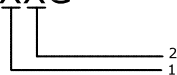

### 1. Color:

R: Red A: Amber K: Kelly Y: Yellow  
G: Green C: Cyan P: Purple W: White

### 2. Wavelength or Color Temperature Range:

R1: 610-615nm	G1: 512.5-515nm	B1: 455-457.5nm
R2: 615-620nm	G2: 517.5-520nm	B2: 457.5-460nm
R3: 620-625nm	G3: 520-522.5nm	B3: 460-462.5nm
	G4: 522.5-525nm	B4: 462.5-465nm
	G5: 525-527.5nm	B5: 465-467.5nm
	G6: 527.5-530nm	B6: 467.5-470nm
	G7: 530-532.5nm	B7: 470-472.5nm
	G8: 532.5-535nm	B8: 472.5-475nm

## Warranty:

- 3 years warranty for our red, yellow, amber and kelly items based on no more than 8 hours continuously lighting per day.
- 2 years warranty for our Blue, Green, Cyan and Purple items based on no more than 8 hours continuously lighting per day.
- 1 years warranty for our Cool White, Pure White and Warm White items based on no more than 8 hours continuously lighting per day.
- Electrical & Optical Characteristics consistency of same items all shipments.

## Notes:

- Please use Dot Matrixs based on our datasheet.
- Dot Matrix is sensitive to statics, be sure your equipments are anti-static when you use our Dot Matrixs.
- Pay more attention to your heat dissipation system when you use it, the better heat dissipation, the longer Dot Matrix lifespan.