

NOTE:

- MATERIAL AND FINISH
SHELL ASSEMBLY: COPPER ALLOY, OUTER SHELL AND COLLECT NUT Cr PLATING, OTHER METALLIC COMPONENTS Ni PLATING.
INSULATOR: PEEK
CONTACT: COPPER ALLOY, GOLD PLATING OVER Ni
- DURABILITY: 5000 CYCLES
- PROTECTION INDEX(MATED): IP66/IP68, IP68 ACHIEVED PROVIDING THAT THE CABLE IS PERFECTLY CIRCULAR AND THAT ASSEMBLY PROCESS ENSURES A HIGH INTEGRITY SEAL.
- HUMIDITY: UP TO 95% AT 60°C
- TEMPERATURE: -55°C,+200°C
- ROHS COMPLIANCE.
- PART NO.:

R - F 2 K S * * 0 * C 1 * * *

CONTACT POS.
02-32=2pin-32pin

SHELL MATERIAL
0=Brass

CODE	CONTACT TYPE
2	Male Solder Contact
4	Female Solder Contact
C	Crimp Male Contact
M	Crimp Female Contact

COLLET NUT
1=Nut for fitting a bend relief

CODE	KEY ANGLES
0	0°
A	30°
*	**

CABLE OD
15=OD: 1.3mm-1.5mm
20=OD: 1.6mm-2.0mm
25=OD: 2.1mm-2.5mm
30=OD: 2.6mm-3.0mm
35=OD: 3.1mm-3.5mm
40=OD: 3.6mm-4.0mm
45=OD: 4.1mm-4.5mm
50=OD: 4.6mm-5.0mm
55=OD: 5.1mm-5.5mm
60=OD: 5.6mm-6.0mm
65=OD: 6.1mm-6.5mm
70=OD: 6.6mm-7.0mm
75=OD: 7.1mm-7.5mm
80=OD: 7.6mm-8.0mm
85=OD: 8.1mm-8.5mm

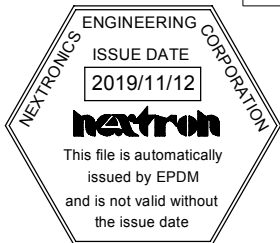
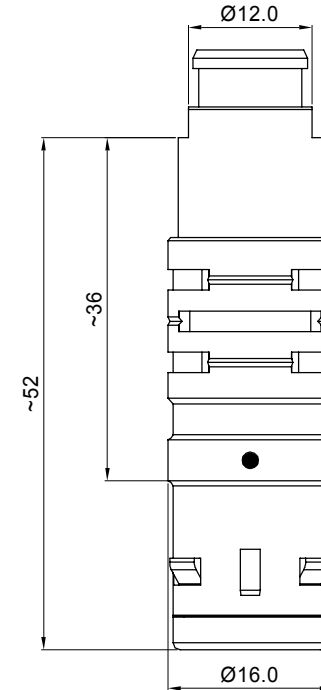

REV.	DESCRIPTION	DATE
X3	UPDATE FRAME	11/06'19
X2	ECN-160053	6/20'16

UNITS:	SIZE	NAME:
<input checked="" type="checkbox"/> mm <input type="checkbox"/> inch	A3	SNAP LATCH METAL 2K PLUG
GENERAL TOLERANCE: (UNLESS SPECIFIED)		PART NO: R-F2KS**0*C1***
	mm	inch
4 PLACE	± **	±. **
3 PLACE	± 0.1	±. **
2 PLACE	± 0.3	±. **
1 PLACE	± 0.5	±. **
ANGLES	X°±2°	
APPD: Alex梁良駒 2019/11/11		TITLE: CUSTOMER DWG.
CHKD: Ken張永 2019/11/09		DWG NO: 010-0000-C12
DRAW: Ellen孫郁婷 2019/11/06		SCALE SHEET REV.
DESIGN: Cayley梁思雅 2019/11/06		2/1 1/4 X3

NOTE:

- MATERIAL AND FINISH
SHELL ASSEMBLY: COPPER ALLOY, OUTER SHELL AND COLLECT NUT Cr PLATING, OTHER METALLIC COMPONENTS Ni PLATING.
INSULATOR: PEEK
CONTACT: COPPER ALLOY, GOLD PLATING OVER Ni
- DURABILITY: 5000 CYCLES
- PROTECTION INDEX(MATED): IP66/IP68, IP68 ACHIEVED PROVIDING THAT THE CABLE IS PERFECTLY CIRCULAR AND THAT ASSEMBLY PROCESS ENSURES A HIGH INTEGRITY SEAL.
- HUMIDITY: UP TO 95% AT 60°C
- TEMPERATURE: -55°C, +200°C
- ROHS COMPLIANCE.
- PART NO.:

R - F 2 K S * * 0 * C 2 * * *

CONTACT POS.
02-32=2pin-32pin

SHELL MATERIAL
0=Brass

CODE	CONTACT TYPE
2	Male Solder Contact
4	Female Solder Contact
C	Crimp Male Contact
M	Crimp Female Contact

COLLET NUT
2=Nut for Standard

CODE	KEY ANGLES
0	0°
A	30°
*	**

CABLE OD
15=OD: 1.3mm-1.5mm
20=OD: 1.6mm-2.0mm
25=OD: 2.1mm-2.5mm
30=OD: 2.6mm-3.0mm
35=OD: 3.1mm-3.5mm
40=OD: 3.6mm-4.0mm
45=OD: 4.1mm-4.5mm
50=OD: 4.6mm-5.0mm
55=OD: 5.1mm-5.5mm
60=OD: 5.6mm-6.0mm
65=OD: 6.1mm-6.5mm
70=OD: 6.6mm-7.0mm
75=OD: 7.1mm-7.5mm
80=OD: 7.6mm-8.0mm
85=OD: 8.1mm-8.5mm

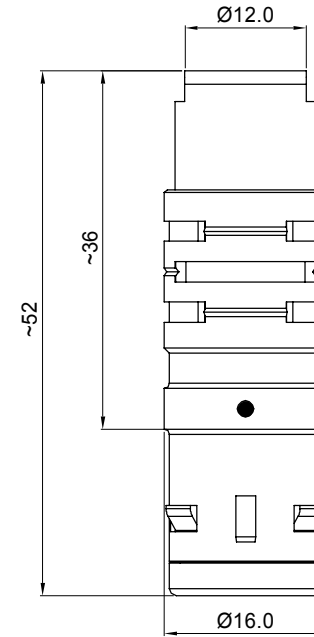

REV.	DESCRIPTION	DATE
X3	UPDATE FRAME	11/06'19
X2	ECN-160053	6/20'16

UNITS:	SIZE	NAME:	nexttron® NEXTRONICS ENGINEERING CORP.
■ mm □ inch	A3	SNAP LATCH METAL 2K PLUG	
GENERAL TOLERANCE: (UNLESS SPECIFIED)		PART NO: R-F2KS**0*C2***	TITLE: CUSTOMER DWG.
4 PLACE	± **	inch ± **	DWG NO: 010-0000-C12
3 PLACE	± 0.1	inch ± **	
2 PLACE	± 0.3	inch ± **	SCALE SHEET REV. 2/1 2/4 X3
1 PLACE	± 0.5	inch ± **	
ANGLES	X° ± 2°	APPD: Alex梁良駒 2019/11/11 CHKD: Ken張永 2019/11/09 DRAW: Ellen孫郁婷 2019/11/06 DESIGN: Cayley梁思雅 2019/11/06	C

CONFIDENTIAL: THIS DOCUMENT CONTAINED THE INFORMATION IS PROPRIETARY AND CONFIDENTIAL TO Nexttronics Engineering Corp. NO PERSON IS ALLOWED TO USE COPY, PUBLISH OR OTHERWISE DISCLOSE THE INFORMATION TO OTHERS, UNLESS BY THE PRIOR WRITTEN EXPRESS AUTHORIZATION OF Nexttronics Engineering Corp. (C)COPYRIGHT- Nexttronics Engineering Corp.

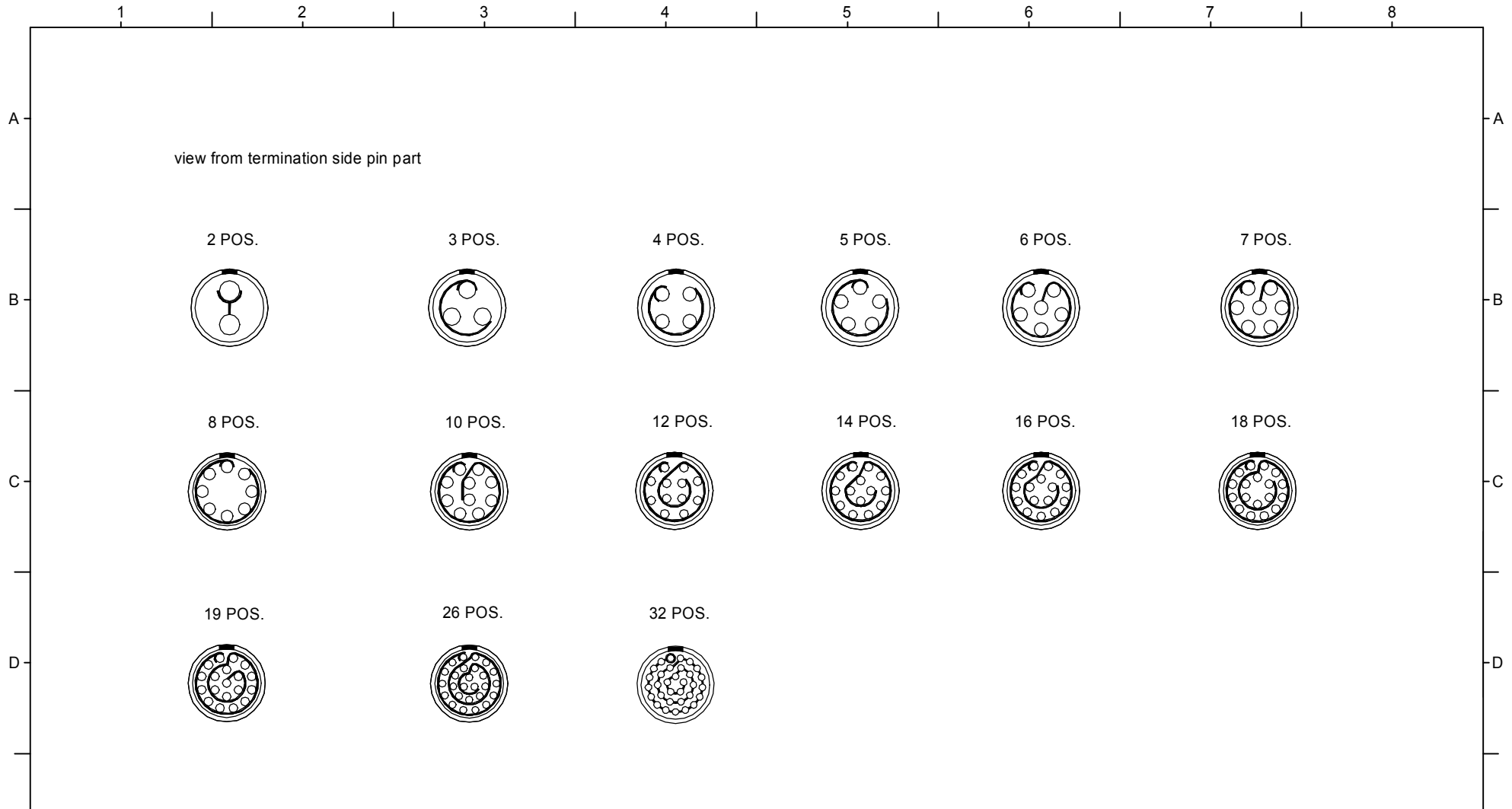

X3	UPDATE FRAME	11/06'19
X2	ECN-160053	6/20'16
REV.	DESCRIPTION	DATE

UNITS: ■ mm □ inch	SIZE A3	NAME: SNAP LATCH METAL 2K PLUG	 NEXTRONICS ENGINEERING CORP.								
GENERAL TOLERANCE: (UNLESS SPECIFIED)		PART NO: R-F2KS****C****				TITLE: CUSTOMER DWG.					
4 PLACE	± **	±. **	APPD: Alex梁良駒	2019/11/11	DWG NO: 010-0000-C12	C					
3 PLACE	± 0.1	±. **	CHKD: Ken張永	2019/11/09							
2 PLACE	± 0.3	±. **	DRAW: Ellen孫郁婷	2019/11/06	<table border="1"> <tr> <td>SCALE</td> <td>SHEET</td> <td>REV.</td> </tr> <tr> <td>2/1</td> <td>3/4</td> <td>X3</td> </tr> </table>	SCALE	SHEET	REV.	2/1	3/4	X3
SCALE	SHEET	REV.									
2/1	3/4	X3									
1 PLACE	± 0.5	±. **	DESIGN: Cayley梁思雅	2019/11/06							
ANGLES	X° ± 2°										

CONFIDENTIAL: THIS DOCUMENT CONTAINED THE INFORMATION IS PROPRIETARY AND CONFIDENTIAL TO Nextronics Engineering Corp. NO PERSON IS ALLOWED TO USE COPY, PUBLISH OR OTHERWISE DISCLOSE THE INFORMATION TO OTHERS, UNLESS BY THE PRIOR WRITTEN EXPRESS AUTHORIZATION OF Nextronics Engineering Corp. (C)COPYRIGHT- Nextronics Engineering Corp.

KEY ANGLES (PLUG FRONT VIEW):

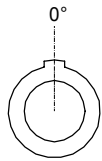

0

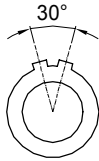

A



D



B

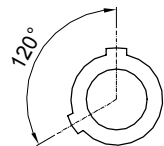

K

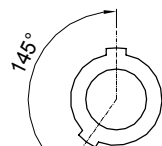

U

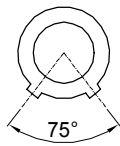

H

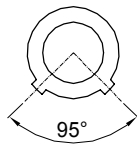

C



X3	UPDATE FRAME	11/06'19
X2	ECN-160053	6/20'16
REV.	DESCRIPTION	DATE

UNITS: ■ mm □ inch	SIZE A3	NAME: SNAP LATCH METAL 2K PLUG	nexttron NEXTTRONICS ENGINEERING CORP.		
GENERAL TOLERANCE: (UNLESS SPECIFIED)		PART NO: R-F2KS****C****	TITLE: CUSTOMER DWG.		
4 PLACE	mm ± **	inch ±. **	APPD: Alex梁良駒	2019/11/11	DWG NO: 010-0000-C12
3 PLACE	± 0.1	±. **	CHKD: Ken張永	2019/11/09	
2 PLACE	± 0.3	±. **	DRAW: Ellen孫郁婷	2019/11/06	SCALE SHEET REV. 2/1 4/4 X3
1 PLACE	± 0.5	±. **	DESIGN: Cayley梁思雅	2019/11/06	
ANGLES	X° ± 2°				

CONFIDENTIAL: THIS DOCUMENT CONTAINED THE INFORMATION IS PROPRIETARY AND CONFIDENTIAL TO Nexttronics Engineering Corp. NO PERSON IS ALLOWED TO USE COPY, PUBLISH OR OTHERWISE DISCLOSE THE INFORMATION TO OTHERS, UNLESS BY THE PRIOR WRITTEN EXPRESS AUTHORIZATION OF Nexttronics Engineering Corp. (C)COPYRIGHT- Nexttronics Engineering Corp.