

# Engineering Sample Specifications

**CUSTOMER** : Philips Lighting  
**DESCRIPTION** : LED Cooling Module  
**DIMENSIONS** :  $\varnothing 86 \times 52.4$  mm  
**MODEL** : TA004-10003  
**P/N** :

<b>ENGINEER</b>	<b>Hour Alankuo</b>	<b>APPROVAL</b>	<b>Terry</b>
<b>SSR NO.</b>	<b>S1001199-0</b>	<b>IS SUE DATE</b>	<b>11. 18. 2010</b>
建準電機工業股份有限公司 SUNONWEALTH ELECTRIC MACHINE INDUSTRY CO., LTD TEL:886-7-7163069(41 LINES) FAX:886-7-7163086/87/88 WEB PAGE : <a href="http://www.sunon.com.tw">http : //www.sunon.com.tw</a>			

## 1. Construction

<b>MOTOR DESIGN</b>	DC Brushless motor design
<b>BEARING SYSTEM</b>	Vapo bearing system
<b>DIMENSIONS</b>	See Page 3
<b>MATERIALS OF HOUSING</b>	Thermoplastic PBT of UL 94V-0
<b>MATERIALS OF FAN BLADE</b>	Thermoplastic PBT of UL 94V-0
<b>DIRECTION OF ROTATION</b>	Counter-clockwise viewed from front of fan blade
<b>Tolerance</b>	±20% on rated power and current.
<b>WEIGHT</b>	232 g

## 2. Rating

<b>RATED VOLTAGE</b>	12 VDC
<b>STARTING VOLTAGE</b>	6.5 VDC (25 deg. C POWER ON/OFF)
<b>OPERATING VOLTAGE RANGE</b>	6.5-13.8 VDC
<b>RATED CURRENT</b>	34 mA
<b>RATED POWER CONSUMPTION</b>	0.41 WATTS
<b>ACOUSTIC NOISE</b>	16.6 dB(A) @1M
<b>RATED SPEED</b>	2200 RPM ± 10% (Fan+Sink)
<b>OPERATING TEMPERATURE RANGE</b>	-10 to + 70 deg.C
<b>STORAGE TEMPERATURE RANGE</b>	-40 to + 70 deg.C
<b>THERMAL RESISTANCE</b>	0.52 °C/Watts

### 3. Dimensions

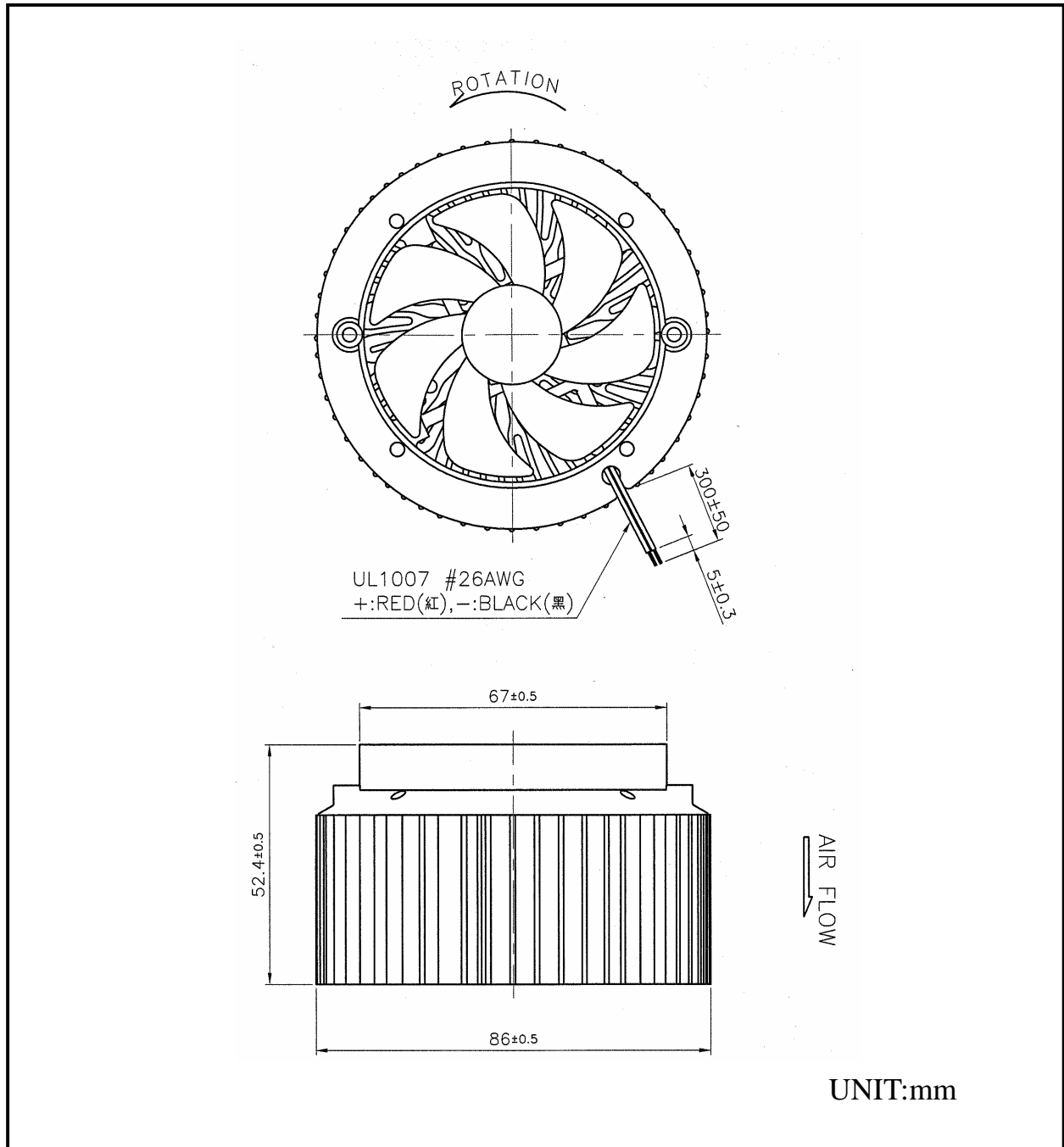

# 3-1. Dimensions

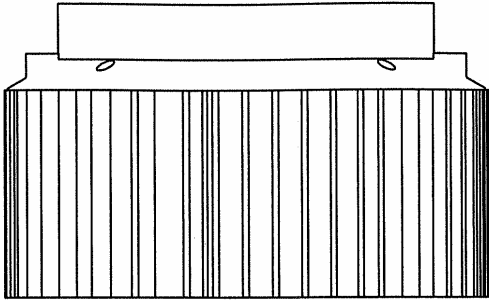

↑  
LED Module

Assembly direction of customer's LED Module

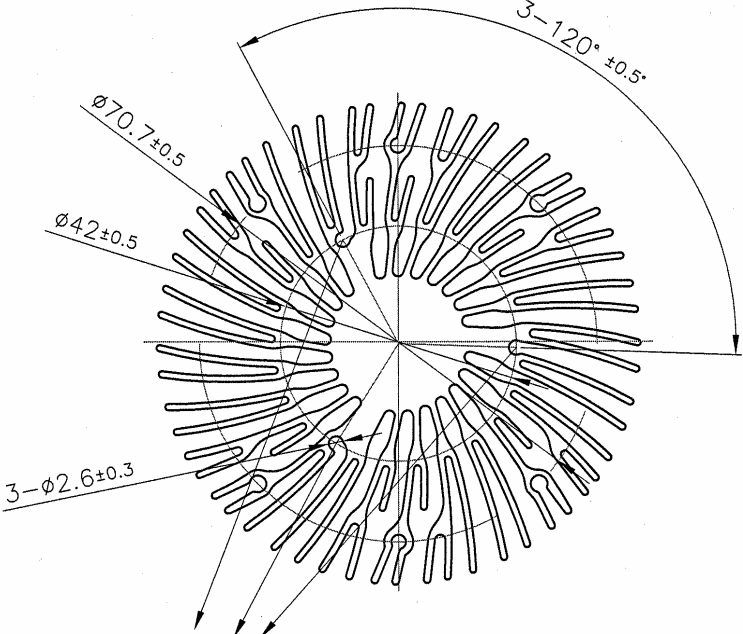

Screw torque max 16kgf.cm  
Using M3\*10mm Tapping Screw

UNIT:mm