

Silicon Power Rectifier

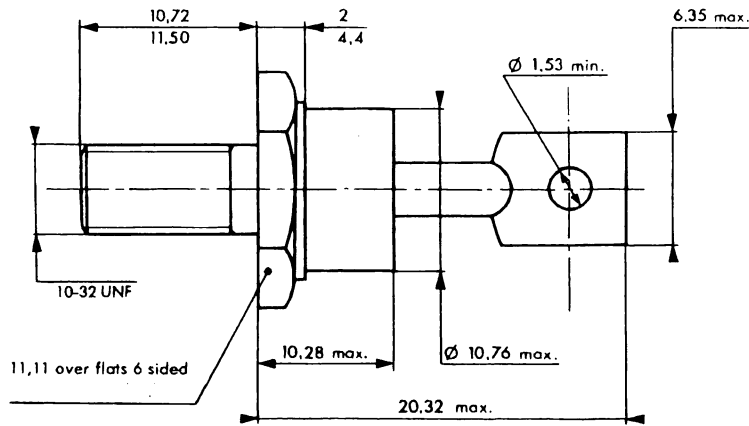

Marking : Cathode connected to case : type number
 Anode connected to case : type number + suffix R
 Weight : 5.1g
 Recommended torque value : 180cm. N
 Maximum torque value : 220cm. N

D04

		JEDEC Numbers	Peak Reverse Voltage	
1N1064	1N1341, A,B	1N1581	1N1612,A	1N2228,A
1N1065	1N1342, A,B	1N1582	1N1613,A	1N2491
1N1066	1N1343, A,B			1N2492
1N1067	1N1344, A,B	1N1583	1N1614,A	1N2493
1N1068	1N1345, A,B	1N1584		1N2230,A
1N1069	1N1346, A,B	1N1585	1N1615,A	1N2232,A
	1N1347, A,B	1N1586		1N2494
	1N1348, A,B	1N1587	1N1616,A	1N2495
				500V
				600V
				800V
				1000V
				1200V

For 1N types add an R suffix for Reverse Polarity

- Low Forward Voltage
- 200A Surge Rating
- Glass to metal seal construction
- V_{RRM} to 1200V

Electrical Characteristics

Average forward current	$I_F(AV)$ 16 Amps	$T_C = 153^\circ C$, half sine wave, $R_{\theta JC} = 2.5^\circ C/W$
Maximum surge current	I_{FSM} 200 Amps	8.3ms, half sine, $T_J = 200^\circ C$
Max $I^2 t$ for fusing	$I^2 t$ 165 $A^2 s$	
Max peak forward voltage	V_{FM} 1.3 Volts	$I_{FM} = 30A; T_J = 25^\circ C^*$
Max peak reverse current	I_{RM} 10 μA	$V_{RRM}, T_J = 25^\circ C$
Max peak reverse current	I_{RM} 1.0 mA	$V_{RRM}, T_J = 150^\circ C$
Max Recommended Operating Frequency	10kHz	

*Pulse test: Pulse width 300 μsec . Duty cycle 2%

Thermal and Mechanical Characteristics

Storage temperature range	T_{STG}	$-65^\circ C$ to $200^\circ C$
Operating junction temp range	T_J	$-65^\circ C$ to $200^\circ C$
Maximum thermal resistance	$R_{\theta JC}$	$2.5^\circ C/W$ Junction to Case
Mounting torque		25-30 inch pounds
Weight		.16 ounces (5.0 grams) typical



SOLID STATE INC.

46 FARRAND STREET
 BLOOMFIELD, NEW JERSEY 07003

www.solidstateinc.com

Figure 1
Typical Forward Characteristics

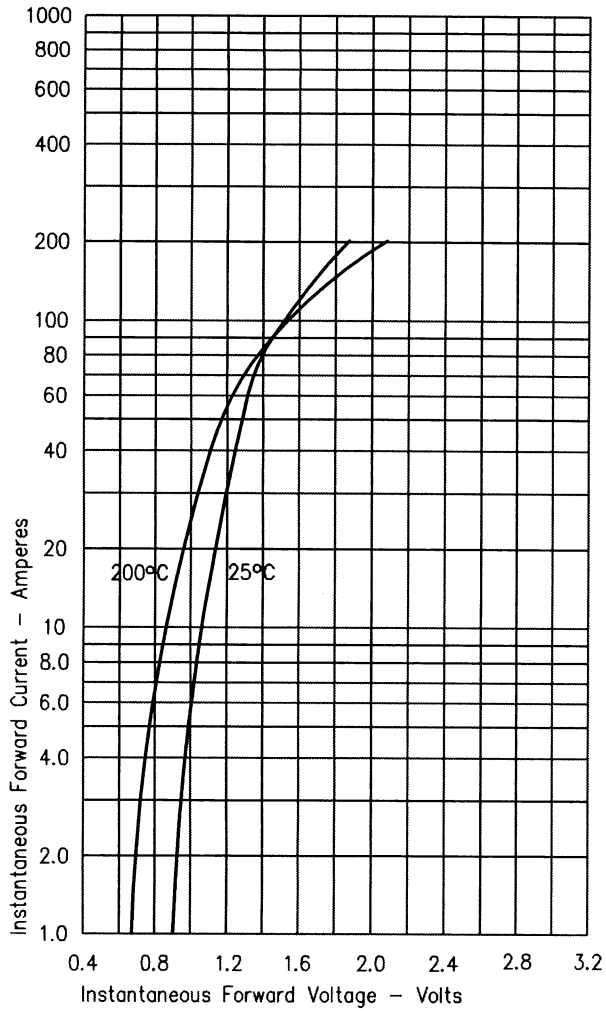

Figure 3
Forward Current Derating

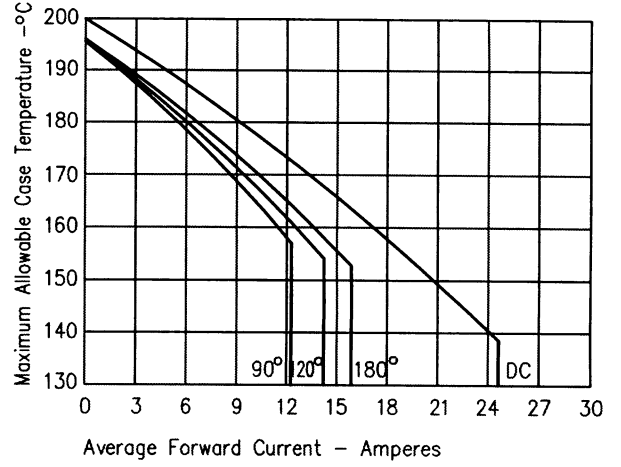

Figure 4
Maximum Forward Power Dissipation

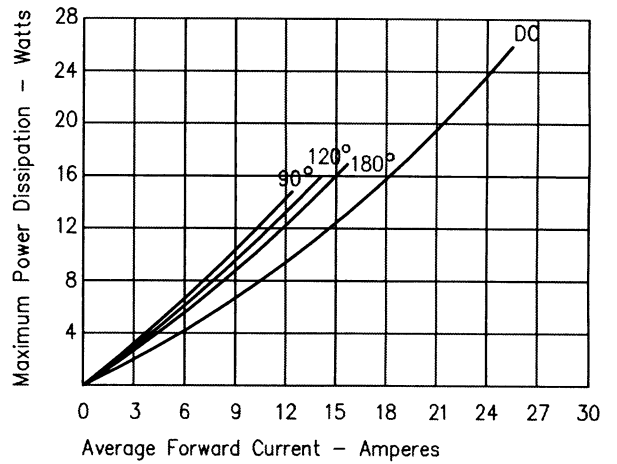

Figure 2
Typical Reverse Characteristics

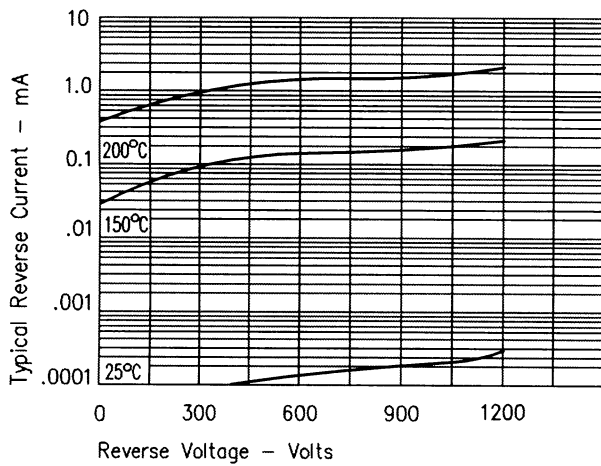

Figure 5
Transient Thermal Impedance

