

order number	lens name	f-stop
0009-194-000-40	Macro-CCD-Lens -4x	5.2

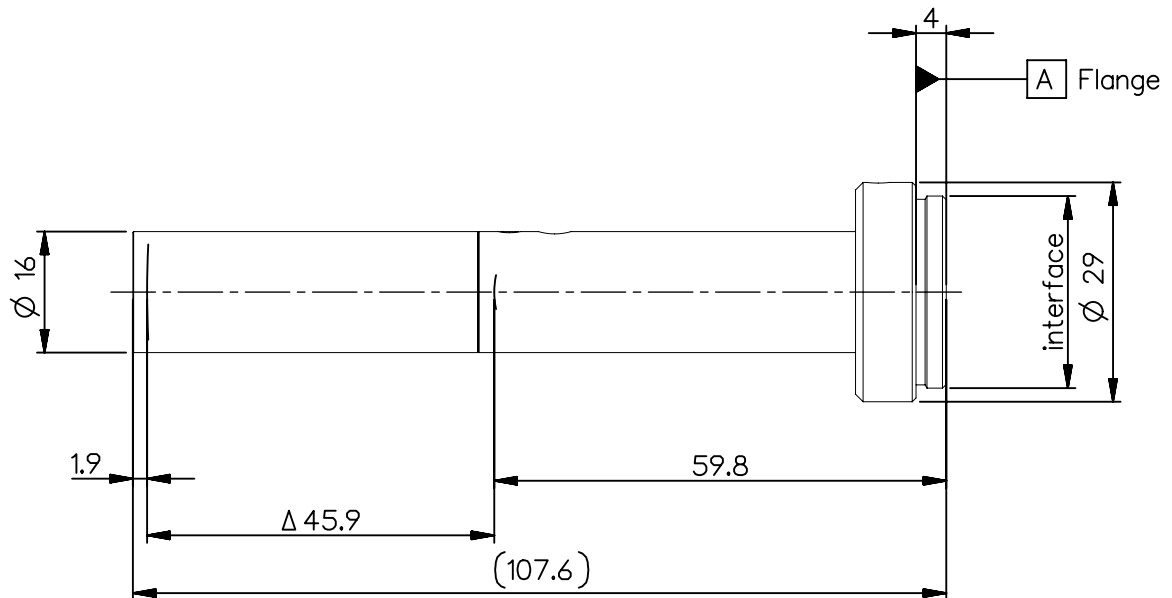

<b>Specification</b>		ON					
image circle max. (mm)	11	working distance (mm)	75				
focal length $f'$ (mm)	19.8	interface	C-mount				
magnification $\beta'$ [range]	-4	filter thread	-				
spectral range $\lambda$ (nm)	400 - 750	weight (g)	40				
schematic diagram		*) in air					
		design includes CCD cover glass:	no				
		SF (mm)	-72.0	f-stop		$\varnothing$ EnP	$\varnothing$ ExpP
		S'F' (mm) *)	-5.9				
		HH' (mm) *)	72.3				
		SH (mm)	-52.2				
		S'H' (mm) *)	-25.8				
		S'EnP (mm)					
S'ExpP (mm) *)							

<b>NX</b> PROTECTIVE NOTE "DIN ISO 16016" TO BE OBSERVED	EU-D	AL-T1A	US-D	US-ML	not export controlled			
	REV	ECC	DATE	APPROVED	PDM Status	Freigabe	-	
	a	Neuausg			SCALE	1:1		
	b	11-0358	20.07.11	Kuehne	MATERIAL			
c	14-0184	17.09.14	Schiffte	TITLE <b>Macro-CCD-Lens 4x</b>				
d	17-0915	20.03.18	Denk					
BASIC TOLERANCING PRINCIPLE								
				FIRST ISSUE	DATE	NAME		
				ISSUE	17.09.14	Schifferer		
				CHKD	17.09.14	Stauder		
<b>DIN A 4</b> ALL DIMENSIONS ARE IN MM AND INCLUDE SURFACE TREATMENT							DRAWING NO.	0009-194-100-40-0001d
							REPLACES	
							SHEET	1
							OF	1