

# TRANSISTOR MICA INSULATORS

Designers' Choice



- RAPID HEAT DISSIPATION • HIGH DIELECTRIC STRENGTH • NON-TOXIC • LOW COST • FROM STOCK

These precision stamped mica insulators provide good thermal conductivity (.009 watts per square inch per degree celsius per inch in thickness). Excellent thermal resistance 1100°F. Dielectric constant of 7 at 1000 Kilohertz.

**ORDERING INFORMATION:** Minimum quantity 100 pieces of an item.

**MATERIAL SPECIFICATIONS:** .003 thick mica is used for all the insulators on this page. Tolerance for thickness is plus or minus .001.

**Modifications:** Special thickness and other materials available on special order. Prompt quotations will be rendered.

## FOR TO-3 CASES

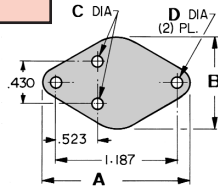
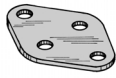

.003 THICK MICA

CAT.NO.	A	B	C	D
4651	1.625	1.093	.093	.166
4652	1.560	1.050	.203	.171
4653	1.655	1.063	.166	.166
4636	1.655	1.063	.052	.166
4644	1.655	1.063	.270	.166

## FOR TO-36 CASES

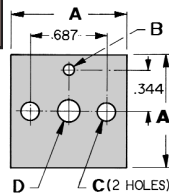

.003 THICK MICA

CAT.NO.	A	B	C	D
4655	1.125	.130	.187	.203
4656	1.250	.140	.156	.203

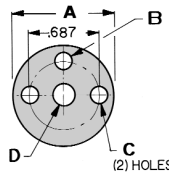
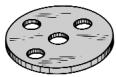

.003 THICK MICA

CAT.NO.	A	B	C	D
4657	1.062	.187	.187	.187
4659	1.187	.187	.187	.250

## FOR TRANSISTOR CASES THREADED STUD

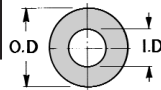

.003 THICK MICA

CAT. NO.	ID Inside Dia.	OD Outside Dia.	For Screw Size
4678	.120	.375	4
4679	.140	.375	6
4680	.171	.500	8
4681	.187	.625	10
4682	.265	.750	1/4
4683	.328	.875	5/16

## INSULATORS FOR VARIOUS TO-3 CASES

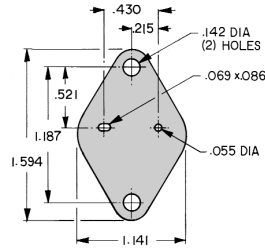

CAT. NO. 4662

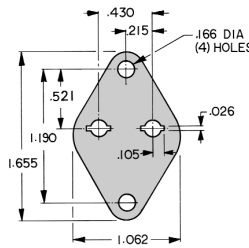

CAT. NO. 4667

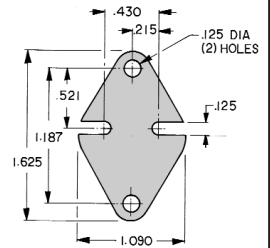

CAT. NO. 4674

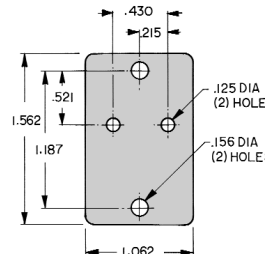

CAT. NO. 4661

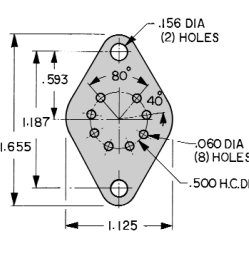

CAT. NO. 4658

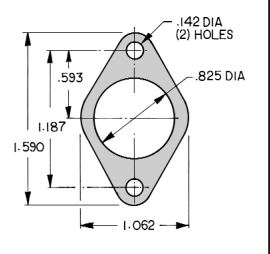

CAT. NO. 4660

## INSULATORS FOR VARIOUS TO-66 CASES

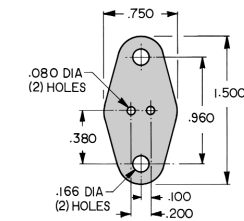

CAT. NO. 4664

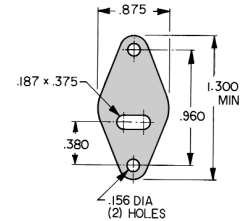

CAT. NO. 4665

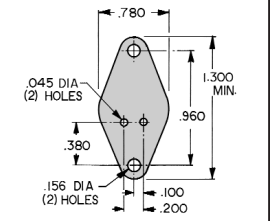

CAT. NO. 4666

## PLASTIC CASE MICA INSULATORS

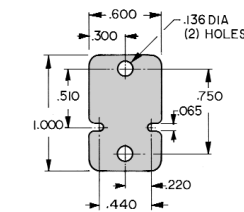

CAT. NO. 4663

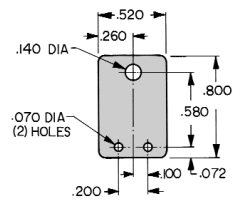

CAT. NO. 4671

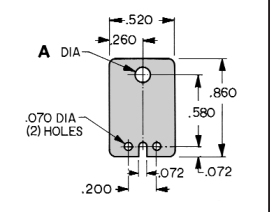

CAT. NO. 4672 .141  
CAT. NO. 4673 .115

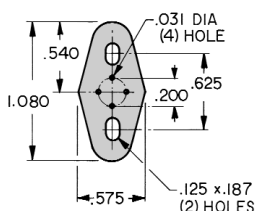

CAT. NO. 4637

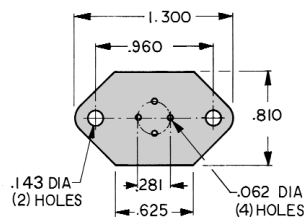

CAT. NO. 4640

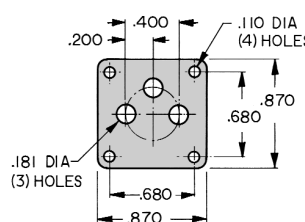

CAT. NO. 4669

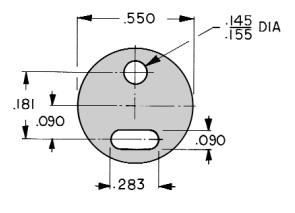

CAT. NO. 4668