

INSERT ORIENTATION

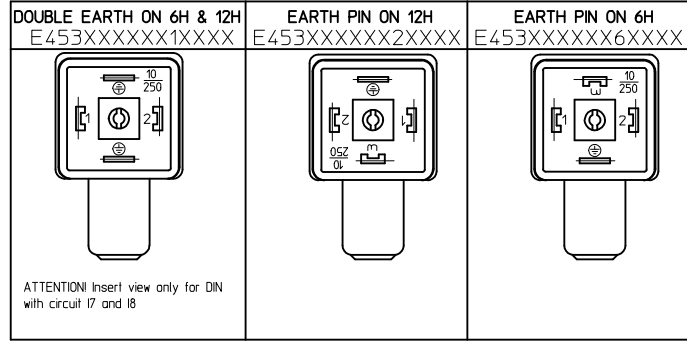
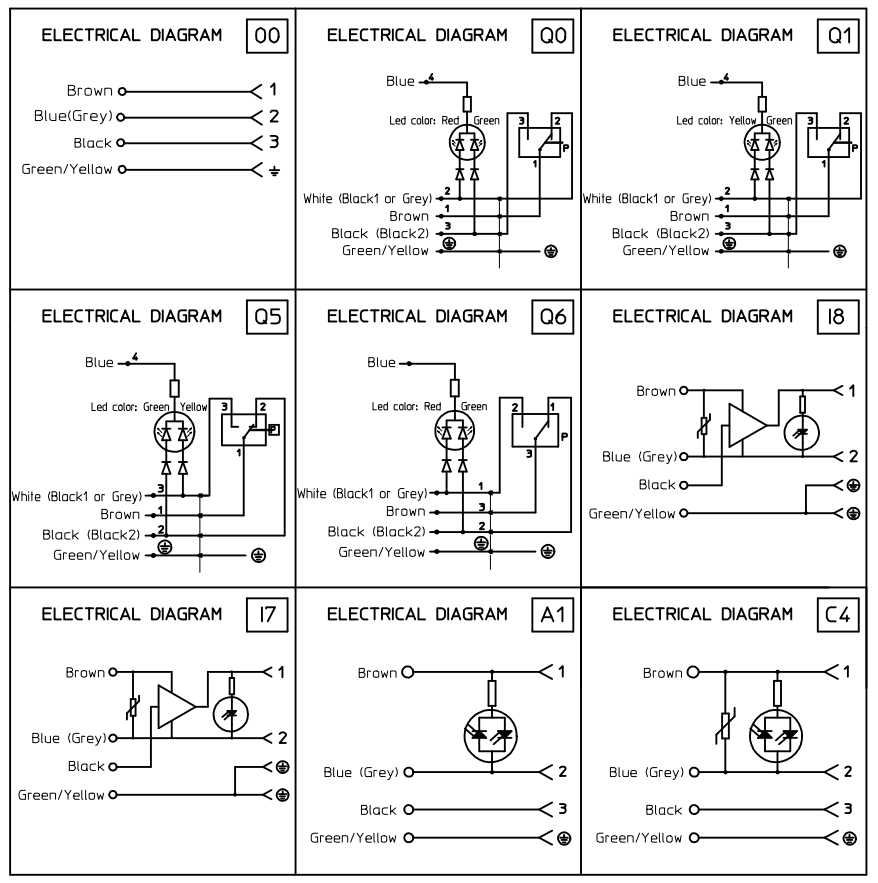

Table of length tolerances [mm]

Over	Up to and including	Tolerance (+)
0	1000	±20
1000	3000	±30
3000	5000	±40
5000	10000	±50
10000	15000	±100
15000	20000	±150
20000		±L/100

WIRING CONFIGURATION



Updated Diagram Q6 EC NO: IPG2015-2/150 DRWN: JMARSZALEK 2015/06/22 CHKD: APAM/AK01 2015/06/22 APPR: MIWASIECZKO 2015/06/24	QUALITY SYMBOLS	GENERAL TOLERANCES (UNLESS SPECIFIED)	DIMENSION STYLE	SCALE	DESIGN UNITS	THIRD ANGLE PROJECTION	
	▼=0 ▽=0	mm INCH 4 PLACES ± --- ± --- 3 PLACES ± --- ± --- 2 PLACES ± --- ± --- 1 PLACE ± --- ± --- 0 PLACE ± --- ± ---	mm INCH DRAWN BY DATE JMARSZALEK 2012/11/27 CHECKED BY DATE MSZWAJKOWSKI 2012/11/27 APPROVED BY DATE MIWASIECZKO 2014/01/30	MM ONLY MATERIAL NO.	TITLE E453XXXXXXXXXXXX DIN FORM A EN 175301-803	METRIC	molex SD-121050-006
	DRAFT WHERE APPLICABLE MUST REMAIN WITHIN DIMENSIONS	ANGULAR ± --- °	SEE SHEET 2 & 4	DOCUMENT NO.	SHEET NO. 1 OF 10		
	THIS DRAWING CONTAINS INFORMATION THAT IS PROPRIETARY TO MOLEX INCORPORATED AND SHOULD NOT BE USED WITHOUT WRITTEN PERMISSION						

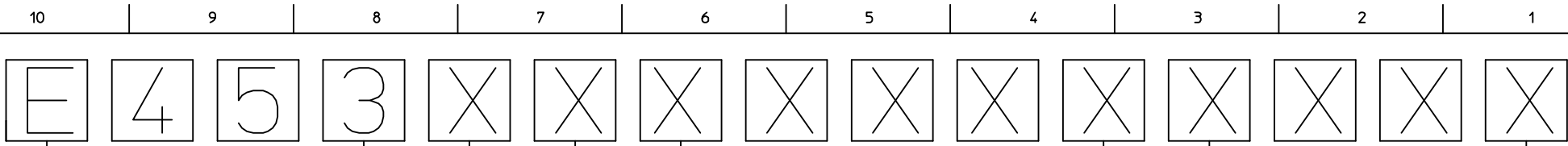

E - Packing without bags
 W - Single packing
 Q - Quick packing

NUMBER OF WIRES:
 3=3 WIRES + EARTH
 OR
 3=4 WIRES + EARTH (FOR Q CIRCUIT)

CABLE TYPE
 SEE SHEET 3 - TABLE 1

CABLE CROSS SECTION AREA
 SEE SHEET 3 - TABLE 2

HEAD COLOUR:
 N=BLACK,
 A=CSA-UL BLACK,
 B=CSA-UL GREY.

CABLE LENGHT IN CM
 Eg.:050=50 CM, 300=300 CM, 10K=1000 CM.

EARTH PIN LOCATION (SEE INSERT ORIENTATION TABLE):
 1=DOUBLE EARTH ON 6H AND 12H,
 2=EARTH ON 12H,
 6=EARTH ON 6H.

TYPE OF GASKET AND SCREW:
 1=NBR PROFILE GASKET + FIXING SCREWS (M3x25 mm)
 2=NBR FLAT GASKET + FIXING SCREW (M3x25 mm)
 3=SILICONE PROFILE GASKET + FIXING SCREW (M3x25 mm)
 4=SILICON FLAT GASKET + FIXING SCREW (M3x25 mm)
 P=INTEGRATED GASKET ASSEMBLED + FIXING SCREW WITH WASHER ASSEMBLED (M3x27 mm)
 R=INTAGRATED GASKET + FIXING SCREW + WASHER (M3x27 mm)
 T=PROFILE GASKET + FIXING SCREW + WASHER (M3x27 mm)

INTERNAL CIRCUIT, WIRING CONFIGURATION

VOLTAGE AND LED COLOUR:

NOTE: FOR CIRCUIT TYPE Q - BICOLOR LED - ONLY 1,2,3,4,5

1= 12V	A= 12V	G= 12V
2= 24V	B= 24V	H= 24V
3= 48V	C= 48V	K= 48V
4= 115V	D= 115V	L= 115V
5= 230V	E= 230V	M= 230V

RED LED GREEN LED YELLOW LED

See Sheet 1 EC NO: IPG2015-2/150 DRWN: JMARSZALEK 2015/06/22 CHKD: APAMLAK01 2015/06/22 APPR: MIWASIECZKO 2015/06/24	QUALITY SYMBOLS	GENERAL TOLERANCES (UNLESS SPECIFIED)	DIMENSION STYLE	SCALE	DESIGN UNITS	FIRST ANGLE PROJECTION																		
		<table border="1"> <thead> <tr> <th></th> <th>mm</th> <th>INCH</th> </tr> </thead> <tbody> <tr> <td>4 PLACES</td> <td>± ---</td> <td>± ---</td> </tr> <tr> <td>3 PLACES</td> <td>± ---</td> <td>± ---</td> </tr> <tr> <td>2 PLACES</td> <td>± ---</td> <td>± ---</td> </tr> <tr> <td>1 PLACE</td> <td>± ---</td> <td>± ---</td> </tr> <tr> <td>0 PLACE</td> <td>± ---</td> <td>± ---</td> </tr> </tbody> </table>		mm	INCH	4 PLACES	± ---	± ---	3 PLACES	± ---	± ---	2 PLACES	± ---	± ---	1 PLACE	± ---	± ---	0 PLACE	± ---	± ---	MM ONLY	1:1	METRIC	
		mm	INCH																					
	4 PLACES	± ---	± ---																					
	3 PLACES	± ---	± ---																					
2 PLACES	± ---	± ---																						
1 PLACE	± ---	± ---																						
0 PLACE	± ---	± ---																						
DESCRIPTION	<table border="1"> <thead> <tr> <th>DRAWN BY</th> <th>DATE</th> <th>TITLE</th> </tr> </thead> <tbody> <tr> <td>JMARSZALEK</td> <td>2012/11/27</td> <td>E453XXXXXXXXXX DIN FORM A</td> </tr> <tr> <td>CHECKED BY</td> <td>DATE</td> <td>EN 175301-803</td> </tr> <tr> <td>MSZWAJKOWSKI</td> <td>2012/11/27</td> <td>molex</td> </tr> <tr> <td>APPROVED BY</td> <td>DATE</td> <td></td> </tr> <tr> <td>MIWASIECZKO</td> <td>2014/01/30</td> <td></td> </tr> </tbody> </table>	DRAWN BY	DATE	TITLE	JMARSZALEK	2012/11/27	E453XXXXXXXXXX DIN FORM A	CHECKED BY	DATE	EN 175301-803	MSZWAJKOWSKI	2012/11/27	molex	APPROVED BY	DATE		MIWASIECZKO	2014/01/30						
DRAWN BY	DATE	TITLE																						
JMARSZALEK	2012/11/27	E453XXXXXXXXXX DIN FORM A																						
CHECKED BY	DATE	EN 175301-803																						
MSZWAJKOWSKI	2012/11/27	molex																						
APPROVED BY	DATE																							
MIWASIECZKO	2014/01/30																							
REV	ANGULAR ±---°	DRAFT WHERE APPLICABLE MUST REMAIN WITHIN DIMENSIONS	MATERIAL NO.	DOCUMENT NO.	SHEET NO.																			
			SEE SHEET 2 & 4	SD-121050-006	2 OF 10																			

TABLE 2 - CABLES

Cable type	Cable code	Wires no.	Cross Section	Jacket material	Jacket color	Diameter Ø [mm]	Wire colors
I	0	3	1 mm ²	PVC CEI 2022 II O.R.	Grey	7.6±0.2	BN, BU, GN/YE
A	2	3	20 AWG	PVC CSA/UL 2661	Black	5.4±0.2	BN, BU
A	2	3	20 AWG	PVC CSA/UL 2661	Black	5.6±0.2	BN, BU, GN/YE
A	2	4	20 AWG	PVC CSA/UL 2661	Black	6.2±0.25	BN, BU, BK, GN/YE
B	2	2	20 AWG	PUR CSA/UL 20668	Black	5.8±0.2	BN, BU
B	2	3	20 AWG	PUR CSA/UL 20668	Black	5.8±0.2	BN, BU, GN/YE
B	2	4	20 AWG	PUR CSA/UL 20668	Black	6.3±0.2	BN, BU, BK, GN/YE
D	2	3	0.5 mm ²	PVC CEI 20-20	Grey	5.5+0.3/-0	BN, BU, GN/YE
I	2	2	0.5 mm ²	PVC CEI 2022 II O.R.	Grey	5.5+0.3/-0	BN, BU
I	2	3	0.5 mm ²	PVC CEI 2022 II O.R.	Grey	5.5+0.3/-0	BN, BU, GN/YE
I	2	4	0.5 mm ²	PVC CEI 2022 II O.R.	Grey	6.5±0.2	BN, BU, BK, GN/YE
I	2	5	0.5 mm ²	PVC CEI 2022 II O.R.	Grey	7.0 +0.3/-0	BN, BU, BK, WH, GN/YE
N	2	2	0.5 mm ²	PVC H03VV-F	Black	5.2±0.2	BN, BU
N	2	3	0.5 mm ²	PVC H03VV-F	Black	5.5±0.2	BN, BU, GN/YE
N	2	4	0.5 mm ²	PVC H03VV-F	Black	5.9±0.3	BN, BU, BK, GN/YE
P	2	2	0.5 mm ²	PUR - BLEND	Black	5.5±0.2	BN, BU
P	2	3	0.5 mm ²	PUR - BLEND	Black	5.5 +0.3/-0	BN, BU, GN/YE
P	2	4	0.5 mm ²	PUR - BLEND	Black	6.5±0.2	BN, BU, BK, GN/YE
P	2	5	0.5 mm ²	PUR - BLEND	Black	7+0.3/-0.1	BN, BU, BK, WH, GN/YE
A	3	2	18 AWG	PVC CSA/UL 2661	Black	6.2±0.25	BN, BU
A	3	3	18 AWG	PVC CSA/UL 2661	Black	6.5±0.25	BN, BU, GN/YE
A	3	4	18 AWG	PVC CSA/UL 2661	Black	7.0+0.3/-0	BN, BU, BK, GN/YE
A	3	5	18 AWG	PVC CSA/UL 2661	Black	7.8±0.25	BN, BU, BK, WH, GN/YE
B	3	2	18 AWG	PUR CSA/UL 20668	Black	6.2±0.2	BN, BU
B	3	3	18 AWG	PUR CSA/UL 20668	Black	6.5±0.2	BN, BU, GN/YE
B	3	4	18 AWG	PUR CSA/UL 20668	Black	7±0.2	BN, BU, BK, GN/YE
B	3	5	18 AWG	PUR CSA/UL 20668	Black	7.8±0.25	BN, BU, BK, WH, GN/YE
D	3	3	0.75 mm ²	PVC CEI 20-20	Grey	6.5±0.2	BN, BU, GN/YE
D	3	4	0.75 mm ²	PVC CEI 20-20	Grey	7.1±0.2	BN, BU, BK, GN/YE
I	3	2	0.75 mm ²	PVC CEI 2022 II O.R.	Grey	5.5±0.2	BK1, BK2
I	3	3	0.75 mm ²	PVC CEI 2022 II O.R.	Grey	6.0±0.2	BK1, BK2, BK3
I	3	4	0.75 mm ²	PVC CEI 2022 II O.R.	Grey	7.0±0.2	BN, BU, BK, GN/YE
N	3	2	0.75 mm ²	PVC H05VV-F	Black	6.2±0.2	BN, BU
N	3	3	0.75 mm ²	PVC H05VV-F	Black	6.5±0.2	BN, BU, GN/YE
N	3	4	0.75 mm ²	PVC H05VV-F	Black	7.1±0.2	BN, BU, BK, GN/YE
N	3	5	0.75 mm ²	PVC H05VV-F	Black	8.0+0.2/-0	BN, BU, BK, GY, GN/YE
P	3	2	0.75 mm ²	PUR - BLEND	Black	6.5±0.2	BN, BU
P	3	3	0.75 mm ²	PUR - BLEND	Black	6.5±0.2	BN, BU, GN/YE
P	3	4	0.75 mm ²	PUR - BLEND	Black	7.0±0.2	BN, BU, BK, GN/YE

TABLE 2 - CABLES

Cable type	Cable code	Wires no.	Cross Section	Jacket material	Jacket color	Diameter Ø [mm]	Wire colors
R	3	3	0.75 mm ²	TPR HAL. FREE	Black	6.5±0.2	BN, BU, GN/YE
T	3	3	0.75 mm ²	PUR CSA/UL 20668	Yellow	6.5±0.2	BN, BU, GN/YE
Y	3	3	0.75 mm ²	SILICONE RUBBER	Red	6.5±0.2	BN, BU, GN/YE
F	4	3	1 mm ²	PVC CNOMO	Grey	7.1+0.2/-0	BK1, BK2, GN/YE
I	4	2	1 mm ²	PVC CEI 2022 II O.R.	Grey	7.1+0.2/-0	BN, BU
I	4	3	1 mm ²	PVC CEI 2022 II O.R.	Grey	7.1+0.2/-0	BN, BU, GN/YE
N	4	2	1 mm ²	PVC H05VV-F	Black	6.5±0.2	BN, BU
N	4	3	1 mm ²	PVC H05VV-F	Black	6.9±0.2	BN, BU, GN/YE
R	4	3	1 mm ²	TPR HAL. FREE	Black	7.1±0.2	BN, BU, GN/YE
N	5	3	1.5 mm ²	PVC H05VV-F	Black	7.9±0.2	BN, BU, GN/YE
I	6	2	0.35 mm ²	PVC CEI 2011	Grey	4.8±0.2	BN, WH
I	9	4	0.75 mm ²	PVC CEI 2022 II	Grey	7.3±0.2	BN, BU, BK, GN/YE

TABLE 1 - CABLES TYPE

Code	Cable types	Features	Cable type Cross section
N	PVC	Application general purpose cable which has good resistance to water, but usually poor oil resistance.	N2=0.5 mm ² N3=0.75 mm ² N4=1 mm ²
I	CEI	Approved to IEC 332-2A, flame retardant and self extinguishing. Limited resistant to mineral oils.	I2=0.5 mm ² I3=0.75 mm ² I4=1 mm ²
P	PUR	Offer good resistance to oil and chemicals. Can swell when constantly immersed in water.	P2=0.5 mm ² P3=0.75 mm ² P4=1 mm ²
A	PVC CSA-UL	Approved to CSA-UL 2661, application general purpose cable which has good resistance to water, but usually poor oil resistance.	A2=20 AWG A3=18 AWG
B	PUR CSA-UL	Approved to CSA-UL 20668, very good resistance to oil and chemicals.	B2=20 AWG B3=18 AWG

See Sheet 1 EC NO: IPG2015-2150 DRWN: JMARSZALEK 2015/06/22 CHKD: APAMLAK01 2015/06/22 APPR: MIWASIECZKO 2015/06/24	QUALITY SYMBOLS	GENERAL TOLERANCES (UNLESS SPECIFIED)	DIMENSION STYLE	SCALE	DESIGN UNITS	FIRST ANGLE PROJECTION
	▼ = 0 ▽ = 0	mm INCH 4 PLACES ± --- ± --- 3 PLACES ± --- ± --- 2 PLACES ± --- ± --- 1 PLACE ± --- ± --- 0 PLACE ± --- ± ---	MM ONLY	1:1	METRIC	DRAWN BY: JMARSZALEK DATE: 2012/11/27 CHECKED BY: DATE: MSZWAJKOWSKI 2012/11/27 APPROVED BY: DATE: MIWASIECZKO 2014/01/30
	ANGULAR ± --- ° DRAFT WHERE APPLICABLE MUST REMAIN WITHIN DIMENSIONS	MATERIAL NO. SEE SHEET 2 & 4	TITLE E453XXXXXXXXXX DIN FORM A EN 175301-803 molex			
	SHEET NO. 3 OF 10	DOCUMENT NO. SD-121050-006	THIS DRAWING CONTAINS INFORMATION THAT IS PROPRIETARY TO MOLEX INCORPORATED AND SHOULD NOT BE USED WITHOUT WRITTEN PERMISSION			

10

9

8

7

6

5

4

3

2

1

TABLE 3 - PART LIST

Pos.	Molex PN:	Engineering No.:	Pos.	Molex PN:	Engineering No.:	Pos.	Molex PN:	Engineering No.:	Pos.	Molex PN:	Engineering No.:	Pos.	Molex PN:	Engineering No.:
1	1210400521	E453A3A30022000	41	1210401307	W453P3N50062000	81	1210502979	E453P2N10K2P002	121	2210507761	E453A2A10K21175	161	2210507801	E453A2A2002117K
2	1210400522	E453A3A30062000	42	1210500839	E45313N20021002	82	1210502980	E453P2N5002R002	122	2210507762	E453A2A10K2117A	162	2210507802	E453A2A2002117L
3	1210400524	E453B3A10062000	43	1210500842	E45313N30021002	83	1210503016	E453B3A30063002	123	2210507763	E453A2A10K2117B	163	2210507803	E453A2A2002117M
4	1210400525	E453B3A10K22000	44	1210500844	E45313N30021012	84	1210503019	E453N3N30021A1H	124	2210507764	E453A2A10K2117C	164	2210507804	E453A2A30011000
5	1210400526	E453B3A10K62000	45	1210500845	E45313N30021062	85	1210503035	E453N2N20061C42	125	2210507765	E453A2A10K2117D	165	2210507805	E453A2A30021171
6	1210400527	E453B3A30022000	46	1210500848	E45313N30061012	86	1210503043	E453P3N3001P17H	126	2210507766	E453A2A10K2117E	166	2210507806	E453A2A30021172
7	1210400528	E453B3A30062000	47	1210500854	E45313N50021012	87	1210503107	E453A3A15021002	127	2210507767	E453A2A10K2117G	167	2210507807	E453A2A30021173
8	1210400529	E453B3A50022000	48	1210500858	E45313N50061012	88	1210503108	E453A3A30021002	128	2210507768	E453A2A10K2117H	168	2210507808	E453A2A30021174
9	1210400530	E453B3A50062000	49	1210500875	E453N3N50022002	89	1210503109	E453A3A50021002	129	2210507769	E453A2A10K2117K	169	2210507809	E453A2A30021175
10	1210400537	E453N3N10022000	50	1210500888	E453P2N30021001	90	1210503110	E453A3A75021002	130	2210507770	E453A2A10K2117L	170	2210507810	E453A2A3002117A
11	1210400538	E453N3N10062000	51	1210500889	E453P2N30021002	91	1210503111	E453A3A10K21002	131	2210507771	E453A2A10K2117M	171	2210507811	E453A2A3002117B
12	1210400539	E453N3N30022000	52	1210500895	E453P2N30061012	92	1210503124	E45312N50021062	132	2210507772	E453A2A15011000	172	2210507812	E453A2A3002117C
13	1210400540	E453N3N30062000	53	1210501705	E453N3N50021002	93	1210503134	E453N3N50021012	133	2210507773	E453A2A15021171	173	2210507813	E453A2A3002117D
14	1210400541	E453N3N50022000	54	1210501787	E453N3N30061002	94	1210503230	E453N3N40061C42	134	2210507774	E453A2A15021172	174	2210507814	E453A2A3002117E
15	1210400542	E453N3N50062000	55	1210501794	E45313N10K61002	95	1210503249	E453P2N50021002	135	2210507775	E453A2A15021173	175	2210507815	E453A2A3002117G
16	1210400544	E453P3N10022000	56	1210501823	E453P2N50061012	96	1210503251	E453N3N10K2R4B	136	2210507776	E453A2A15021174	176	2210507816	E453A2A3002117H
17	1210400545	E453P3N10062000	57	1210501848	E453P3N4001117H	97	1210503252	E453N3N10K2R4A	137	2210507777	E453A2A15021175	177	2210507817	E453A2A3002117K
18	1210400547	E453P3N30022000	58	1210501868	E453P2N30021052	98	1210503430	E45312N15K61012	138	2210507778	E453A2A1502117A	178	2210507818	E453A2A3002117L
19	1210400548	E453P3N30062000	59	1210501869	E453P2N50021052	99	1210503434	E453N3N25021C4H	139	2210507779	E453A2A1502117B	179	2210507819	E453A2A3002117M
20	1210400550	E453P3N50022000	60	1210502033	E453P3N4001118H	100	2210507740	E453A2A10011000	140	2210507780	E453A2A1502117C	180	2210507820	E453A2A50011000
21	1210400551	E453P3N50062000	61	1210502131	E45312N30021002	101	2210507741	E453A2A10021171	141	2210507781	E453A2A1502117D	181	2210507821	E453A2A50021171
22	1210400675	E453A3A50022000	62	1210502409	E45312N20021012	102	2210507742	E453A2A10021172	142	2210507782	E453A2A1502117E	182	2210507822	E453A2A50021172
23	1210400684	E453N3N10K62000	63	1210502410	E45312N30021012	103	2210507743	E453A2A10021173	143	2210507783	E453A2A1502117G	183	2210507823	E453A2A50021173
24	1210400696	E453A3A10K22000	64	1210502440	E45312N50021012	104	2210507744	E453A2A10021174	144	2210507784	E453A2A1502117H	184	2210507824	E453A2A50021174
25	1210400697	E453A3A50062000	65	1210502446	E45313N80021012	105	2210507745	E453A2A10021175	145	2210507785	E453A2A1502117K	185	2210507825	E453A2A50021175
26	1210400698	E453A3A10K62000	66	1210502452	E453B3A50061002	106	2210507746	E453A2A1002117A	146	2210507786	E453A2A1502117L	186	2210507826	E453A2A5002117A
27	1210400796	E453N3N20062000	67	1210502453	E453B3A10K21002	107	2210507747	E453A2A1002117B	147	2210507787	E453A2A1502117M	187	2210507827	E453A2A5002117B
28	1210400833	E453A3A10022000	68	1210502454	E453B3A50021002	108	2210507748	E453A2A1002117C	148	2210507788	E453A2A20011000	188	2210507828	E453A2A5002117C
29	1210400864	E453B2A30022000	69	1210502455	E453B3A30021002	109	2210507749	E453A2A1002117D	149	2210507789	E453A2A20021171	189	2210507829	E453A2A5002117D
30	1210400937	E453N3N2002P000	70	1210502473	E45313N5002R002	110	2210507750	E453A2A1002117E	150	2210507790	E453A2A20021172	190	2210507830	E453A2A5002117E
31	1210400953	E453N3N1002P000	71	1210502517	E45312N10K21012	111	2210507751	E453A2A1002117G	151	2210507791	E453A2A20021173	191	2210507831	E453A2A5002117G
32	1210400967	E453N3N5002P000	72	1210502535	E453P2N10K61012	112	2210507752	E453A2A1002117H	152	2210507792	E453A2A20021174	192	2210507832	E453A2A5002117H
33	1210400973	E453P3N2502P000	73	1210502557	E45312N50021002	113	2210507753	E453A2A1002117K	153	2210507793	E453A2A20021175	193	2210507833	E453A2A5002117K
34	1210400974	E453P3N2002P000	74	1210502562	E453N3N30022C44	114	2210507754	E453A2A1002117L	154	2210507794	E453A2A2002117A	194	2210507834	E453A2A5002117L
35	1210400980	E453A3A15K62000	75	1210502603	E453P3N5001118H	115	2210507755	E453A2A1002117M	155	2210507795	E453A2A2002117B	195	2210507835	E453A2A5002117M
36	1210401232	W453P3N30022000	76	1210502668	E45312N30021062	116	2210507756	E453A2A10K11000	156	2210507796	E453A2A2002117C	196	2210507836	E453A3A10011000
37	1210401236	W453N3N30022000	77	1210502941	W45313N5002R002	117	2210507757	E453A2A10K21171	157	2210507797	E453A2A2002117D	197	2210507837	E453A3A10021171
38	1210401264	E453P3N5002P000	78	1210502964	W45313N2002R002	118	2210507758	E453A2A10K21172	158	2210507798	E453A2A2002117E	198	2210507838	E453A3A10021172
39	1210401266	W453N3N50022000	79	1210502966	W453A3A10K2R002	119	2210507759	E453A2A10K21173	159	2210507799	E453A2A2002117G	199	2210507839	E453A3A10021173
40	1210401267	W453N3N50062000	80	1210502972	E453N2N80011172	120	2210507760	E453A2A10K21174	160	2210507800	E453A2A2002117H	200	2210507840	E453A3A10021174

See Sheet 1 EC NO: IPG2015-2150 DRWN: JMARSZALEK 2015/06/22 CHKD: APAMLA01 2015/06/22 APPR: MIWASIECZKO 2015/06/24	QUALITY SYMBOLS ▽=0 ◻=0	GENERAL TOLERANCES (UNLESS SPECIFIED)	DIMENSION STYLE		SCALE	DESIGN UNITS	FIRST ANGLE PROJECTION
			MM ONLY		1:1	METRIC	
DRAWN BY DATE JMARSZALEK 2012/11/27	CHECKED BY DATE MSZWAIKOWSKI 2012/11/27	APPROVED BY DATE MIWASIECZKO 2014/01/30	DRAWN BY DATE		TITLE		
			CHECKED BY DATE		E453XXXXXXXXXX DIN FORM A EN 175301-803		
ANGULAR ±---°			MATERIAL NO.		DOCUMENT NO.		
DRAFT WHERE APPLICABLE MUST REMAIN WITHIN DIMENSIONS			SEE SHEET 2 & 4		SD-121050-006		
SIZE A3			THIS DRAWING CONTAINS INFORMATION THAT IS PROPRIETARY TO MOLEX INCORPORATED AND SHOULD NOT BE USED WITHOUT WRITTEN PERMISSION				

9

8

7

6

5

4

3

2

1

TABLE 3 - PART LIST

Pos.	MoLex PN:	Engineering No.:	Pos.	MoLex PN:	Engineering No.:	Pos.	MoLex PN:	Engineering No.:	Pos.	MoLex PN:	Engineering No.:	Pos.	MoLex PN:	Engineering No.:	Pos.	MoLex PN:	Engineering No.:
201	2210507841	E453A3A10021175	241	2210507881	E453A3A1502117K	281	2210507921	E453A3A50021175	321	2210507961	E453B2A10K2117K	361	2210508001	E453B2A30021175			
202	2210507842	E453A3A1002117A	242	2210507882	E453A3A1502117L	282	2210507922	E453A3A5002117A	322	2210507962	E453B2A10K2117L	362	2210508002	E453B2A3002117A			
203	2210507843	E453A3A1002117B	243	2210507883	E453A3A1502117M	283	2210507923	E453A3A5002117B	323	2210507963	E453B2A10K2117M	363	2210508003	E453B2A3002117B			
204	2210507844	E453A3A1002117C	244	2210507884	E453A3A20011000	284	2210507924	E453A3A5002117C	324	2210507964	E453B2A15011000	364	2210508004	E453B2A3002117C			
205	2210507845	E453A3A1002117D	245	2210507885	E453A3A20021171	285	2210507925	E453A3A5002117D	325	2210507965	E453B2A15021171	365	2210508005	E453B2A3002117D			
206	2210507846	E453A3A1002117E	246	2210507886	E453A3A20021172	286	2210507926	E453A3A5002117E	326	2210507966	E453B2A15021172	366	2210508006	E453B2A3002117E			
207	2210507847	E453A3A1002117G	247	2210507887	E453A3A20021173	287	2210507927	E453A3A5002117G	327	2210507967	E453B2A15021173	367	2210508007	E453B2A3002117G			
208	2210507848	E453A3A1002117H	248	2210507888	E453A3A20021174	288	2210507928	E453A3A5002117H	328	2210507968	E453B2A15021174	368	2210508008	E453B2A3002117H			
209	2210507849	E453A3A1002117K	249	2210507889	E453A3A20021175	289	2210507929	E453A3A5002117K	329	2210507969	E453B2A15021175	369	2210508009	E453B2A3002117K			
210	2210507850	E453A3A1002117L	250	2210507890	E453A3A2002117A	290	2210507930	E453A3A5002117L	330	2210507970	E453B2A1502117A	370	2210508010	E453B2A3002117L			
211	2210507851	E453A3A1002117M	251	2210507891	E453A3A2002117B	291	2210507931	E453A3A5002117M	331	2210507971	E453B2A1502117B	371	2210508011	E453B2A3002117M			
212	2210507852	E453A3A10K11000	252	2210507892	E453A3A2002117C	292	2210507932	E453B2A10011000	332	2210507972	E453B2A1502117C	372	2210508012	E453B2A50011000			
213	2210507853	E453A3A10K21171	253	2210507893	E453A3A2002117D	293	2210507933	E453B2A10021171	333	2210507973	E453B2A1502117D	373	2210508013	E453B2A50021171			
214	2210507854	E453A3A10K21172	254	2210507894	E453A3A2002117E	294	2210507934	E453B2A10021172	334	2210507974	E453B2A1502117E	374	2210508014	E453B2A50021172			
215	2210507855	E453A3A10K21173	255	2210507895	E453A3A2002117G	295	2210507935	E453B2A10021173	335	2210507975	E453B2A1502117G	375	2210508015	E453B2A50021173			
216	2210507856	E453A3A10K21174	256	2210507896	E453A3A2002117H	296	2210507936	E453B2A10021174	336	2210507976	E453B2A1502117H	376	2210508016	E453B2A50021174			
217	2210507857	E453A3A10K21175	257	2210507897	E453A3A2002117K	297	2210507937	E453B2A10021175	337	2210507977	E453B2A1502117K	377	2210508017	E453B2A50021175			
218	2210507858	E453A3A10K2117A	258	2210507898	E453A3A2002117L	298	2210507938	E453B2A1002117A	338	2210507978	E453B2A1502117L	378	2210508018	E453B2A5002117A			
219	2210507859	E453A3A10K2117B	259	2210507899	E453A3A2002117M	299	2210507939	E453B2A1002117B	339	2210507979	E453B2A1502117M	379	2210508019	E453B2A5002117B			
220	2210507860	E453A3A10K2117C	260	2210507900	E453A3A30011000	300	2210507940	E453B2A1002117C	340	2210507980	E453B2A20011000	380	2210508020	E453B2A5002117C			
221	2210507861	E453A3A10K2117D	261	2210507901	E453A3A30021171	301	2210507941	E453B2A1002117D	341	2210507981	E453B2A20021171	381	2210508021	E453B2A5002117D			
222	2210507862	E453A3A10K2117E	262	2210507902	E453A3A30021172	302	2210507942	E453B2A1002117E	342	2210507982	E453B2A20021172	382	2210508022	E453B2A5002117E			
223	2210507863	E453A3A10K2117G	263	2210507903	E453A3A30021173	303	2210507943	E453B2A1002117G	343	2210507983	E453B2A20021173	383	2210508023	E453B2A5002117G			
224	2210507864	E453A3A10K2117H	264	2210507904	E453A3A30021174	304	2210507944	E453B2A1002117H	344	2210507984	E453B2A20021174	384	2210508024	E453B2A5002117H			
225	2210507865	E453A3A10K2117K	265	2210507905	E453A3A30021175	305	2210507945	E453B2A1002117K	345	2210507985	E453B2A20021175	385	2210508025	E453B2A5002117K			
226	2210507866	E453A3A10K2117L	266	2210507906	E453A3A3002117A	306	2210507946	E453B2A1002117L	346	2210507986	E453B2A2002117A	386	2210508026	E453B2A5002117L			
227	2210507867	E453A3A10K2117M	267	2210507907	E453A3A3002117B	307	2210507947	E453B2A1002117M	347	2210507987	E453B2A2002117B	387	2210508027	E453B2A5002117M			
228	2210507868	E453A3A15011000	268	2210507908	E453A3A3002117C	308	2210507948	E453B2A10K11000	348	2210507988	E453B2A2002117C	388	2210508028	E453B3A10011000			
229	2210507869	E453A3A15021171	269	2210507909	E453A3A3002117D	309	2210507949	E453B2A10K21171	349	2210507989	E453B2A2002117D	389	2210508029	E453B3A10021171			
230	2210507870	E453A3A15021172	270	2210507910	E453A3A3002117E	310	2210507950	E453B2A10K21172	350	2210507990	E453B2A2002117E	390	2210508030	E453B3A10021172			
231	2210507871	E453A3A15021173	271	2210507911	E453A3A3002117G	311	2210507951	E453B2A10K21173	351	2210507991	E453B2A2002117G	391	2210508031	E453B3A10021173			
232	2210507872	E453A3A15021174	272	2210507912	E453A3A3002117H	312	2210507952	E453B2A10K21174	352	2210507992	E453B2A2002117H	392	2210508032	E453B3A10021174			
233	2210507873	E453A3A15021175	273	2210507913	E453A3A3002117K	313	2210507953	E453B2A10K21175	353	2210507993	E453B2A2002117K	393	2210508033	E453B3A10021175			
234	2210507874	E453A3A1502117A	274	2210507914	E453A3A3002117L	314	2210507954	E453B2A10K2117A	354	2210507994	E453B2A2002117L	394	2210508034	E453B3A1002117A			
235	2210507875	E453A3A1502117B	275	2210507915	E453A3A3002117M	315	2210507955	E453B2A10K2117B	355	2210507995	E453B2A2002117M	395	2210508035	E453B3A1002117B			
236	2210507876	E453A3A1502117C	276	2210507916	E453A3A50011000	316	2210507956	E453B2A10K2117C	356	2210507996	E453B2A30011000	396	2210508036	E453B3A1002117C			
237	2210507877	E453A3A1502117D	277	2210507917	E453A3A50021171	317	2210507957	E453B2A10K2117D	357	2210507997	E453B2A30021171	397	2210508037	E453B3A1002117D			
238	2210507878	E453A3A1502117E	278	2210507918	E453A3A50021172	318	2210507958	E453B2A10K2117E	358	2210507998	E453B2A30021172	398	2210508038	E453B3A1002117E			
239	2210507879	E453A3A1502117G	279	2210507919	E453A3A50021173	319	2210507959	E453B2A10K2117G	359	2210507999	E453B2A30021173	399	2210508039	E453B3A1002117G			
240	2210507880	E453A3A1502117H	280	2210507920	E453A3A50021174	320	2210507960	E453B2A10K2117H	360	2210508000	E453B2A30021174	400	2210508040	E453B3A1002117H			

See Sheet 1 EC NO: IPG2015-2150 DRWN: JMARSZALEK 2015/06/22 CHKD: APAM LAKO1 2015/06/22 APPR: MIWASIECZKO 2015/06/24	QUALITY SYMBOLS ▽=0 ◻=0	GENERAL TOLERANCES (UNLESS SPECIFIED)		DIMENSION STYLE MM ONLY		SCALE 1:1	DESIGN UNITS METRIC	FIRST ANGLE PROJECTION
		mm	INCH	DRAWN BY JMARSZALEK	DATE 2012/11/27	TITLE E453XXXXXXXXXX DIN FORM A EN 175301-803		
DRAFT WHERE APPLICABLE MUST REMAIN WITHIN DIMENSIONS	4 PLACES	± ---	± ---	CHECKED BY MSZWAJKOWSKI	DATE 2012/11/27	MATERIAL NO. SD-121050-006		SHEET NO. 5 OF 10
	3 PLACES	± ---	± ---	APPROVED BY MIWASIECZKO	DATE 2014/01/30	DOCUMENT NO.		
	2 PLACES	± ---	± ---	THIS DRAWING CONTAINS INFORMATION THAT IS PROPRIETARY TO MOLEX INCORPORATED AND SHOULD NOT BE USED WITHOUT WRITTEN PERMISSION				
	1 PLACE	± ---	± ---					
0 PLACE	± ---	± ---						

TABLE 3 - PART LIST

Pos.	Molex PN:	Engineering No.:	Pos.	Molex PN:	Engineering No.:	Pos.	Molex PN:	Engineering No.:	Pos.	Molex PN:	Engineering No.:	Pos.	Molex PN:	Engineering No.:
401	2210508041	E453B3A1002117K	441	2210508081	E453B3A20021175	481	2210508121	E453B3A5002117K	521	2210508161	E45312N10K2117A	561	2210508201	E45312N1502117M
402	2210508042	E453B3A1002117L	442	2210508082	E453B3A2002117A	482	2210508122	E453B3A5002117L	522	2210508162	E45312N10K2117B	562	2210508202	E45312N15021001
403	2210508043	E453B3A1002117M	443	2210508083	E453B3A2002117B	483	2210508123	E453B3A5002117M	523	2210508163	E45312N10K2117C	563	2210508203	E45312N15021002
404	2210508044	E453B3A10K11000	444	2210508084	E453B3A2002117C	484	2210508124	E45312N10011000	524	2210508164	E45312N10K2117D	564	2210508204	E45312N15021003
405	2210508045	E453B3A10K21171	445	2210508085	E453B3A2002117D	485	2210508125	E45312N10021171	525	2210508165	E45312N10K2117E	565	2210508205	E45312N15021004
406	2210508046	E453B3A10K21172	446	2210508086	E453B3A2002117E	486	2210508126	E45312N10021172	526	2210508166	E45312N10K2117G	566	2210508206	E45312N15021005
407	2210508047	E453B3A10K21173	447	2210508087	E453B3A2002117G	487	2210508127	E45312N10021173	527	2210508167	E45312N10K2117H	567	2210508207	E45312N1502100A
408	2210508048	E453B3A10K21174	448	2210508088	E453B3A2002117H	488	2210508128	E45312N10021174	528	2210508168	E45312N10K2117K	568	2210508208	E45312N1502100B
409	2210508049	E453B3A10K21175	449	2210508089	E453B3A2002117K	489	2210508129	E45312N10021175	529	2210508169	E45312N10K2117L	569	2210508209	E45312N1502100C
410	2210508050	E453B3A10K2117A	450	2210508090	E453B3A2002117L	490	2210508130	E45312N1002117A	530	2210508170	E45312N10K2117M	570	2210508210	E45312N1502100D
411	2210508051	E453B3A10K2117B	451	2210508091	E453B3A2002117M	491	2210508131	E45312N1002117B	531	2210508171	E45312N10K21001	571	2210508211	E45312N1502100E
412	2210508052	E453B3A10K2117C	452	2210508092	E453B3A30011000	492	2210508132	E45312N1002117C	532	2210508172	E45312N10K21002	572	2210508212	E45312N1502100G
413	2210508053	E453B3A10K2117D	453	2210508093	E453B3A30021171	493	2210508133	E45312N1002117D	533	2210508173	E45312N10K21003	573	2210508213	E45312N1502100H
414	2210508054	E453B3A10K2117E	454	2210508094	E453B3A30021172	494	2210508134	E45312N1002117E	534	2210508174	E45312N10K21004	574	2210508214	E45312N1502100K
415	2210508055	E453B3A10K2117G	455	2210508095	E453B3A30021173	495	2210508135	E45312N1002117G	535	2210508175	E45312N10K21005	575	2210508215	E45312N1502100L
416	2210508056	E453B3A10K2117H	456	2210508096	E453B3A30021174	496	2210508136	E45312N1002117H	536	2210508176	E45312N10K2100A	576	2210508216	E45312N1502100M
417	2210508057	E453B3A10K2117K	457	2210508097	E453B3A30021175	497	2210508137	E45312N1002117K	537	2210508177	E45312N10K2100B	577	2210508217	E45312N20011000
418	2210508058	E453B3A10K2117L	458	2210508098	E453B3A3002117A	498	2210508138	E45312N1002117L	538	2210508178	E45312N10K2100C	578	2210508218	E45312N20021171
419	2210508059	E453B3A10K2117M	459	2210508099	E453B3A3002117B	499	2210508139	E45312N1002117M	539	2210508179	E45312N10K2100D	579	2210508219	E45312N20021172
420	2210508060	E453B3A15011000	460	2210508100	E453B3A3002117C	500	2210508140	E45312N10021001	540	2210508180	E45312N10K2100E	580	2210508220	E45312N20021173
421	2210508061	E453B3A15021171	461	2210508101	E453B3A3002117D	501	2210508141	E45312N10021002	541	2210508181	E45312N10K2100G	581	2210508221	E45312N20021174
422	2210508062	E453B3A15021172	462	2210508102	E453B3A3002117E	502	2210508142	E45312N10021003	542	2210508182	E45312N10K2100H	582	2210508222	E45312N20021175
423	2210508063	E453B3A15021173	463	2210508103	E453B3A3002117G	503	2210508143	E45312N10021004	543	2210508183	E45312N10K2100K	583	2210508223	E45312N2002117A
424	2210508064	E453B3A15021174	464	2210508104	E453B3A3002117H	504	2210508144	E45312N10021005	544	2210508184	E45312N10K2100L	584	2210508224	E45312N2002117B
425	2210508065	E453B3A15021175	465	2210508105	E453B3A3002117K	505	2210508145	E45312N1002100A	545	2210508185	E45312N10K2100M	585	2210508225	E45312N2002117C
426	2210508066	E453B3A1502117A	466	2210508106	E453B3A3002117L	506	2210508146	E45312N1002100B	546	2210508186	E45312N15011000	586	2210508226	E45312N2002117D
427	2210508067	E453B3A1502117B	467	2210508107	E453B3A3002117M	507	2210508147	E45312N1002100C	547	2210508187	E45312N15021171	587	2210508227	E45312N2002117E
428	2210508068	E453B3A1502117C	468	2210508108	E453B3A50011000	508	2210508148	E45312N1002100D	548	2210508188	E45312N15021172	588	2210508228	E45312N2002117G
429	2210508069	E453B3A1502117D	469	2210508109	E453B3A50021171	509	2210508149	E45312N1002100E	549	2210508189	E45312N15021173	589	2210508229	E45312N2002117H
430	2210508070	E453B3A1502117E	470	2210508110	E453B3A50021172	510	2210508150	E45312N1002100G	550	2210508190	E45312N15021174	590	2210508230	E45312N2002117K
431	2210508071	E453B3A1502117G	471	2210508111	E453B3A50021173	511	2210508151	E45312N1002100H	551	2210508191	E45312N15021175	591	2210508231	E45312N2002117L
432	2210508072	E453B3A1502117H	472	2210508112	E453B3A50021174	512	2210508152	E45312N1002100K	552	2210508192	E45312N1502117A	592	2210508232	E45312N2002117M
433	2210508073	E453B3A1502117K	473	2210508113	E453B3A50021175	513	2210508153	E45312N1002100L	553	2210508193	E45312N1502117B	593	2210508233	E45312N20021001
434	2210508074	E453B3A1502117L	474	2210508114	E453B3A5002117A	514	2210508154	E45312N1002100M	554	2210508194	E45312N1502117C	594	2210508234	E45312N20021002
435	2210508075	E453B3A1502117M	475	2210508115	E453B3A5002117B	515	2210508155	E45312N10K11000	555	2210508195	E45312N1502117D	595	2210508235	E45312N20021003
436	2210508076	E453B3A20011000	476	2210508116	E453B3A5002117C	516	2210508156	E45312N10K21171	556	2210508196	E45312N1502117E	596	2210508236	E45312N20021004
437	2210508077	E453B3A20021171	477	2210508117	E453B3A5002117D	517	2210508157	E45312N10K21172	557	2210508197	E45312N1502117G	597	2210508237	E45312N20021005
438	2210508078	E453B3A20021172	478	2210508118	E453B3A5002117E	518	2210508158	E45312N10K21173	558	2210508198	E45312N1502117H	598	2210508238	E45312N2002100A
439	2210508079	E453B3A20021173	479	2210508119	E453B3A5002117G	519	2210508159	E45312N10K21174	559	2210508199	E45312N1502117K	599	2210508239	E45312N2002100B
440	2210508080	E453B3A20021174	480	2210508120	E453B3A5002117H	520	2210508160	E45312N10K21175	560	2210508200	E45312N1502117L	600	2210508240	E45312N2002100C

See Sheet 1 EC NO: IPG2015-2150 DRWN: JMARSZALEK 2015/06/22 CHKD: APAMLA01 2015/06/22 APPR: MIWASIECZKO 2015/06/24	QUALITY SYMBOLS ▽=0 ◻=0	GENERAL TOLERANCES (UNLESS SPECIFIED)		DIMENSION STYLE MM ONLY		SCALE 1:1	DESIGN UNITS METRIC	FIRST ANGLE PROJECTION	
			mm	INCH	DRAWN BY JMARSZALEK	DATE 2012/11/27	TITLE E453XXXXXXXXXX DIN FORM A EN 175301-803	molex	
	4 PLACES	± ---	± ---	CHECKED BY MSZWAJKOWSKI	DATE 2012/11/27	MATERIAL NO. SEE SHEET 2 & 4	DOCUMENT NO. SD-121050-006		
	3 PLACES	± ---	± ---	APPROVED BY MIWASIECZKO	DATE 2014/01/30	DRAFT WHERE APPLICABLE MUST REMAIN WITHIN DIMENSIONS			
	2 PLACES	± ---	± ---	THIS DRAWING CONTAINS INFORMATION THAT IS PROPRIETARY TO MOLEX INCORPORATED AND SHOULD NOT BE USED WITHOUT WRITTEN PERMISSION					
	1 PLACE	± ---	± ---						
	0 PLACE	± ---	± ---						

TABLE 3 - PART LIST

Pos.	Molex PN:	Engineering No.:	Pos.	Molex PN:	Engineering No.:	Pos.	Molex PN:	Engineering No.:	Pos.	Molex PN:	Engineering No.:	Pos.	Molex PN:	Engineering No.:
601	2210508241	E45312N2002100D	641	2210508281	E45312N50021173	681	2210508321	E45313N1002117K	721	2210508361	E45313N10K2100B	761	2210508401	E45313N20011000
602	2210508242	E45312N2002100E	642	2210508282	E45312N50021174	682	2210508322	E45313N1002117L	722	2210508362	E45313N10K2100C	762	2210508402	E45313N20021171
603	2210508243	E45312N2002100G	643	2210508283	E45312N50021175	683	2210508323	E45313N1002117M	723	2210508363	E45313N10K2100D	763	2210508403	E45313N20021172
604	2210508244	E45312N2002100H	644	2210508284	E45312N5002117A	684	2210508324	E45313N10021001	724	2210508364	E45313N10K2100E	764	2210508404	E45313N20021173
605	2210508245	E45312N2002100K	645	2210508285	E45312N5002117B	685	2210508325	E45313N10021002	725	2210508365	E45313N10K2100G	765	2210508405	E45313N20021174
606	2210508246	E45312N2002100L	646	2210508286	E45312N5002117C	686	2210508326	E45313N10021003	726	2210508366	E45313N10K2100H	766	2210508406	E45313N20021175
607	2210508247	E45312N2002100M	647	2210508287	E45312N5002117D	687	2210508327	E45313N10021004	727	2210508367	E45313N10K2100K	767	2210508407	E45313N2002117A
608	2210508248	E45312N30011000	648	2210508288	E45312N5002117E	688	2210508328	E45313N10021005	728	2210508368	E45313N10K2100L	768	2210508408	E45313N2002117B
609	2210508249	E45312N30021171	649	2210508289	E45312N5002117G	689	2210508329	E45313N1002100A	729	2210508369	E45313N10K2100M	769	2210508409	E45313N2002117C
610	2210508250	E45312N30021172	650	2210508290	E45312N5002117H	690	2210508330	E45313N1002100B	730	2210508370	E45313N15011000	770	2210508410	E45313N2002117D
611	2210508251	E45312N30021173	651	2210508291	E45312N5002117K	691	2210508331	E45313N1002100C	731	2210508371	E45313N15021171	771	2210508411	E45313N2002117E
612	2210508252	E45312N30021174	652	2210508292	E45312N5002117L	692	2210508332	E45313N1002100D	732	2210508372	E45313N15021172	772	2210508412	E45313N2002117G
613	2210508253	E45312N30021175	653	2210508293	E45312N5002117M	693	2210508333	E45313N1002100E	733	2210508373	E45313N15021173	773	2210508413	E45313N2002117H
614	2210508254	E45312N3002117A	654	2210508294	E45312N50021001	694	2210508334	E45313N1002100G	734	2210508374	E45313N15021174	774	2210508414	E45313N2002117K
615	2210508255	E45312N3002117B	655	2210508295	E45312N50021003	695	2210508335	E45313N1002100H	735	2210508375	E45313N15021175	775	2210508415	E45313N2002117L
616	2210508256	E45312N3002117C	656	2210508296	E45312N50021004	696	2210508336	E45313N1002100K	736	2210508376	E45313N1502117A	776	2210508416	E45313N2002117M
617	2210508257	E45312N3002117D	657	2210508297	E45312N50021005	697	2210508337	E45313N1002100L	737	2210508377	E45313N1502117B	777	2210508417	E45313N20021001
618	2210508258	E45312N3002117E	658	2210508298	E45312N5002100A	698	2210508338	E45313N1002100M	738	2210508378	E45313N1502117C	778	2210508418	E45313N20021003
619	2210508259	E45312N3002117G	659	2210508299	E45312N5002100B	699	2210508339	E45313N10K11000	739	2210508379	E45313N1502117D	779	2210508419	E45313N20021004
620	2210508260	E45312N3002117H	660	2210508300	E45312N5002100C	700	2210508340	E45313N10K21171	740	2210508380	E45313N1502117E	780	2210508420	E45313N20021005
621	2210508261	E45312N3002117K	661	2210508301	E45312N5002100D	701	2210508341	E45313N10K21172	741	2210508381	E45313N1502117G	781	2210508421	E45313N2002100A
622	2210508262	E45312N3002117L	662	2210508302	E45312N5002100E	702	2210508342	E45313N10K21173	742	2210508382	E45313N1502117H	782	2210508422	E45313N2002100B
623	2210508263	E45312N3002117M	663	2210508303	E45312N5002100G	703	2210508343	E45313N10K21174	743	2210508383	E45313N1502117K	783	2210508423	E45313N2002100C
624	2210508264	E45312N30021001	664	2210508304	E45312N5002100H	704	2210508344	E45313N10K21175	744	2210508384	E45313N1502117L	784	2210508424	E45313N2002100D
625	2210508265	E45312N30021003	665	2210508305	E45312N5002100K	705	2210508345	E45313N10K2117A	745	2210508385	E45313N1502117M	785	2210508425	E45313N2002100E
626	2210508266	E45312N30021004	666	2210508306	E45312N5002100L	706	2210508346	E45313N10K2117B	746	2210508386	E45313N15021001	786	2210508426	E45313N2002100G
627	2210508267	E45312N30021005	667	2210508307	E45312N5002100M	707	2210508347	E45313N10K2117C	747	2210508387	E45313N15021002	787	2210508427	E45313N2002100H
628	2210508268	E45312N3002100A	668	2210508308	E45313N10011000	708	2210508348	E45313N10K2117D	748	2210508388	E45313N15021003	788	2210508428	E45313N2002100K
629	2210508269	E45312N3002100B	669	2210508309	E45313N10021171	709	2210508349	E45313N10K2117E	749	2210508389	E45313N15021004	789	2210508429	E45313N2002100L
630	2210508270	E45312N3002100C	670	2210508310	E45313N10021172	710	2210508350	E45313N10K2117G	750	2210508390	E45313N15021005	790	2210508430	E45313N2002100M
631	2210508271	E45312N3002100D	671	2210508311	E45313N10021173	711	2210508351	E45313N10K2117H	751	2210508391	E45313N1502100A	791	2210508431	E45313N30011000
632	2210508272	E45312N3002100E	672	2210508312	E45313N10021174	712	2210508352	E45313N10K2117K	752	2210508392	E45313N1502100B	792	2210508432	E45313N30021171
633	2210508273	E45312N3002100G	673	2210508313	E45313N10021175	713	2210508353	E45313N10K2117L	753	2210508393	E45313N1502100C	793	2210508433	E45313N30021172
634	2210508274	E45312N3002100H	674	2210508314	E45313N1002117A	714	2210508354	E45313N10K2117M	754	2210508394	E45313N1502100D	794	2210508434	E45313N30021173
635	2210508275	E45312N3002100K	675	2210508315	E45313N1002117B	715	2210508355	E45313N10K21001	755	2210508395	E45313N1502100E	795	2210508435	E45313N30021174
636	2210508276	E45312N3002100L	676	2210508316	E45313N1002117C	716	2210508356	E45313N10K21002	756	2210508396	E45313N1502100G	796	2210508436	E45313N30021175
637	2210508277	E45312N3002100M	677	2210508317	E45313N1002117D	717	2210508357	E45313N10K21003	757	2210508397	E45313N1502100H	797	2210508437	E45313N3002117A
638	2210508278	E45312N50011000	678	2210508318	E45313N1002117E	718	2210508358	E45313N10K21004	758	2210508398	E45313N1502100K	798	2210508438	E45313N3002117B
639	2210508279	E45312N50021171	679	2210508319	E45313N1002117G	719	2210508359	E45313N10K21005	759	2210508399	E45313N1502100L	799	2210508439	E45313N3002117C
640	2210508280	E45312N50021172	680	2210508320	E45313N1002117H	720	2210508360	E45313N10K2100A	760	2210508400	E45313N1502100M	800	2210508440	E45313N3002117D

See Sheet 1 EC NO: IPG2015-2150 DRWN: JMARSZALEK 2015/06/22 CHKD: APAM LAKO1 2015/06/22 APPR: MIWASIECZKO 2015/06/24	QUALITY SYMBOLS ▽=0 ◻=0	GENERAL TOLERANCES (UNLESS SPECIFIED)		DIMENSION STYLE MM ONLY	SCALE 1:1	DESIGN UNITS METRIC	FIRST ANGLE PROJECTION
		mm	INCH	DRAWN BY JMARSZALEK	DATE 2012/11/27	TITLE E453XXXXXXXXXXXX DIN FORM A EN 175301-803	
C	REV	4 PLACES ± --- ± ---		CHECKED BY MSZWAJKOWSKI	DATE 2012/11/27	APPROVED BY MIWASIECZKO	DATE 2014/01/30
		3 PLACES ± --- ± ---		APPROVED BY MIWASIECZKO			
DRAFT WHERE APPLICABLE MUST REMAIN WITHIN DIMENSIONS		ANGULAR ±---°		MATERIAL NO. SEE SHEET 2 & 4	DOCUMENT NO. SD-121050-006	SHEET NO. 7 OF 10	
SIZE A3 THIS DRAWING CONTAINS INFORMATION THAT IS PROPRIETARY TO MOLEX INCORPORATED AND SHOULD NOT BE USED WITHOUT WRITTEN PERMISSION							

	10	9	8	7	6	5	4	3	2	1		
TABLE 3 - PART LIST												
	Pos.	MolEx PN:	Engineering No.:	Pos.	MolEx PN:	Engineering No.:	Pos.	MolEx PN:	Engineering No.:	Pos.	MolEx PN:	Engineering No.:
	801	2210508441	E45313N3002117E	841	2210508481	E45313N5002100S	881	2210508521	E453N2N10K2117K	921	2210508561	E453N2N3002117S
	802	2210508442	E45313N3002117G	842	2210508482	E45313N5002100A	882	2210508522	E453N2N10K2117L	922	2210508562	E453N2N3002117A
	803	2210508443	E45313N3002117H	843	2210508483	E45313N5002100B	883	2210508523	E453N2N10K2117M	923	2210508563	E453N2N3002117B
	804	2210508444	E45313N3002117K	844	2210508484	E45313N5002100C	884	2210508524	E453N2N15011000	924	2210508564	E453N2N3002117C
	805	2210508445	E45313N3002117L	845	2210508485	E45313N5002100D	885	2210508525	E453N2N15021171	925	2210508565	E453N2N3002117D
	806	2210508446	E45313N3002117M	846	2210508486	E45313N5002100E	886	2210508526	E453N2N15021172	926	2210508566	E453N2N3002117E
	807	2210508447	E45313N30021001	847	2210508487	E45313N5002100G	887	2210508527	E453N2N15021173	927	2210508567	E453N2N3002117G
	808	2210508448	E45313N30021003	848	2210508488	E45313N5002100H	888	2210508528	E453N2N15021174	928	2210508568	E453N2N3002117H
	809	2210508449	E45313N30021004	849	2210508489	E45313N5002100K	889	2210508529	E453N2N15021175	929	2210508569	E453N2N3002117K
	810	2210508450	E45313N30021005	850	2210508490	E45313N5002100L	890	2210508530	E453N2N1502117A	930	2210508570	E453N2N3002117L
	811	2210508451	E45313N3002100A	851	2210508491	E45313N5002100M	891	2210508531	E453N2N1502117B	931	2210508571	E453N2N3002117M
	812	2210508452	E45313N3002100B	852	2210508492	E453N2N10011000	892	2210508532	E453N2N1502117C	932	2210508572	E453N2N50011000
	813	2210508453	E45313N3002100C	853	2210508493	E453N2N10021171	893	2210508533	E453N2N1502117D	933	2210508573	E453N2N50021171
	814	2210508454	E45313N3002100D	854	2210508494	E453N2N10021172	894	2210508534	E453N2N1502117E	934	2210508574	E453N2N50021172
	815	2210508455	E45313N3002100E	855	2210508495	E453N2N10021173	895	2210508535	E453N2N1502117G	935	2210508575	E453N2N50021173
	816	2210508456	E45313N3002100G	856	2210508496	E453N2N10021174	896	2210508536	E453N2N1502117H	936	2210508576	E453N2N50021174
	817	2210508457	E45313N3002100H	857	2210508497	E453N2N10021175	897	2210508537	E453N2N1502117K	937	2210508577	E453N2N50021175
	818	2210508458	E45313N3002100K	858	2210508498	E453N2N1002117A	898	2210508538	E453N2N1502117L	938	2210508578	E453N2N5002117A
	819	2210508459	E45313N3002100L	859	2210508499	E453N2N1002117B	899	2210508539	E453N2N1502117M	939	2210508579	E453N2N5002117B
	820	2210508460	E45313N3002100M	860	2210508500	E453N2N1002117C	900	2210508540	E453N2N20011000	940	2210508580	E453N2N5002117C
	821	2210508461	E45313N50011000	861	2210508501	E453N2N1002117D	901	2210508541	E453N2N20021171	941	2210508581	E453N2N5002117D
	822	2210508462	E45313N50021171	862	2210508502	E453N2N1002117E	902	2210508542	E453N2N20021172	942	2210508582	E453N2N5002117E
	823	2210508463	E45313N50021172	863	2210508503	E453N2N1002117G	903	2210508543	E453N2N20021173	943	2210508583	E453N2N5002117G
	824	2210508464	E45313N50021173	864	2210508504	E453N2N1002117H	904	2210508544	E453N2N20021174	944	2210508584	E453N2N5002117H
	825	2210508465	E45313N50021174	865	2210508505	E453N2N1002117K	905	2210508545	E453N2N20021175	945	2210508585	E453N2N5002117K
	826	2210508466	E45313N50021175	866	2210508506	E453N2N1002117L	906	2210508546	E453N2N2002117A	946	2210508586	E453N2N5002117L
	827	2210508467	E45313N5002117A	867	2210508507	E453N2N1002117M	907	2210508547	E453N2N2002117B	947	2210508587	E453N2N5002117M
	828	2210508468	E45313N5002117B	868	2210508508	E453N2N10K11000	908	2210508548	E453N2N2002117C	948	2210508588	E453N3N10011000
	829	2210508469	E45313N5002117C	869	2210508509	E453N2N10K21171	909	2210508549	E453N2N2002117D	949	2210508589	E453N3N10021171
	830	2210508470	E45313N5002117D	870	2210508510	E453N2N10K21172	910	2210508550	E453N2N2002117E	950	2210508590	E453N3N10021172
	831	2210508471	E45313N5002117E	871	2210508511	E453N2N10K21173	911	2210508551	E453N2N2002117G	951	2210508591	E453N3N10021173
	832	2210508472	E45313N5002117G	872	2210508512	E453N2N10K21174	912	2210508552	E453N2N2002117H	952	2210508592	E453N3N10021174
	833	2210508473	E45313N5002117H	873	2210508513	E453N2N10K21175	913	2210508553	E453N2N2002117K	953	2210508593	E453N3N10021175
	834	2210508474	E45313N5002117K	874	2210508514	E453N2N10K2117A	914	2210508554	E453N2N2002117L	954	2210508594	E453N3N1002117A
	835	2210508475	E45313N5002117L	875	2210508515	E453N2N10K2117B	915	2210508555	E453N2N2002117M	955	2210508595	E453N3N1002117B
	836	2210508476	E45313N5002117M	876	2210508516	E453N2N10K2117C	916	2210508556	E453N2N30011000	956	2210508596	E453N3N1002117C
	837	2210508477	E45313N50021001	877	2210508517	E453N2N10K2117D	917	2210508557	E453N2N30021171	957	2210508597	E453N3N1002117D
	838	2210508478	E45313N50021002	878	2210508518	E453N2N10K2117E	918	2210508558	E453N2N30021172	958	2210508598	E453N3N1002117E
	839	2210508479	E45313N50021003	879	2210508519	E453N2N10K2117G	919	2210508559	E453N2N30021173	959	2210508599	E453N3N1002117G
	840	2210508480	E45313N50021004	880	2210508520	E453N2N10K2117H	920	2210508560	E453N2N30021174	960	2210508600	E453N3N1002117H
	961	2210508601	E453N3N1002117K							970	2210508610	E453N3N1002100B
	962	2210508602	E453N3N1002117L							971	2210508611	E453N3N1002100C
	963	2210508603	E453N3N1002117M							972	2210508612	E453N3N1002100D
	964	2210508604	E453N3N10021001							973	2210508613	E453N3N1002100E
	965	2210508605	E453N3N10021002							974	2210508614	E453N3N1002100G
	966	2210508606	E453N3N10021003							975	2210508615	E453N3N1002100H
	967	2210508607	E453N3N10021004							976	2210508616	E453N3N1002100K
	968	2210508608	E453N3N10021005							977	2210508617	E453N3N1002100L
	969	2210508609	E453N3N1002100A							978	2210508618	E453N3N1002100M
	970	2210508610	E453N3N1002100B							979	2210508619	E453N3N10K11000
	971	2210508611	E453N3N1002100C							980	2210508620	E453N3N10K21171
	972	2210508612	E453N3N1002100D							981	2210508621	E453N3N10K21172
	973	2210508613	E453N3N1002100E							982	2210508622	E453N3N10K21173
	974	2210508614	E453N3N1002100G							983	2210508623	E453N3N10K21174
	975	2210508615	E453N3N1002100H							984	2210508624	E453N3N10K21175
	976	2210508616	E453N3N1002100K							985	2210508625	E453N3N10K2117A
	977	2210508617	E453N3N1002100L							986	2210508626	E453N3N10K2117B
	978	2210508618	E453N3N1002100M							987	2210508627	E453N3N10K2117C
	979	2210508619	E453N3N10K11000							988	2210508628	E453N3N10K2117D
	980	2210508620	E453N3N10K21171							989	2210508629	E453N3N10K2117E
	981	2210508621	E453N3N10K21172							990	2210508630	E453N3N10K2117G
	982	2210508622	E453N3N10K21173							991	2210508631	E453N3N10K2117H
	983	2210508623	E453N3N10K21174							992	2210508632	E453N3N10K2117K
	984	2210508624	E453N3N10K21175							993	2210508633	E453N3N10K2117L
	985	2210508625	E453N3N10K2117A							994	2210508634	E453N3N10K2117M
	986	2210508626	E453N3N10K2117B							995	2210508635	E453N3N10K21001
	987	2210508627	E453N3N10K2117C							996	2210508636	E453N3N10K21002
	988	2210508628	E453N3N10K2117D							997	2210508637	E453N3N10K21003
	989	2210508629	E453N3N10K2117E							998	2210508638	E453N3N10K21004
	990	2210508630	E453N3N10K2117G							999	2210508639	E453N3N10K21005
	991	2210508631	E453N3N10K2117H							1000	2210508640	E453N3N10K2100A

See Sheet 1 EC NO: IPG2015-2150 DRWN: JMARSZALEK 2015/06/22 CHKD: APAMLAKO1 2015/06/22 APPR: MIWASIECZKO 2015/06/24	QUALITY SYMBOLS ▽=0 ◻=0	GENERAL TOLERANCES (UNLESS SPECIFIED)		DIMENSION STYLE MM ONLY	SCALE 1:1	DESIGN UNITS METRIC	FIRST ANGLE PROJECTION
		4 PLACES ± --- ± ---	3 PLACES ± --- ± ---	2 PLACES ± --- ± ---	1 PLACE ± --- ± ---	0 PLACE ± --- ± ---	ANGULAR ± --- °

TABLE 3 - PART LIST

Pos.	Molex PN:	Engineering No.:	Pos.	Molex PN:	Engineering No.:	Pos.	Molex PN:	Engineering No.:	Pos.	Molex PN:	Engineering No.:	Pos.	Molex PN:	Engineering No.:
1001	2210508644	E453N3N10K2100B	1041	2210508681	E453N3N20011000	1081	2210508721	E453N3N3002117D	1121	2210508761	E453N3N50021004	1161	2210508801	E453P2N10K2100L
1002	2210508642	E453N3N10K2100C	1042	2210508682	E453N3N20021171	1082	2210508722	E453N3N3002117E	1122	2210508762	E453N3N50021005	1162	2210508802	E453P2N10K2100M
1003	2210508643	E453N3N10K2100D	1043	2210508683	E453N3N20021172	1083	2210508723	E453N3N3002117G	1123	2210508763	E453N3N5002100A	1163	2210508803	E453P2N15021001
1004	2210508644	E453N3N10K2100E	1044	2210508684	E453N3N20021173	1084	2210508724	E453N3N3002117H	1124	2210508764	E453N3N5002100B	1164	2210508804	E453P2N15021002
1005	2210508645	E453N3N10K2100G	1045	2210508685	E453N3N20021174	1085	2210508725	E453N3N3002117K	1125	2210508765	E453N3N5002100C	1165	2210508805	E453P2N15021003
1006	2210508646	E453N3N10K2100H	1046	2210508686	E453N3N20021175	1086	2210508726	E453N3N3002117L	1126	2210508766	E453N3N5002100D	1166	2210508806	E453P2N15021004
1007	2210508647	E453N3N10K2100K	1047	2210508687	E453N3N2002117A	1087	2210508727	E453N3N3002117M	1127	2210508767	E453N3N5002100E	1167	2210508807	E453P2N15021005
1008	2210508648	E453N3N10K2100L	1048	2210508688	E453N3N2002117B	1088	2210508728	E453N3N30021001	1128	2210508768	E453N3N5002100G	1168	2210508808	E453P2N1502100A
1009	2210508649	E453N3N10K2100M	1049	2210508689	E453N3N2002117C	1089	2210508729	E453N3N30021003	1129	2210508769	E453N3N5002100H	1169	2210508809	E453P2N1502100B
1010	2210508650	E453N3N15011000	1050	2210508690	E453N3N2002117D	1090	2210508730	E453N3N30021004	1130	2210508770	E453N3N5002100K	1170	2210508810	E453P2N1502100C
1011	2210508651	E453N3N15021171	1051	2210508691	E453N3N2002117E	1091	2210508731	E453N3N30021005	1131	2210508771	E453N3N5002100L	1171	2210508811	E453P2N1502100D
1012	2210508652	E453N3N15021172	1052	2210508692	E453N3N2002117G	1092	2210508732	E453N3N3002100A	1132	2210508772	E453N3N5002100M	1172	2210508812	E453P2N1502100E
1013	2210508653	E453N3N15021173	1053	2210508693	E453N3N2002117H	1093	2210508733	E453N3N3002100B	1133	2210508773	E453P2N10021001	1173	2210508813	E453P2N1502100G
1014	2210508654	E453N3N15021174	1054	2210508694	E453N3N2002117K	1094	2210508734	E453N3N3002100C	1134	2210508774	E453P2N10021002	1174	2210508814	E453P2N1502100H
1015	2210508655	E453N3N15021175	1055	2210508695	E453N3N2002117L	1095	2210508735	E453N3N3002100D	1135	2210508775	E453P2N10021003	1175	2210508815	E453P2N1502100K
1016	2210508656	E453N3N1502117A	1056	2210508696	E453N3N2002117M	1096	2210508736	E453N3N3002100E	1136	2210508776	E453P2N10021004	1176	2210508816	E453P2N1502100L
1017	2210508657	E453N3N1502117B	1057	2210508697	E453N3N20021001	1097	2210508737	E453N3N3002100G	1137	2210508777	E453P2N10021005	1177	2210508817	E453P2N1502100M
1018	2210508658	E453N3N1502117C	1058	2210508698	E453N3N20021002	1098	2210508738	E453N3N3002100H	1138	2210508778	E453P2N1002100A	1178	2210508818	E453P2N15021001
1019	2210508659	E453N3N1502117D	1059	2210508699	E453N3N20021003	1099	2210508739	E453N3N3002100K	1139	2210508779	E453P2N1002100B	1179	2210508819	E453P2N15021002
1020	2210508660	E453N3N1502117E	1060	2210508700	E453N3N20021004	1100	2210508740	E453N3N3002100L	1140	2210508780	E453P2N1002100C	1180	2210508820	E453P2N15021003
1021	2210508661	E453N3N1502117G	1061	2210508701	E453N3N20021005	1101	2210508741	E453N3N3002100M	1141	2210508781	E453P2N1002100D	1181	2210508821	E453P2N15021004
1022	2210508662	E453N3N1502117H	1062	2210508702	E453N3N2002100A	1102	2210508742	E453N3N50011000	1142	2210508782	E453P2N1002100E	1182	2210508822	E453P2N15021005
1023	2210508663	E453N3N1502117K	1063	2210508703	E453N3N2002100B	1103	2210508743	E453N3N50021171	1143	2210508783	E453P2N1002100G	1183	2210508823	E453P2N1502100A
1024	2210508664	E453N3N1502117L	1064	2210508704	E453N3N2002100C	1104	2210508744	E453N3N50021172	1144	2210508784	E453P2N1002100H	1184	2210508824	E453P2N1502100B
1025	2210508665	E453N3N1502117M	1065	2210508705	E453N3N2002100D	1105	2210508745	E453N3N50021173	1145	2210508785	E453P2N1002100K	1185	2210508825	E453P2N1502100C
1026	2210508666	E453N3N15021001	1066	2210508706	E453N3N2002100E	1106	2210508746	E453N3N50021174	1146	2210508786	E453P2N1002100L	1186	2210508826	E453P2N1502100D
1027	2210508667	E453N3N15021002	1067	2210508707	E453N3N2002100G	1107	2210508747	E453N3N50021175	1147	2210508787	E453P2N1002100M	1187	2210508827	E453P2N1502100E
1028	2210508668	E453N3N15021003	1068	2210508708	E453N3N2002100H	1108	2210508748	E453N3N5002117A	1148	2210508788	E453P2N10K21001	1188	2210508828	E453P2N1502100G
1029	2210508669	E453N3N15021004	1069	2210508709	E453N3N2002100K	1109	2210508749	E453N3N5002117B	1149	2210508789	E453P2N10K21002	1189	2210508829	E453P2N1502100H
1030	2210508670	E453N3N15021005	1070	2210508710	E453N3N2002100L	1110	2210508750	E453N3N5002117C	1150	2210508790	E453P2N10K21003	1190	2210508830	E453P2N1502100K
1031	2210508671	E453N3N1502100A	1071	2210508711	E453N3N2002100M	1111	2210508751	E453N3N5002117D	1151	2210508791	E453P2N10K21004	1191	2210508831	E453P2N1502100L
1032	2210508672	E453N3N1502100B	1072	2210508712	E453N3N30011000	1112	2210508752	E453N3N5002117E	1152	2210508792	E453P2N10K21005	1192	2210508832	E453P2N1502100M
1033	2210508673	E453N3N1502100C	1073	2210508713	E453N3N30021171	1113	2210508753	E453N3N5002117G	1153	2210508793	E453P2N10K2100A	1193	2210508833	E453P2N15021001
1034	2210508674	E453N3N1502100D	1074	2210508714	E453N3N30021172	1114	2210508754	E453N3N5002117H	1154	2210508794	E453P2N10K2100B	1194	2210508834	E453P2N15021002
1035	2210508675	E453N3N1502100E	1075	2210508715	E453N3N30021173	1115	2210508755	E453N3N5002117K	1155	2210508795	E453P2N10K2100C	1195	2210508835	E453P2N15021003
1036	2210508676	E453N3N1502100G	1076	2210508716	E453N3N30021174	1116	2210508756	E453N3N5002117L	1156	2210508796	E453P2N10K2100D	1196	2210508836	E453P2N15021004
1037	2210508677	E453N3N1502100H	1077	2210508717	E453N3N30021175	1117	2210508757	E453N3N5002117M	1157	2210508797	E453P2N10K2100E	1197	2210508837	E453P2N15021005
1038	2210508678	E453N3N1502100K	1078	2210508718	E453N3N3002117A	1118	2210508758	E453N3N50021001	1158	2210508798	E453P2N10K2100G	1198	2210508838	E453P2N1502100A
1039	2210508679	E453N3N1502100L	1079	2210508719	E453N3N3002117B	1119	2210508759	E453N3N50021002	1159	2210508799	E453P2N10K2100H	1199	2210508839	E453P2N1502100B
1040	2210508680	E453N3N1502100M	1080	2210508720	E453N3N3002117C	1120	2210508760	E453N3N50021003	1160	2210508800	E453P2N10K2100K	1200	2210508840	E453P2N1502100C

See Sheet 1 EC NO: IPG2015-2150 DRWN: JMARSZALEK 2015/06/22 CHKD: APAM LAKO1 2015/06/22 APPR: MIWASIECZKO 2015/06/24	QUALITY SYMBOLS ▽=0 ▽=0	GENERAL TOLERANCES (UNLESS SPECIFIED) <table border="1"> <tr><th>mm</th><th>INCH</th></tr> <tr><td>4 PLACES ± --- ± ---</td><td></td></tr> <tr><td>3 PLACES ± --- ± ---</td><td></td></tr> <tr><td>2 PLACES ± --- ± ---</td><td></td></tr> <tr><td>1 PLACE ± --- ± ---</td><td></td></tr> <tr><td>0 PLACE ± --- ± ---</td><td></td></tr> </table>	mm	INCH	4 PLACES ± --- ± ---		3 PLACES ± --- ± ---		2 PLACES ± --- ± ---		1 PLACE ± --- ± ---		0 PLACE ± --- ± ---		DIMENSION STYLE MM ONLY DRAWN BY: JMARSZALEK DATE: 2012/11/27 CHECKED BY: MSZWAIKOWSKI DATE: 2012/11/27 APPROVED BY: MIWASIECZKO DATE: 2014/01/30	SCALE 1:1 TITLE E453XXXXXXXXXXXX DIN FORM A EN 175301-803 molex	DESIGN UNITS METRIC FIRST ANGLE PROJECTION
	mm	INCH															
	4 PLACES ± --- ± ---																
	3 PLACES ± --- ± ---																
2 PLACES ± --- ± ---																	
1 PLACE ± --- ± ---																	
0 PLACE ± --- ± ---																	
MATERIAL NO. SEE SHEET 2 & 4	DOCUMENT NO. SD-121050-006	SHEET NO. 9 OF 10															
DRAFT WHERE APPLICABLE MUST REMAIN WITHIN DIMENSIONS			THIS DRAWING CONTAINS INFORMATION THAT IS PROPRIETARY TO MOLEX INCORPORATED AND SHOULD NOT BE USED WITHOUT WRITTEN PERMISSION														

TABLE 3 - PART LIST

Pos.	Molex PN:	Engineering No.:	Pos.	Molex PN:	Engineering No.:	Pos.	Molex PN:	Engineering No.:	Pos.	Molex PN:	Engineering No.:	Pos.	Molex PN:	Engineering No.:
1201	2210508841	E453P2N3002100G	1241	2210508881	E453P3N10K21175	1281	2210508921	E453P3N2002117K						
1202	2210508842	E453P2N3002100H	1242	2210508882	E453P3N10K2117A	1282	2210508922	E453P3N2002117L						
1203	2210508843	E453P2N3002100K	1243	2210508883	E453P3N10K2117B	1283	2210508923	E453P3N2002117M						
1204	2210508844	E453P2N3002100L	1244	2210508884	E453P3N10K2117C	1284	2210508924	E453P3N30011000						
1205	2210508845	E453P2N3002100M	1245	2210508885	E453P3N10K2117D	1285	2210508925	E453P3N30021171						
1206	2210508846	E453P2N50021001	1246	2210508886	E453P3N10K2117E	1286	2210508926	E453P3N30021172						
1207	2210508847	E453P2N50021003	1247	2210508887	E453P3N10K2117G	1287	2210508927	E453P3N30021173						
1208	2210508848	E453P2N50021004	1248	2210508888	E453P3N10K2117H	1288	2210508928	E453P3N30021174						
1209	2210508849	E453P2N50021005	1249	2210508889	E453P3N10K2117K	1289	2210508929	E453P3N30021175						
1210	2210508850	E453P2N5002100A	1250	2210508890	E453P3N10K2117L	1290	2210508930	E453P3N3002117A						
1211	2210508851	E453P2N5002100B	1251	2210508891	E453P3N10K2117M	1291	2210508931	E453P3N3002117B						
1212	2210508852	E453P2N5002100C	1252	2210508892	E453P3N15011000	1292	2210508932	E453P3N3002117C						
1213	2210508853	E453P2N5002100D	1253	2210508893	E453P3N15021171	1293	2210508933	E453P3N3002117D						
1214	2210508854	E453P2N5002100E	1254	2210508894	E453P3N15021172	1294	2210508934	E453P3N3002117E						
1215	2210508855	E453P2N5002100G	1255	2210508895	E453P3N15021173	1295	2210508935	E453P3N3002117G						
1216	2210508856	E453P2N5002100H	1256	2210508896	E453P3N15021174	1296	2210508936	E453P3N3002117H						
1217	2210508857	E453P2N5002100K	1257	2210508897	E453P3N15021175	1297	2210508937	E453P3N3002117K						
1218	2210508858	E453P2N5002100L	1258	2210508898	E453P3N1502117A	1298	2210508938	E453P3N3002117L						
1219	2210508859	E453P2N5002100M	1259	2210508899	E453P3N1502117B	1299	2210508939	E453P3N3002117M						
1220	2210508860	E453P3N10011000	1260	2210508900	E453P3N1502117C	1300	2210508940	E453P3N50011000						
1221	2210508861	E453P3N10021171	1261	2210508901	E453P3N1502117D	1301	2210508941	E453P3N50021171						
1222	2210508862	E453P3N10021172	1262	2210508902	E453P3N1502117E	1302	2210508942	E453P3N50021172						
1223	2210508863	E453P3N10021173	1263	2210508903	E453P3N1502117G	1303	2210508943	E453P3N50021173						
1224	2210508864	E453P3N10021174	1264	2210508904	E453P3N1502117H	1304	2210508944	E453P3N50021174						
1225	2210508865	E453P3N10021175	1265	2210508905	E453P3N1502117K	1305	2210508945	E453P3N50021175						
1226	2210508866	E453P3N1002117A	1266	2210508906	E453P3N1502117L	1306	2210508946	E453P3N5002117A						
1227	2210508867	E453P3N1002117B	1267	2210508907	E453P3N1502117M	1307	2210508947	E453P3N5002117B						
1228	2210508868	E453P3N1002117C	1268	2210508908	E453P3N20011000	1308	2210508948	E453P3N5002117C						
1229	2210508869	E453P3N1002117D	1269	2210508909	E453P3N20021171	1309	2210508949	E453P3N5002117D						
1230	2210508870	E453P3N1002117E	1270	2210508910	E453P3N20021172	1310	2210508950	E453P3N5002117E						
1231	2210508871	E453P3N1002117G	1271	2210508911	E453P3N20021173	1311	2210508951	E453P3N5002117G						
1232	2210508872	E453P3N1002117H	1272	2210508912	E453P3N20021174	1312	2210508952	E453P3N5002117H						
1233	2210508873	E453P3N1002117K	1273	2210508913	E453P3N20021175	1313	2210508953	E453P3N5002117K						
1234	2210508874	E453P3N1002117L	1274	2210508914	E453P3N2002117A	1314	2210508954	E453P3N5002117L						
1235	2210508875	E453P3N1002117M	1275	2210508915	E453P3N2002117B	1315	2210508955	E453P3N5002117M						
1236	2210508876	E453P3N10K11000	1276	2210508916	E453P3N2002117C	1316	1210500877	E453P2G50062002						
1237	2210508877	E453P3N10K21171	1277	2210508917	E453P3N2002117D	1317	1210503525	E453P2N15K61012						
1238	2210508878	E453P3N10K21172	1278	2210508918	E453P3N2002117E	1318	1210503585	E453B3A3002P002						
1239	2210508879	E453P3N10K21173	1279	2210508919	E453P3N2002117G									
1240	2210508880	E453P3N10K21174	1280	2210508920	E453P3N2002117H									

ADD NEW PN'S EC NO: IPG2015-2150 DRWN: JMARSZALEK 2015/06/22 CHKD: APAMIAK01 2015/06/22 APPR: MIWASIECZKO 2015/06/24	QUALITY SYMBOLS ▽ = 0 ◻ = 0	GENERAL TOLERANCES (UNLESS SPECIFIED) mm INCH 4 PLACES ± --- ± --- 3 PLACES ± --- ± --- 2 PLACES ± --- ± --- 1 PLACE ± --- ± --- 0 PLACE ± --- ± ---	DIMENSION STYLE MM ONLY DRAWN BY: JMARSZALEK DATE: 2012/11/27 CHECKED BY: MSZWAJKOWSKI DATE: 2012/11/27 APPROVED BY: MIWASIECZKO DATE: 2014/01/30	SCALE 1:1 DESIGN UNITS METRIC FIRST ANGLE PROJECTION	TITLE E453XXXXXXXXXXXX DIN FORM A EN 175301-803 molex	
	MATERIAL NO. DRAFT WHERE APPLICABLE MUST REMAIN WITHIN DIMENSIONS	DOCUMENT NO. SD-121050-006	SHEET NO. 10 OF 10			
	ANGULAR ±---°			SEE SHEET 2 & 4		
	THIS DRAWING CONTAINS INFORMATION THAT IS PROPRIETARY TO MOLEX INCORPORATED AND SHOULD NOT BE USED WITHOUT WRITTEN PERMISSION					