

# HEAVY DUTY GOOSENECK FLEX ARM

95012 16" Long, 3/8-16 Female, C-Clamp Base

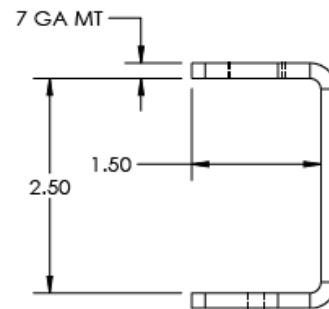

ARM LENGTH	16" (406.4mm)
ARM MATERIAL	Steel
OUTSIDE DIAMETER	.695"
INSIDE DIAMETER	.325"
LOAD RATING	Max Load @ 90 Degrees: <b><u>2.5 pounds</u></b>
FEEL	Heavy Duty, Feels Stiff
MOUNTING STYLE	C-Clamp, 2.5" L x 2.0" W x 1.5" H Threaded in place with Loctite
TOP FITTING	3/8-16 UNC Female Thread
BASE FITTING	Black e-coated 3/8 NPSM x .375" long Hex Fer- rule
COVERING SLEEVE	PVC, Matte Black



800-346-0761

222 Cessna Street  
Watertown, SD 57201

sales@moffattproducts.com

