

**PART SHOWN : 0988611209**

<b>PART NUMBER</b>	<b>ØA ±0.1</b>
0988611209	6.35
0988611219	8.6

**SECTIONS**

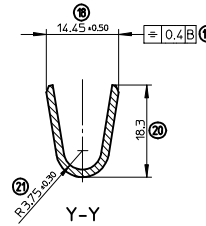
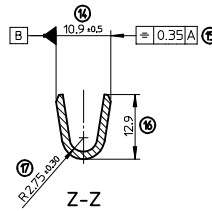

**PACKAGING**

SEE NOTE 4

ATTACHED LINE DIMENSION

**MARKING :**

1 - ENGINEERING CONTROL ID

**NOTES :**

- 1 - MATERIAL : BRASS
- 2 - PLATING : POST-TIN PLATED
- 3 - CRIMPING RANGE (mm2) : 12 TO 27
- 4 - PACKAGING : PARTS DELIVERED ON LOOSE (800 PER CARDBOARD BOX)

**INSPECTION BALLOON NUMBER LOG**

PER DRAWING REVISION : A  
 LAST BALLOON NUMBER USED : 21  
 ADDED BALLOON NUMBERS : NONE  
 REMOVED BALLOON NUMBERS : NONE

<b>FIRST RELEASE</b> EC NO: G2013-0309 DRAWN BY: PBOSSQUAIN CHKD: JDUCLLOS APPROVED: OPLESSIS DATE: 2013/10/10 DATE: 2017/09/05 DATE: 2017/09/28	<b>QUALITY SYMBOLS</b> ▽=0 ▽=0 ▽=0	<b>GENERAL TOLERANCES (UNLESS SPECIFIED)</b>		<b>DIMENSION STYLE</b> <b>MM ONLY</b>		SCALE <b>2:1</b>	DESIGN UNITS <b>METRIC</b>	<input checked="" type="checkbox"/> FIRST ANGLE PROJECTION	
		4 PLACES ±--- ±---	mm	INCH	DRAWN BY	DATE	TITLE	<b>RING TERMINAL</b> <b>6-8X17X1.5 12-27</b>  <b>molex</b> DOCUMENT NO. SD-98861-003 SHEET NO. 1 OF 1	
		3 PLACES ±--- ±---			PBOSSQUAIN	2013/10/10			
		2 PLACES ±--- ±---			JDUCLLOS	2017/09/05			
1 PLACE ±0.3 ±---			APPROVED BY	DATE					
0 PLACE ±--- ±---			OPLESSIS	2017/09/28					
		ANGULAR ±---°		<b>SEE CHART</b>					
		DRAFT WHERE APPLICABLE MUST REMAIN WITHIN DIMENSIONS		MATERIAL NO.					