

3 INCHES LENGTH

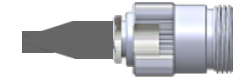

Connector A  
132114RP  
SMA Plug Straight  
Brass Gold + Heatshrink

50 Ohm RG-174  
Continuity/Hi-Pot

Connector B  
172204  
N-Type Jack Straight  
Brass White Bronze + Heatshrink

**Assembly & Label Notes**

Assembly label to be placed ~ 2" from end of connector A and/ or heat shrink  
Assembly shall be built with SN96.5 LEAD FREE solder.  
See Routing Notes for additional assembly & testing instructions.

Connector A		Cable		Connector B	
<b>Part #:</b>	132114RP	<b>Part #:</b>	RG-174	<b>Part #:</b>	172204
<b>Description:</b>	SMA PLUG RP RG316 500	<b>Description:</b>	RG-174 - PE 0.1	<b>Description:</b>	N-Type JK RG174 RG316 LMR100 500
<b>Type:</b>	SMA	<b>Dielectric:</b>	PE	<b>Type:</b>	N-Type
<b>Gender:</b>	Plug	<b>Shielding:</b>	Braid	<b>Gender:</b>	Jack
<b>Body Type:</b>	Straight	<b>Diameter:</b>	0.1	<b>Body Type:</b>	Straight
<b>Contact Type:</b>	Crimp	<b>Impedance:</b>	50 Ohm	<b>Contact Type:</b>	Solder
<b>Polarity:</b>	Reverse	<b>Sheathing:</b>	None	<b>Polarity:</b>	Standard
<b>Impedance:</b>	50 Ohm	<b>Testing:</b>	Continuity Hi-Pot	<b>Impedance:</b>	50 Ohm
<b>Mounting:</b>	Cable	<b>Length:</b>	3 Inches	<b>Mounting:</b>	Cable
<b>Body Material:</b>	Brass			<b>Body Material:</b>	Brass
<b>Body Finish:</b>	Gold			<b>Body Finish:</b>	White Bronze
<b>IP Rating:</b>	None			<b>IP Rating:</b>	None
<b>Contact Material:</b>	Beryllium Copper			<b>Contact Material:</b>	Phosphor Bronze
<b>Contact Finish:</b>	Gold			<b>Contact Finish:</b>	Gold
<b>Max. Freq.:</b>	12.4 GHz			<b>Max. Freq.:</b>	11 GHz
<b>Booting:</b>	SMA Plug Straight RP			<b>Booting:</b>	N-Type Jack Straight
				<b>Clocking:</b>	0°



**CONTROLLED DOCUMENT - DO NOT COPY**

THIS DRAWING MAY CONTAIN PATENTED OR PROPRIETARY INFORMATION AND MUST NOT BE USED FOR ANY PURPOSE DETRIMENTAL TO CUSTOM CABLE INC. IT MAY NOT BE REPRODUCED OR TRANSCRIBED IN ANY FORM WITHOUT THE WRITTEN CONSENT OF CUSTOM CABLE INC. ACCEPTANCE OF THIS DRAWING ESTABLISHES AND AGREEMENT OF THE FOREGOING.

Title:  
**SMA-ST-PL-RP/N-ST-JK G174 3I**

Part No:  
**Q-680200003003I**

**UNLESS SPECIFIED**  
TOLERANCE:  
0-18 inches +/- 1/2"  
over 18" +/- 2%  
ASSEMBLY:  
CENTER LABEL IF LENGTH  
IS LESS THAN 12 INCHES