

PLEASE CHECK WWW.MOLEX.COM FOR LATEST PART INFORMATION

Part Number: **0190690240**
Status: **Active**
Overview: Solderless Terminals
Description: Krimptite Ring Tongue Terminal for 10-12 AWG Wire, Stud Size 1/4" (M6), Length 26.82mm, Mylar Tape Carrier

Documents:

3D Model	Product Specification PS-19902-011-001 (PDF)
Drawing (PDF)	Product Specification PS-19902-015-001 (PDF)
3D Model (PDF)	RoHS Certificate of Compliance (PDF)

Agency Certification

CSA	LR18689
UL	E32244

General

Product Family	Ring and Spade Terminals
Series	<u>19069</u>
Crimp Quality Equipment	Yes
Overview	<u>Solderless Terminals</u>
Product Name	Krimptite
Taxonomy	Ring and Spade Terminals
Type	Ring
UPC	800753068230

Physical

Barrel Type	Closed
Insulation	None
Material - Plating Mating	Tin
Material - Plating Termination	Tin
Net Weight	2.353/g
Packaging Type	Adhesive Tape on Reel
Plating min - Mating	2.540µm
Plating min - Termination	2.540µm
Stud Size	1/4" (M6)
Termination Interface: Style	Crimp or Compression
Wire Size AWG	10, 12
Wire Size mm ²	4.00-6.00

Solder Process Data

Lead-free Process Capability	N/A
------------------------------	-----

Material Info

Engineering Number	C-140-14T
--------------------	-----------

Reference - Drawing Numbers

Product Specification	PS-19902-011-001, PS-19902-015-001
Sales Drawing	190690192-000

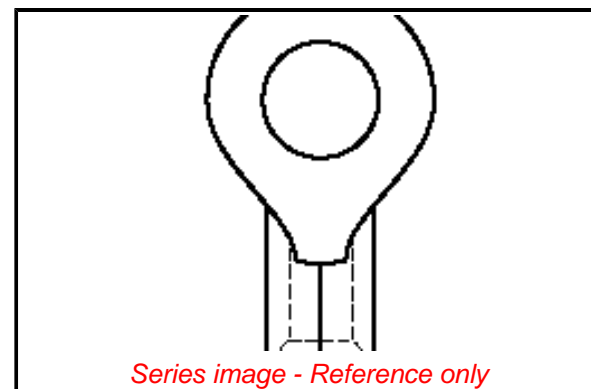

EU ELV

Not Relevant

EU RoHS

Compliant

REACH SVHC

Not Contained Per -
D(2022)4187-DC (10
June 2022)

Halogen-Free

Status

Low-Halogen

For more information, please visit [Contact US](#)

China ROHS

ELV

RoHS Phthalates

Green Image

Not Relevant

Not Contained

Search Parts in this Series

19069 Series

Application Tooling | FAQ

Tooling specifications and manuals are found by selecting the products below. Crimp Height Specifications are then contained in the Application Tooling Specification document.

Global

Description	Product #
Perishable Tooling Spacers for tape product	<u>190270133</u>
ATP Perishable Tool Kit used in ATP Presses that Process Product on Tape	<u>190270300</u>