

D-Sub Full Metal, Black, Side cable entry

**TECHNICAL SPECIFICATIONS**

Material: Zinc, Black Plated  
 Operating Temperature: -40°C to +120°C  
 Cable Entry: Side Entry  
 Thumbscrews: UNC 4-40 (Standard)  
 M2,5 or M3 on request  
 Cable O.D: Up to 11,5mm

**Features:**

- Available in sizes 9-15-25-37
- Size 50 on request
- Excellent EMI Shielding
- Re-openable
- Strain relief inserts ensure a secure termination
- Black Full Metal Jackscrew as standard

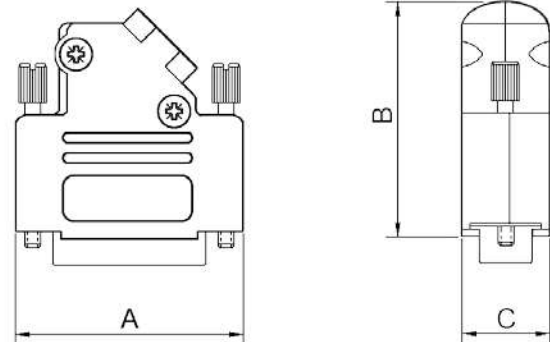

**Grommet Sizes:**

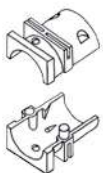

Size 9-15-25-37

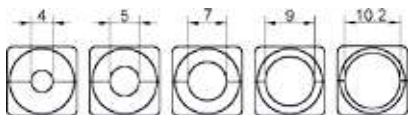

Size D45ZK	Dim A	Dim B	Dim C
9-way	31,0	39,5	15,0
15-way	39,5	41,5	15,0
25-way	53,5	48,5	15,0
37-way	71,0	53,0	15,0

**Ordering information:**

Size:	P/N - Kitted:	Product Code:
9-way	6560-0116-11	D45ZK09-BK-K
15-way	6560-0116-12	D45ZK15-BK-K
25-way	6560-0116-13	D45ZK25-BK-K
37-way	6560-0116-14	D45ZK37-BK-K



**Encitech Connectors AB**  
 Rörkullsvägen 4  
 SE-302 41 HALMSTAD, Sweden

Tel: +46-(0)35-15 13 90  
 e-mail: connectors@encitech.com

**www.encitech.com**