

# PRODUCT SPECIFICATION DRAWING

P2RFD-1660-SS

**FINISH:**  
BODIES &  
COMPONENTS:

WHITE BRONZE

HEX NUT:

PASSIVATED PER QQ-P-35C, TYPE II

PIN & CONTACTS:

SILVER

**PERFORMANCE:**

IMPEDANCE:

50 OHMS

VP:

77%

FREQ. RANGE:

DC TO 7.5 GHz

DELAY:

200 ps OVER 7.5 GHz SPAN

VSWR:

<1.1:1 TO 7.5 GHz

INSERTION LOSS:

<-.1 dB TO 7.5 GHz

3rd ORDER IMP:

<-160 dBc IN PCS BAND w/2+43 dB TONES

**MATERIAL:**

BODIES &  
COMPONENTS: BRASS

HEX NUT:

STAINLESS STEEL PER AMS-5640, TYPE 303,  
COND. A

PIN:

BRASS

CONTACT &  
GROUND RING:

BERYLLIUM COPPER

ORING:

SILICONE RUBBER, ZZ-R-765 DUROMETER 70

INSULATOR:

PTFE PER ASTM-D1710

**MECHANICAL (TYP)**

MATING:

M29 X 1.5mm THREAD

INTERFACE:

CECC 22 190

MATING CYCLES:

500 min

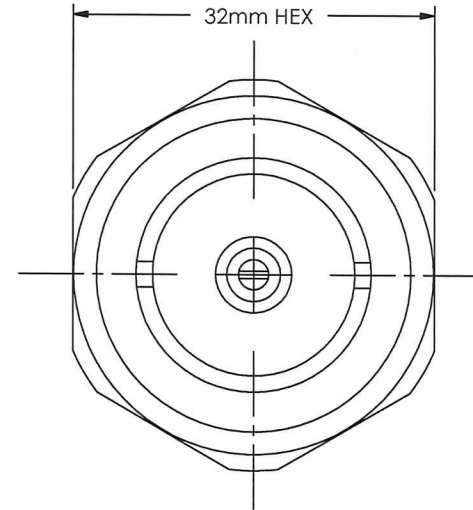
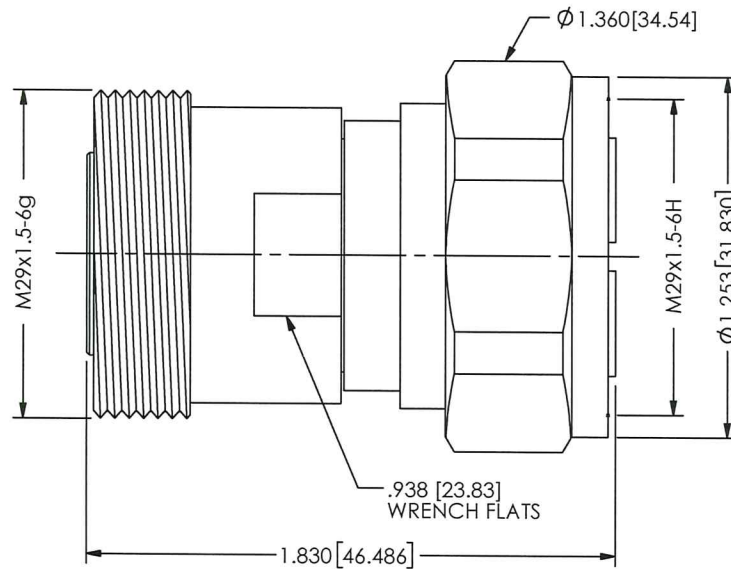

UNLESS OTHERWISE SPECIFIED  
DIMENSIONS ARE IN INCHES  
& [MILLIMETERS]

**PROPRIETARY**

THE INFORMATION HEREIN IS CONFIDENTIAL AND  
PROPRIETARY. NO DISCLOSURE, REPRODUCTION,  
OR FURTHER DISSEMINATION MAY BE MADE  
WITH OUT THE EXPRESSED WRITTEN  
CONSENT OF RF INDUSTRIES.

**RFP<sup>2</sup> RF PRECISION PRODUCTS**  
A DIVISION OF RF INDUSTRIES

7610 MIRAMAR ROAD, SAN DIEGO, CA 92126-4202  
(858) 549-6340 - FAX (858) 549-6345 - RFP2@RFINDUSTRIES.COM

TITLE: 7/16 DIN JACK TO  
7/16 DIN PLUG ADAPTER

REV	DESCRIPTION	DATE	APPROVED
-	ENGINEERING RELEASE	04/05/12	JDMc
A	UPDATED DWG. FORMAT AND SPECS	05/15/15	JDMc
B	UPDATED SPECS	10/21/21	JDMc

**RoHS  
COMPLIANT**

DRAWN BY:	C. ZUNIGA	10/21/21
ENG APPROVAL:	<i>[Signature]</i>	
ORJ. DRAWN:	C. ZUNIGA	04/05/12

SCALE:	CODE:	DWG. NO.	REV
NTS	000000	P2RFD-1660-SS	B
SHEET 1 OF 1			