

Pushbutton Switches, Splashproof Boot Seals

A wide selection of stock boot seals for pushbuttons are available in a variety of styles and thread sizes. ALCOSWITCH seals replace standard mounting hardware to provide environmental seal. Fabricated of Neoprene in black and optional red or gray. Custom colors and thread sizes are also available on special order.



BP10480

10-48 PUSHBUTTON BOOT SEALS

Splashproof seal designed for "TINY" pushbutton switches having a 10-48 bushing and .14" long button actuators. The hex nut is molded-in to the Neoprene seal. No O-Ring is required. Custom colors are available on special order.

| Model | Mount Color | Boot Color | Thread Size | Use with Switch Types |
|---------|-------------|------------|-------------|---------------------------|
| BP10480 | Black | Black | 10-48 | Recommended for TP Series |
| BP10482 | Red | Red | 10-48 | Recommended for TP Series |
| BP10488 | Gray | Gray | 10-48 | Recommended for TP Series |

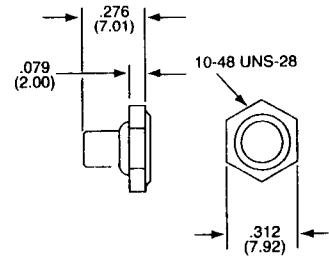

BPA14400



BP14400

1/4-40 PUSHBUTTON BOOT SEALS

Splashproof seals for miniature pushbuttons having a 1/4-40 bushing. The two models allow use with buttons that extend up to .17" (BPA) or up to .33" (BP). The hex nut is molded-in and no O-Ring is required.

| Model | Mount Color | Boot Color | Thread Size | Use with Switch Types |
|----------|-------------|------------|-------------|---------------------------------------|
| BP14400 | Black | Black | 1/4-40 | MSPM, MPA3, MPS and TP Series |
| BP14402 | Red | Red | 1/4-40 | MSPM, MPA3, MPS and TP Series |
| BP14408 | Gray | Gray | 1/4-40 | MSPM, MPA3, MPS and TP Series |
| BPA14400 | Black | Black | 1/4-40 | MSPMBS, MSPMCS, MSP3, MPA3, TP Series |
| BPA14402 | Red | Red | 1/4-40 | MSPMBS, MSPMCS, MSP3, MPA3, TP Series |
| BPA14408 | Gray | Gray | 1/4-40 | MSPMBS, MSPMCS, MSP3, MPA3, TP Series |

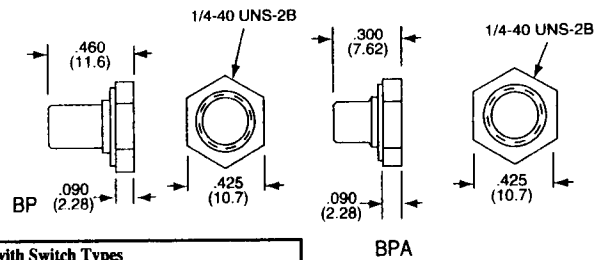

BP20100



BP1900

1/4-40 PUSHBUTTON BOOT SEALS

Splashproof seals having 1/4-40 blind nuts integrally mounted to the black Neoprene seal. Supplied with a captive O-Ring to complete the panel seal. Used with actuators up to .37" long. Choice of two-tone having knurled ring with nickel finish or all black appearance.

| Model | Mount Color | Boot Color | Thread Size | Use with Switch Types |
|--------|-------------|------------|-------------|--------------------------------|
| BP1900 | Nickel | Black | 1/4-40 | MSPM, MSP3, MPA3 and TP Series |
| BP2010 | Black | Black | 1/4-40 | MSPM, MSP3, MPA3 and TP Series |

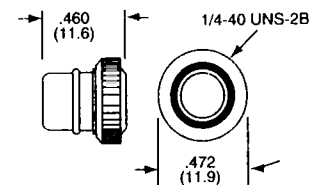

BP15320

15/32-32 PUSHBUTTON BOOT SEALS

Splashproof seals incorporating a molded-in hex nut for washer tight and dust tight protection. Replaces standard hardware usually supplied. Recommended for large size pushbutton switches with actuators extending up to .31" long.

| Model | Mount Color | Boot Color | Thread Size | Use with Switch Types |
|---------|-------------|------------|-------------|-----------------------|
| BP15320 | Black | Black | 15/32-32 | MSPF and MPG Series |
| BP15322 | Red | Red | 15/32-32 | MSPF and MPG Series |
| BP15328 | Gray | Gray | 15/32-32 | MSPF and MPG Series |

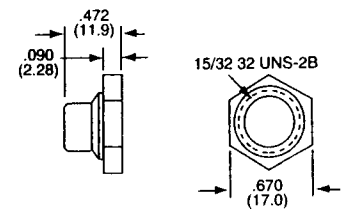

BP5900



BP5890

15/32-32 PUSHBUTTON BOOT SEALS

Splashproof seals having 15/32-32 hex shape mounts integrally bonded onto the black Neoprene seal. Supplied with a captive O-Ring for use against the panel. Readily accepts actuators up to .38" in length. Available in two tone with nickel finish hex-mount, or all black appearance.

| Model | Mount Color | Boot Color | Thread Size | Use with Switch Types |
|--------|-------------|------------|-------------|-----------------------|
| BP5890 | Nickel | Black | 15/32-32 | MSPF and MPG Series |
| BP5900 | Black | Black | 15/32-32 | MSPF and MPG Series |

