

Core **Toroid 16/9.6/6.3**

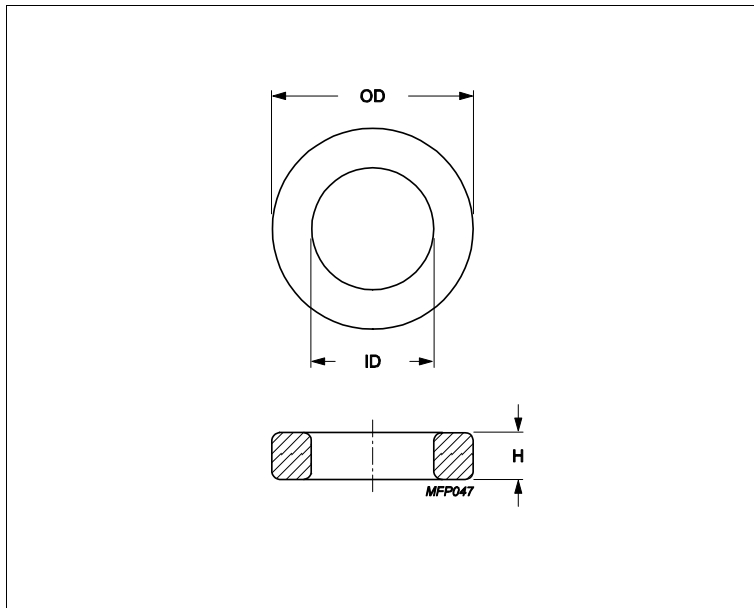

Effective parameters			
	Parameter	Value	Unit
$\Sigma(I/A)$	core factor (C1)	1.95	mm ⁻¹
Ve	effective volume	760	mm ³
Le	effective length	38.5	mm
Ae	effective area	19.7	mm ²
m	mass of core	≈ 3.8	g/pcs

Epoxy coating DC isolation voltage 1500.

Maximum operating temperature of the coating is 200°C.

Dimensions (mm)

Cores	OD	ID	H	
TX16/9.6/6.3	16.75 max	8.95 min	6.95 max	Epoxy Coated

Core data

Cores	Material	AI (nH/turns ²)	AI tolerance	$\mu\epsilon$
TX16/9.6/6.3	3C94	1480	± 25%	≈ 2300
TX16/9.6/6.3	3E10	6440	± 20%	≈ 10000
TX16/9.6/6.3	3E12	7730	± 30%	≈ 12000
TX16/9.6/6.3	3E27	3540	± 25%	≈ 5500
TX16/9.6/6.3	3E6 (3E10-M)	6440	± 30%	≈ 10000
TX16/9.6/6.3	3E65	3350	± 25%	≈ 5200