

TL6330 SERIES TACT SWITCH

APPLICATIONS / MARKETS

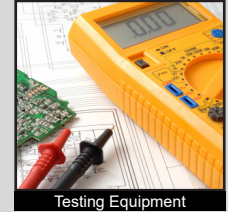

RoHS

SPECIFICATIONS

Contact Rating: 50mA @ 32VDC
Electrical Life: 200gf - 200,000 Cycles
 300gf - 150,000 Cycles
 400gf - 100,000 Cycles
Contact Resistance: 100mΩ Max
Insulation Resistance: 1GΩ Min @ 500VDC
Dielectric Strength: 250VAC for 1 Minute
Operating Temperature: -40°C to 85°C
Storage Temperature: -40°C to 85°C
Travel: 0.25mm
Contact Arrangement: SPST
Actuation Force: 200gf, 300gf, 400gf
Dust/Moisture Protection: IP67

FEATURES & BENEFITS

- Surface mount PC board design
- Long Cycle Life up to 200,000 Cycles
- Small package size of 2.80mm x 4.60mm
- Multiple actuator height options: 1.90mm, 2.50mm
- Multiple actuation force options: 200gf, 300gf, 400gf
- IP67 rating

PART NUMBER CONFIGURATOR

Series



TL6330

Actuator Options



A - 1.90mm
 B - 2.50mm

Actuation Force



F200 - 200 gf
 F300 - 300 gf
 F400 - 400 gf

Contact Material



Q - Silver

Specifications subject to change without notice 8.17.2022



E-SWITCH®

www.e-switch.com

800.867.2717

1

TL6330 SERIES TACT SWITCH

BODY DIMENSIONS

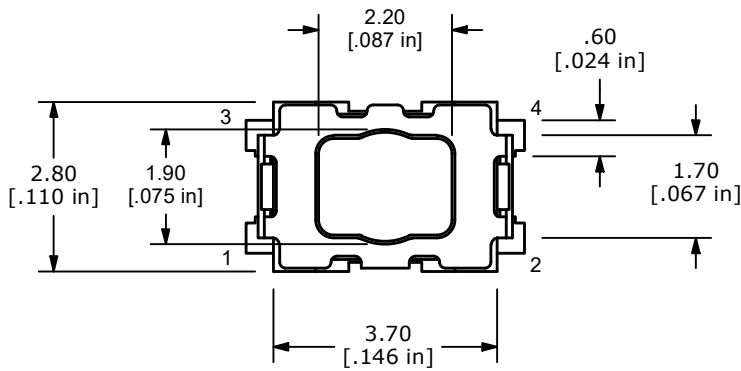
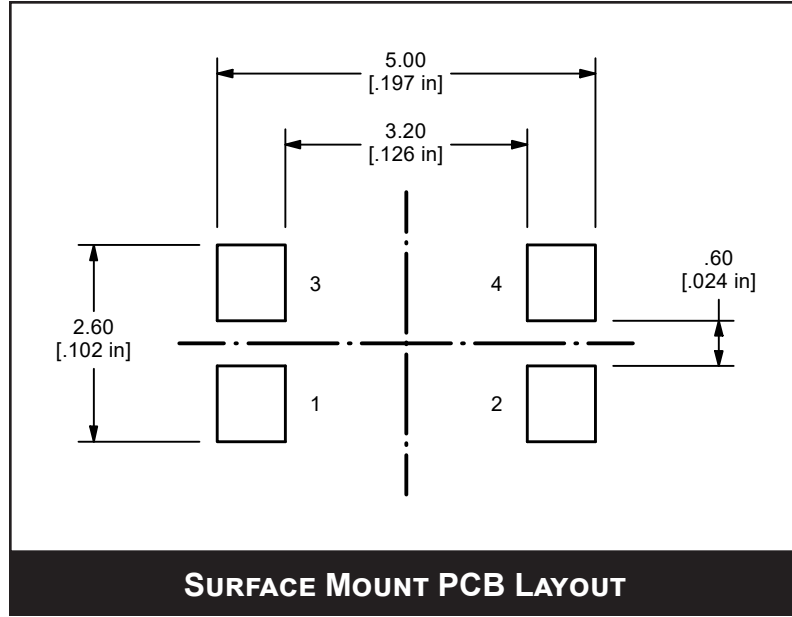
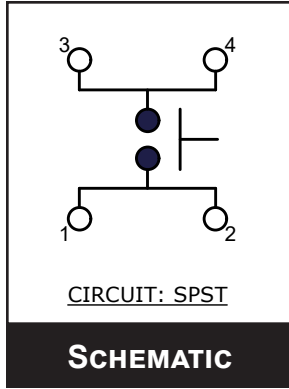

ACTUATOR	"L"
A	1.90
B	2.50

