

S810-PLT-DZB

Zigbee Compatible 12VDC Ceiling Multi-Sensor



Multi-element PIR motion detector

Internal photodiode enables daylight harvesting operation

Temperature sensor endpoint

Full 0–100% dimming with Dim-to-Zero 0–10V LED drivers

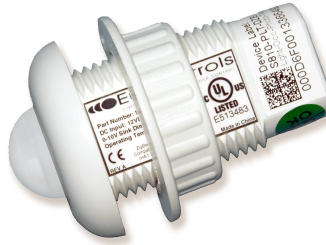

Up to 600 ft² motion coverage at 10 ft mount height

Connect wirelessly via Daintree ControlScope or Zigbee HA 1.2

Modular RJ9 quick-click connector

5 year limited product warranty

PRODUCT OVERVIEW

Introduction

The S810-PLT-DZB is a Zigbee HA 1.2 compatible motion, light, and temperature sensor designed for installation through drop ceiling tiles or inside commercial lighting fixtures such as troffers, suspended linears, and surface mounts. The relay-less low voltage sensor uses PIR (passive infrared) sensing technology to detect motion in its coverage area and automatically dim or turn off lights when persons have left the area, reducing energy usage. A built-in photodiode enables daylight harvesting operation and increases energy savings, while an integrated temperature sensor enables HVAC automation.

Operation

After it is commissioned with a compatible gateway, the sensor can be programmed to apply 100% dimming to Dim-to-Zero compatible 0–10V dimmable lights when motion is detected. When movement is no longer detected and the standby time delay expires, lights can be dimmed according to a set level and can be dimmed to zero/off after a dimming time delay expires. All aspects and sequence of operations are configurable via the gateway.

Commissioning

All setup is performed via supported IEEE 802.15.4-based control platforms such as Daintree ControlScope and other Zigbee HA 1.2 compatible lighting control systems. Appropriate gateway control software allows for adjustment of motion sensitivity, standby/dimming time delays, and dimming level. Further automations are possible when ambient light level and temperature sensor endpoints are utilized.

Applications

This low profile sensor is designed for installation through a standard drop ceiling tile (or inside the bottom of a light fixture body) and is ideal for the following applications:

LOCATIONS

- Offices
- Schools
- Airports
- Hallways
- Retail stores
- Medical facilities

FIXTURES

- Troffers
- Flush panels
- Wraparounds
- Suspended linears
- Surface mounts
- Wall mounts

FEATURES

- Multi-element PIR detector has excellent sensing performance when coupled with internal lens
- Up to 600 ft² coverage area at 10 ft mount height
- Low voltage on/off/dimming control of lighting fixture(s)
- 0–10V dimming control compatible with Dim-to-Zero/Dim-to-Off LED drivers and fluorescent ballasts
- Fully software configurable standby/dimming time delays for a wide range of installations and applications
- Daylight harvesting functionality can observe preset ambient light thresholds and keep lights off
- Temperature sensor enables HVAC applications
- Daintree ControlScope certified and Zigbee HA 1.2 compatible for easy setup and adjustment
- DC relay-less design is more durable and reliable
- UV resistant, flame retardant, impact resistant, and recyclable polycarbonate construction

SPECIFICATIONS

- Input Voltage: 12VDC
- 0–10VDC Dimming Current: 50mA (max sink)
- Photocell Sensitivity: 1–300 fc
- Temperature Sensitivity: –67 to +257 °F (–55 to +125 °C)
- Radio Power: +12dBm transmit; 262 ft (80m) range LOS
- Wireless Certifications: Daintree ControlScope Certified
- Wireless Compatibility: Zigbee Home Automation 1.2
- Operating Temperature: –4 to +140 °F (–20 to +60 °C)
- Operating Humidity: 20–90% non-condensing
- Weatherproof Rating: IP44 for indoor use only
- Safety Certifications: UL/cUL Listed, File E513483
- Regulatory Compliance: CE, RoHS, FCC, CA Title 24

DIMENSIONS

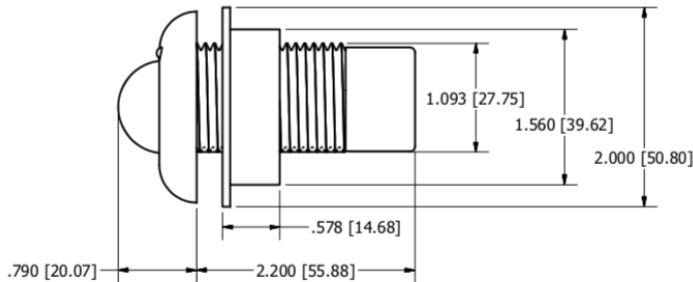

MOUNTING

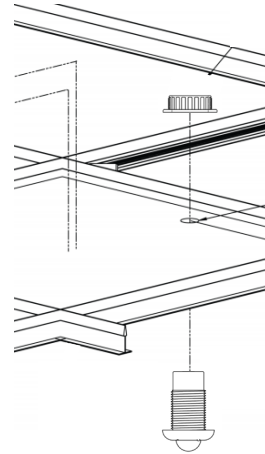

WIRING

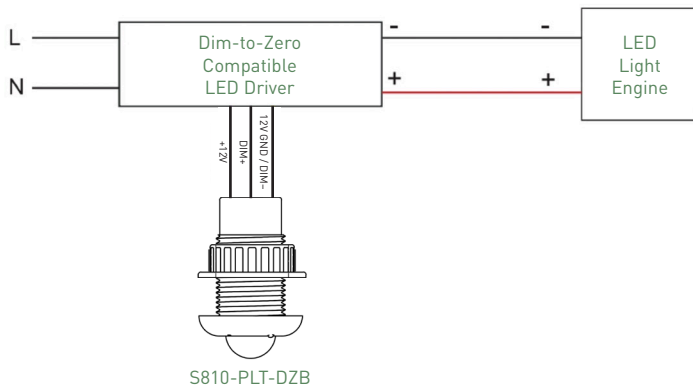

COVERAGE PATTERN

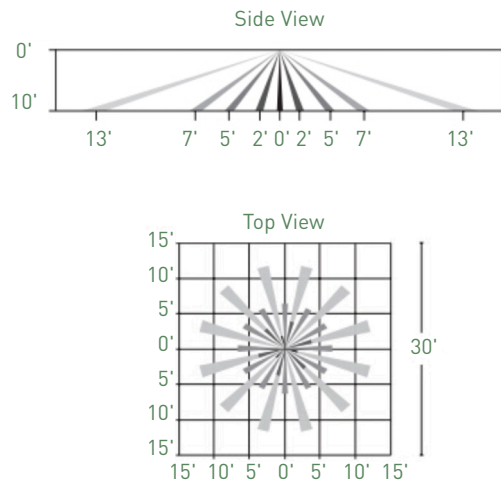

ORDERING INFORMATION

Part Number	Color	Description
S810-PLT-DZB	White	DC ceiling mount motion/light/temp sensor with 0–10V dimming control & Zigbee compatible radio